

REDACTED

LB 00078

United States Environmental Protection Agency  
Region 4



35<sup>TH</sup> AVENUE REMOVAL INVESTIGATION  
BIRMINGHAM, ALABAMA  
JEFF CROWLEY, ON-SCENE COORDINATOR

FIELD SAMPLING LOGBOOK

Book 1 of 1

Inclusive Dates: 05/20/13 - 05/24/13

List of Sampling Team in logbook:

Name	Initials	Organization/Duties
(b) (6)	RS	OTIE, Team Leader
(b) (6)	EM	OTIE

## Sampling Procedures and Methodology

Unless specified elsewhere in this logbook, all soil samples will be collected in accordance with the EPA Science and Ecosystem Division (SESD) Field Branches Quality System and Technical Procedures (FBQSTP) Soil Sampling (SESDPROC-300-R2) based on the following design.

The total number of 5-point composite surface soil samples (0-4 inches below ground surface) to be collected from each property will be based on the lot size as follows:

- For residential properties with a total parcel lot size equal to or less than ( $\leq$ ) 5,000 square feet - the front yard and back yards of each property. If the property has a substantial side yard (primarily corner lots), then one composite soil sample may also be collected from the side yard. Aliquots will be collected away from influences with drip lines and burn areas in a five dice configuration (each of the four corners and the center).
- For residential properties with a total parcel lot size greater than ( $>$ ) 5,000 square feet and  $\leq$  ¼-acre - the property should be divided into two roughly equal surface areas. If the property has a substantial side yard (primarily corner lots), then one composite soil sample may be collected from the side yard with the remainder of the property being divided into two roughly equal surface areas. Aliquots will be collected away from influences including drip lines and burn areas with reasonably equal spacing between aliquots.
- Residential properties over ¼-acre in parcel lot size will be divided into ¼-acre sections. When dividing any such property with a substantial side yard (primarily corner lots), one composite soil sample may be collected from the side yard. Aliquots will be collected away from influences including drip lines and burn areas in a five dice configuration, if possible, with reasonably equal spacing between aliquots.

Grab surface soil samples will be collected from apparent exposure pathways where active play sets are located.

Three-point composite surface soil samples will be collected from distinct vegetable gardens from each residential property.

Samples shall not be collected under paved areas or under stationary fixed structures.

Grab sediment samples will be collected in accordance with EPA SESD FBSTP Sediment Sampling (SESDPROC-200-R2) from any surface water drainage pathways located on individual properties, as directed by the OSC, and in and along the banks of the 34<sup>th</sup> Street North Ditch.

Each surface soil or sediment sample should be homogenized in a stainless steel bowl. One 8-ounce jar will be filled and the remaining sample material will be placed in zip-top bags for screening. Information identifying the location, sample, and date/time will be inscribed on each jar and zip-top bag.

All sample bags will be screened for metals in accordance with SESD FBQSTP Field XRF Measurement (SESDPROC-107-R2) using a Niton XRF. The sample will be dried before sieving or analysis is performed. Once the sample has dried, the sample will be divided into two subsamples; one subsample will be sieved through a #10 screen (2 mm) and the other will be left unsieved. Once separated into sieved and unsieved samples, the zip-top bag will be compressed by folding over the excess plastic and removing as much air and space from the sample as possible. The XRF will be placed directly on the exterior of the compressed sample in the plastic zip-top bag to measure metals concentrations. Following XRF screening, the unsieved portion of the sample material will be containerized into one 8-ounce jars and the sieved portion of the sample will be containerized into another 8-ounce jar.

**This page intentionally left blank**

Based on the site DQOs the 8-ounce jars of surface soil and sediment samples should be submitted to PEL, Tampa, Florida (a NELAC certified laboratory) for low level PAH, and/or TCL SVOC, RCRA metals, PCB, and/or Hexavalent Chromium analysis. RCRA metals will be analyzed from both the sieved and unsieved portions of the sample. All other analysis will be conducted on the unsieved portion.

The location of each aliquot will also be logged in accordance with SESD FBQSTP Global Positioning System (SESDPROC- 110-R3) using a Trimble GPS.

A description of the color and texture of the aliquot material will be recorded in each box.

The **station ID** for each location will consist of seven characters, beginning with the six digit Property ID designation for the property followed by a alphabetic letter beginning with "A".

e.g. CV0001A would be the station ID for the front yard 5-pt composite sample collected at the property with Property ID CV0001.

The **sample ID** for each sample is the station ID with "CS" (composite soil), "GS" (grab soil), "SD" (sediment), or "SW" (surface water) appended, therefore, the sample ID for this sample would be CV0001A-CS. Co-located duplicates will be designated by appending a "D" to the end of the sample ID. Pan splits will be identified by appending an "SP" to the end of the sample ID.

(b) (6)

ADDRESS:

PROPERTY ID: HP0068

DATE: 5/20/13

ARRIVAL TIME: 1255

Other pertinent information (weather conditions, etc.):

~80°F + cloudy

PROPERTY COMMENTS:

House appears vacant + yard is overgrown.

Grid for property sketch

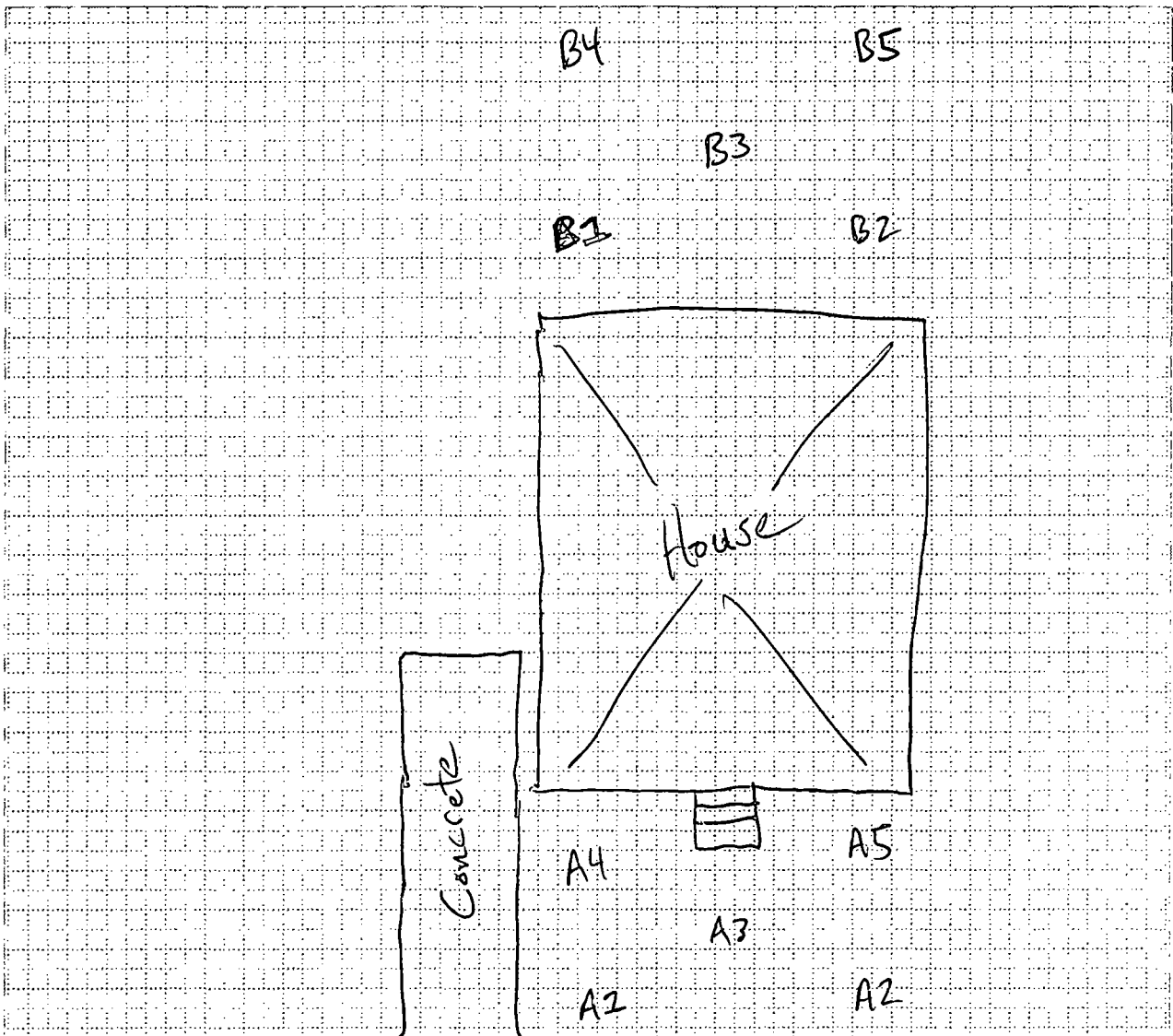

(b) (6)

STATION ID: HP0068A SAMPLE ID: HP0068A-CS

SAMPLE COLLECTION TIME: 1305

Description of sample location (front, back, side yard; vegetable garden; play set; ditch, etc):

FRONT YARD

Collection: Composite or Grab

MS/MSD? Y or N

Field Duplicate or Split: Yes or No If yes, indicate Duplicate split <sup>RS</sup> sample station ID: HP0068A

GPS Coordinates:	Trimble <input checked="" type="checkbox"/>	Instrument #:	<u>020168</u>	Logged?	<input checked="" type="checkbox"/>	or N
Aliquot #1:	Latitude:	<u>33.56397153</u>	N Longitude	<u>86.79102994</u>		W
	Media description:	<u>BROWN SILTY CLAY w/ COAL</u>				
Aliquot #2:	Latitude:	<u>33.56398061</u>	N Longitude	<u>86.79097620</u>		W
	Media description:	<u>DARK BROWN SILTY CLAY w/ COAL</u>				
Aliquot #3:	Latitude:	<u>33.56398933</u>	N Longitude	<u>86.79100926</u>		W
	Media description:	<u>SAME AS #1</u>				
Aliquot #4:	Latitude:	<u>33.56400572</u>	N Longitude	<u>86.79104184</u>		W
	Media description:	<u>SAME AS #1</u>				
Aliquot #5:	Latitude:	<u>33.56400562</u>	N Longitude	<u>86.79098881</u>		W
	Media description:	<u>SAME AS #1</u>				

STATION ID: HP0068B SAMPLE ID: HP0068B-CS

SAMPLE COLLECTION TIME: 1315

Description of sample location (front, back, side yard; vegetable garden; play set; ditch, etc):

Back corner yard

Collection: Composite or Grab

MS/MSD? Y or N

Field Duplicate or Split: Yes or No If yes, indicate Duplicate/split sample station ID: \_\_\_\_\_

GPS Coordinates:	Trimble [ ]	Instrument #:	<u>020168</u>	Logged?	<input checked="" type="checkbox"/>	or N
Aliquot #1:	Latitude:	<u>33.56421139</u>	N Longitude	<u>86.79104706</u>		W
	Media description:	<u>DK silty clay</u>				
Aliquot #2:	Latitude:	<u>33.56421397</u>	N Longitude	<u>86.79098694</u>		W
	Media description:	<u>Same as #1</u>				
Aliquot #3:	Latitude:	<u>33.56423978</u>	N Longitude	<u>86.79102029</u>		W
	Media description:	<u>Same as B1</u>				
Aliquot #4:	Latitude:	<u>33.56428260</u>	N Longitude	<u>86.79104490</u>		W
	Media description:	<u>Same as B1</u>				
Aliquot #5:	Latitude:	<u>33.56428832</u>	N Longitude	<u>86.79098565</u>		W
	Media description:	<u>Same as B1</u>				

(b) (6)

ADDRESS:

PROPERTY ID: CV0626

DATE:

5/20/13

ARRIVAL TIME:

1430

Other pertinent information (weather conditions, etc.):

~85°F + cloudy

PROPERTY COMMENTS:

Vacant lot adjacent to church. This parcel has been used as a staging area for the water department.

Grid for property sketch

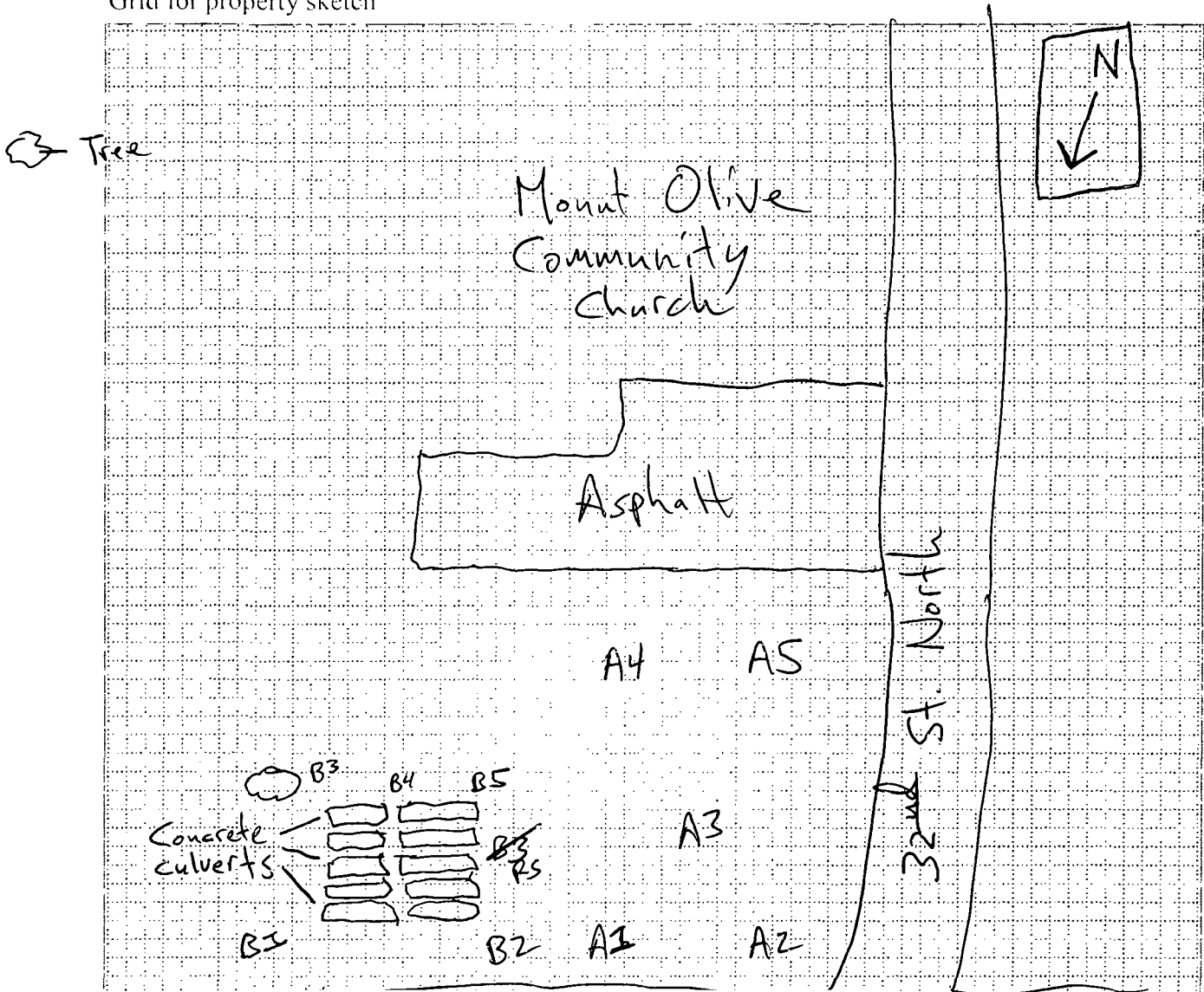

(b) (6)

STATION ID: CV0626A SAMPLE ID: CV0626A-CS

SAMPLE COLLECTION TIME: 1435

Description of sample location (front, back, side yard; vegetable garden; play set; ditch, etc):

West half of lot

Collection: Composite or Grab

MS/MSD? Y or N

Field Duplicate or Split: Yes or No If yes, indicate Duplicate/split sample station ID: \_\_\_\_\_

GPS Coordinates: Trimble <input checked="" type="checkbox"/>	Instrument #: <u>020168</u>	Logged? <input checked="" type="checkbox"/>	or N
Aliquot #1: Latitude: <u>33.55741945</u>	N Longitude: <u>86.80293502</u>		W
Media description: <u>Dk brn silty clay</u>			
Aliquot #2: Latitude: <u>33.55740771</u>	N Longitude: <u>86.80296350</u>		W
Media description: <u>Same as A1</u>			
Aliquot #3: Latitude: <u>33.55736698</u>	N Longitude: <u>86.80290793</u>		W
Media description: <u>Same as A1</u>			
Aliquot #4: Latitude: <u>33.55734188</u>	N Longitude: <u>86.80285086</u>		W
Media description: <u>Same as A1</u>			
Aliquot #5: Latitude: <u>33.55731148</u>	N Longitude: <u>86.80290403</u>		W
Media description: <u>Same as A1</u>			

STATION ID: CV0626B SAMPLE ID: CV0626B-CS

SAMPLE COLLECTION TIME: 1445

Description of sample location (front, back, side yard; vegetable garden; play set; ditch, etc):

East half of lot

Collection: Composite or Grab

MS/MSD? Y or N

Field Duplicate or Split: Yes or No If yes, indicate Duplicate/split sample station ID: \_\_\_\_\_

GPS Coordinates: Trimble <input checked="" type="checkbox"/>	Instrument #: <u>020168</u>	Logged? <input checked="" type="checkbox"/>	or N
Aliquot #1: Latitude: <u>33.55752977</u>	N Longitude: <u>86.80280590</u>		W
Media description: <u>Dk brn silty clay</u>			
Aliquot #2: Latitude: <u>33.55747715</u>	N Longitude: <u>86.80284023</u>		W
Media description: <u>Same as B1</u>			
Aliquot #3: Latitude: <u>33.55749600</u>	N Longitude: <u>86.80271991</u>		W
Media description: <u>Same as B1</u>			
Aliquot #4: Latitude: <u>33.55745676</u>	N Longitude: <u>86.80277632</u>		W
Media description: <u>Same as B1</u>			
Aliquot #5: Latitude: <u>33.55743499</u>	N Longitude: <u>86.80280740</u>		W
Media description: <u>Same as B1</u>			



(b) (6)

ADDRESS: No address for lot PROPERTY ID: CV0003

DATE: 5/20/13 ARRIVAL TIME: 1505

Other pertinent information (weather conditions, etc.):

~86°F + cloudy

PROPERTY COMMENTS:

Empty parcel off the caddlesac. Triangle shaped lot. Less than 5,000 square feet so only collected 1 sample.

Grid for property sketch

☐ - Tree

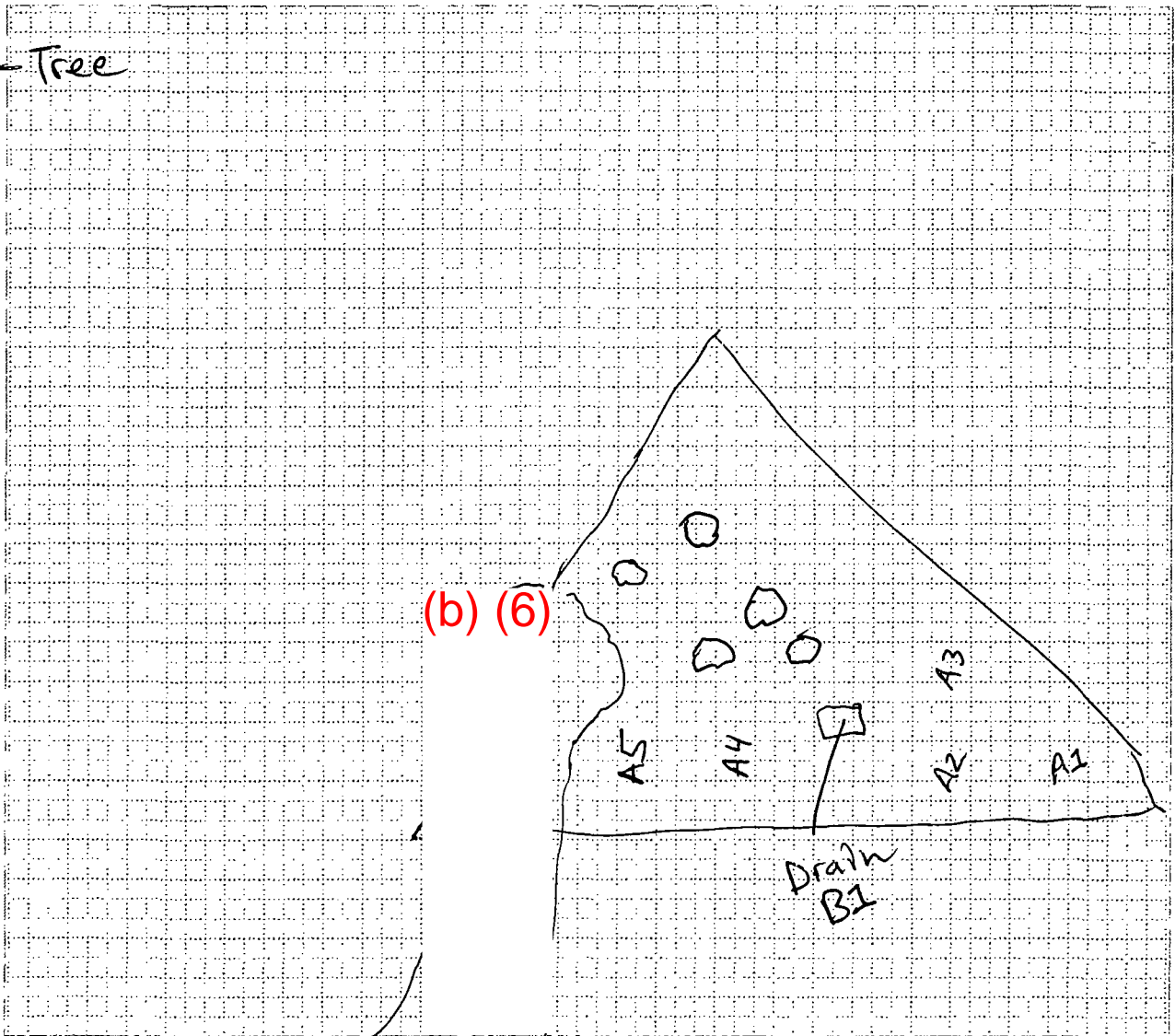

STATION ID: CV0003A SAMPLE ID: CV0003A-CS

SAMPLE COLLECTION TIME: 1515

Description of sample location (front, back, side yard; vegetable garden; play set; ditch, etc):

Collection: Composite or Grab MS/MSD? Y or N  
Field Duplicate or Split: Yes or No If yes, indicate Duplicate/split sample station ID: \_\_\_\_\_

GPS Coordinates: Trimble <input checked="" type="checkbox"/> Instrument #: <u>020168</u> Logged? <input checked="" type="checkbox"/> Y or N
Aliquot #1: Latitude: <u>33.55869527</u> N Longitude: <u>86.79911874</u> W Media description: <u>Dk brn silty</u>
Aliquot #2: Latitude: <u>33.55875955</u> N Longitude: <u>86.79904994</u> W Media description: <u>Orange sandy silty clay</u>
Aliquot #3: Latitude: <u>33.55872408</u> N Longitude: <u>86.79898818</u> W Media description: <u>Brn silty clay</u>
Aliquot #4: Latitude: <u>33.55877030</u> N Longitude: <u>86.79897297</u> W Media description: <u>Same as A1</u>
Aliquot #5: Latitude: <u>33.55877516</u> N Longitude: <u>86.79892397</u> W Media description: <u>Same as A1</u>

STATION ID: CV0003B SAMPLE ID: CV0003B-GS

SAMPLE COLLECTION TIME: 1525

Description of sample location (front, back, side yard; vegetable garden; play set; ditch, etc):

Drain

Collection: Composite or Grab MS/MSD? Y or N  
Field Duplicate or Split: Yes or No If yes, indicate Duplicate/split sample station ID: \_\_\_\_\_

GPS Coordinates: Trimble <input checked="" type="checkbox"/> Instrument #: <u>020168</u> Logged? <input checked="" type="checkbox"/> Y or N
Aliquot #1: Latitude: <u>33.55871916</u> N Longitude: <u>86.79907469</u> W Media description: <u>Dk brn silty clay</u>
Aliquot #2: Latitude: _____ N Longitude: _____ W Media description: _____
Aliquot #3: Latitude: _____ N Longitude: _____ W Media description: _____
Aliquot #4: Latitude: _____ N Longitude: _____ W Media description: _____
Aliquot #5: Latitude: _____ N Longitude: _____ W Media description: _____

(b) (6)

ADDRESS: No address for lot PROPERTY ID: CV0747

DATE: 5/21/13 ARRIVAL TIME: 0845

Other pertinent information (weather conditions, etc.):

~80°F + clear

PROPERTY COMMENTS:

Empty lot, dirt driveway to carport on lot.  
Lot < 3000 square feet so only collected 1  
5-point composite sample.

Grid for property sketch

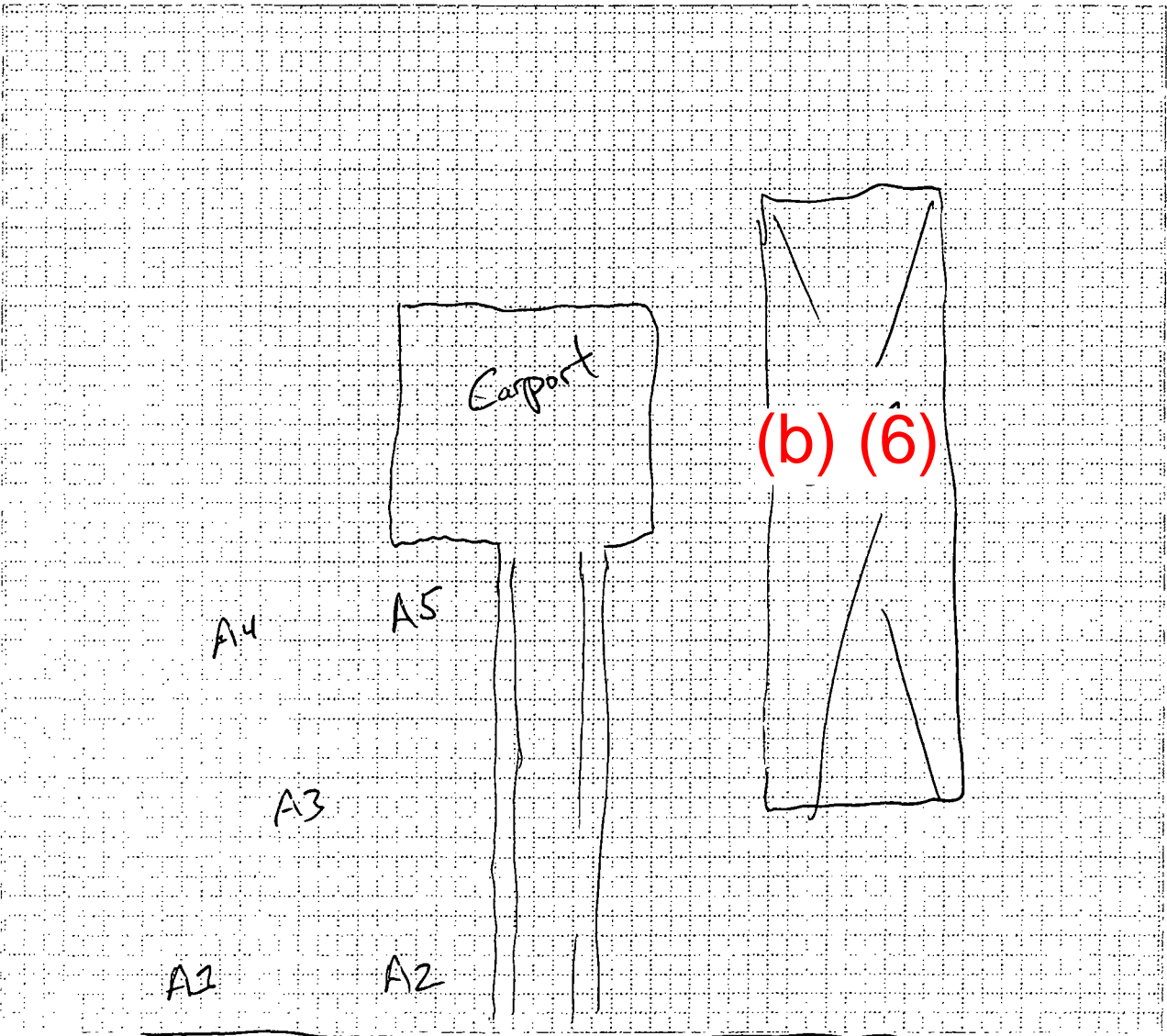

(b) (6)

STATION ID: CV0747A SAMPLE ID: CV0747A-CS

SAMPLE COLLECTION TIME: 0855

Description of sample location (front, back, side yard; vegetable garden; play set; ditch, etc):

Front yard

Collection: Composite or Grab

MS/MSD? Y or N

Field Duplicate or Split: Yes or No If yes, indicate Duplicate split sample station ID: CV0747A

GPS Coordinates: Trimble <input checked="" type="checkbox"/>	Instrument #: <u>020168</u>	Logged? <input checked="" type="checkbox"/>	Y or N
Aliquot #1: Latitude: <u>33.55819953</u>	N Longitude: <u>86.79487352</u>		W
Media description: <u>dk brn silty clay with gravel</u>			
Aliquot #2: Latitude: <u>33.55820226</u>	N Longitude: <u>86.79490117</u>		W
Media description: <u>Same as A1</u>			
Aliquot #3: Latitude: <u>33.55816278</u>	N Longitude: <u>86.79488844</u>		W
Media description: <u>Same as A1</u>			
Aliquot #4: Latitude: <u>33.55807576</u>	N Longitude: <u>86.79489377</u>		W
Media description: <u>Same as A1</u>			
Aliquot #5: Latitude: <u>33.55810402</u>	N Longitude: <u>86.79491827</u>		W
Media description: <u>Same as A1</u>			

STATION ID: \_\_\_\_\_ SAMPLE ID: \_\_\_\_\_

SAMPLE COLLECTION TIME: \_\_\_\_\_

Description of sample location (front, back, side yard; vegetable garden; play set; ditch, etc):

Collection: Composite or Grab

MS/MSD? Y or N

Field Duplicate or Split: Yes or No If yes, indicate Duplicate/split sample station ID: \_\_\_\_\_

GPS Coordinates: Trimble [ ]	Instrument #: _____	Logged? Y or N
Aliquot #1: Latitude: _____	N Longitude: _____	W
Media description: _____		
Aliquot #2: Latitude: _____	N Longitude: _____	W
Media description: _____		
Aliquot #3: Latitude: _____	N Longitude: _____	W
Media description: _____		
Aliquot #4: Latitude: _____	N Longitude: _____	W
Media description: _____		
Aliquot #5: Latitude: _____	N Longitude: _____	W
Media description: _____		

(b) (6)

ADDRESS: \_\_\_\_\_ PROPERTY ID: CV-1358

DATE: 5/21/13 ARRIVAL TIME: 0920

Other pertinent information (weather conditions, etc.):  
82°F + clear

PROPERTY COMMENTS:

Empty lot north of house (b) (6)  
~~has~~ Entire lot covered with grass. Railroad  
adjacent to north of lot.

Grid for property sketch

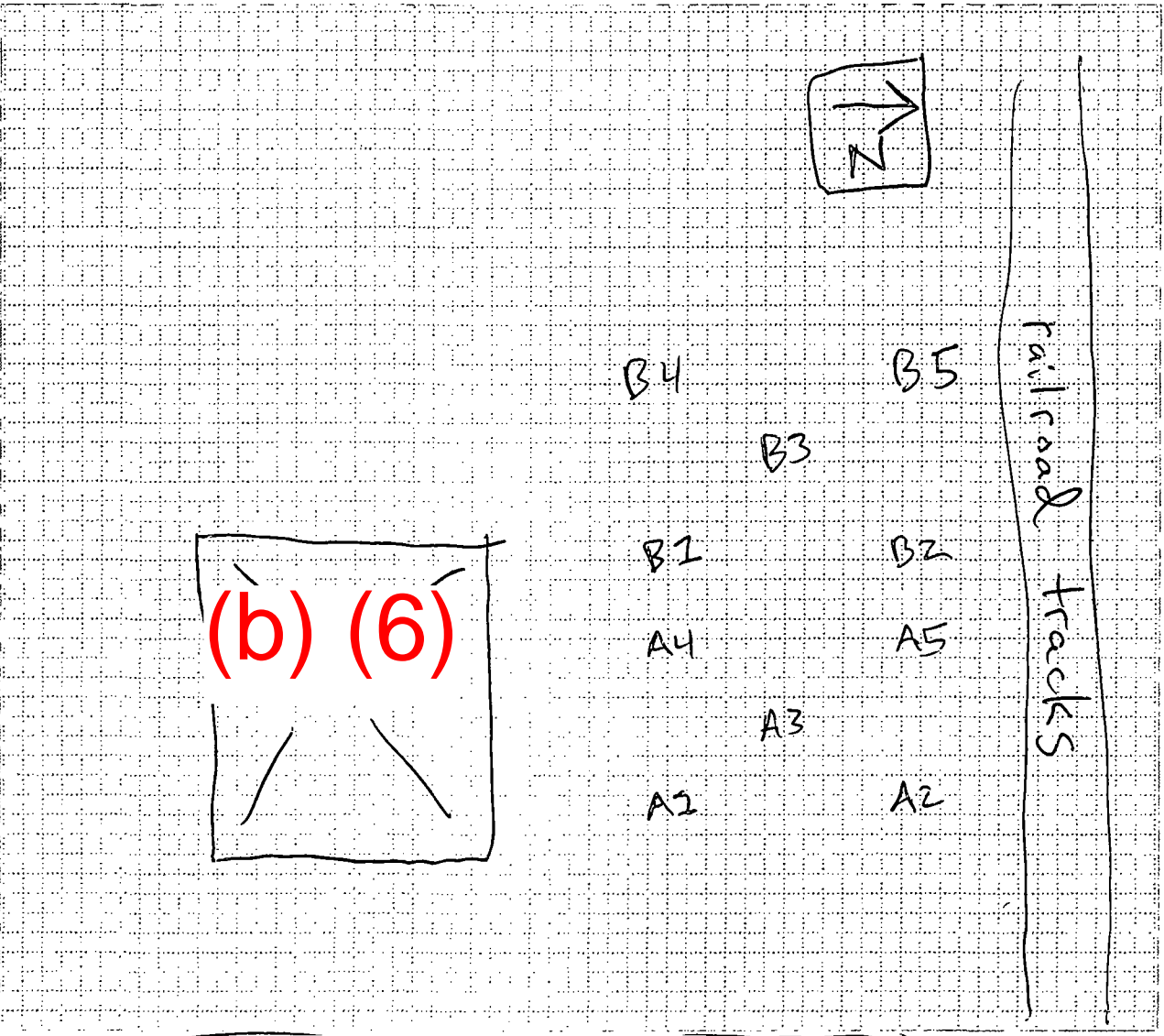

(b) (6)

STATION ID: CV1358A SAMPLE ID: CV1358A-CS

SAMPLE COLLECTION TIME: 0930

Description of sample location (front, back, side yard; vegetable garden; play set; ditch, etc):

Front yard

Collection: Composite or Grab MS/MSD? Y or N

Field Duplicate or Split: Yes or No If yes, indicate Duplicate/split sample station ID: CV1358A

GPS Coordinates: Trimble <input checked="" type="checkbox"/>	Instrument #: <u>020168</u>	Logged? <input checked="" type="checkbox"/> Y or N
Aliquot #1: Latitude: <u>33.55246593</u>	N Longitude: <u>86.79849423</u>	W
Media description: <u>Dk brn silty clay</u>		
Aliquot #2: Latitude: <u>33.55259175</u>	N Longitude: <u>86.79847850</u>	W
Media description: <u>Same as A1</u>		
Aliquot #3: Latitude: <u>33.55251261</u>	N Longitude: <u>86.79851256</u>	W
Media description: <u>Same as A1</u>		
Aliquot #4: Latitude: <u>33.55246443</u>	N Longitude: <u>86.79853669</u>	W
Media description: <u>Same as A1</u>		
Aliquot #5: Latitude: <u>33.55258941</u>	N Longitude: <u>86.79854167</u>	W
Media description: <u>Same as A1</u>		

STATION ID: CV1358B SAMPLE ID: CV1358B-CS

SAMPLE COLLECTION TIME: 0940

Description of sample location (front, back, side yard; vegetable garden; play set; ditch, etc):

Back yard

Collection: Composite or Grab MS/MSD? Y or N

Field Duplicate or Split: Yes or No If yes, indicate Duplicate/split sample station ID: \_\_\_\_\_

GPS Coordinates: Trimble <input checked="" type="checkbox"/>	Instrument #: <u>020168</u>	Logged? <input checked="" type="checkbox"/> Y or N
Aliquot #1: Latitude: <u>33.55245893</u>	N Longitude: <u>86.79858787</u>	W
Media description: <u>Dk brn silty clay</u>		
Aliquot #2: Latitude: <u>33.55259174</u>	N Longitude: <u>86.79857405</u>	W
Media description: <u>Same as B1</u>		
Aliquot #3: Latitude: <u>33.55252782</u>	N Longitude: <u>86.79863305</u>	W
Media description: <u>Same as B1</u>		
Aliquot #4: Latitude: <u>33.55248073</u>	N Longitude: <u>86.79867031</u>	W
Media description: <u>Same as B1</u>		
Aliquot #5: Latitude: <u>33.55260163</u>	N Longitude: <u>86.79866580</u>	W
Media description: <u>Same as B1</u>		

ADDRESS: **(b) (6)**

PROPERTY ID: CV1351

DATE: 5/21/13

ARRIVAL TIME: 1035

Other pertinent information (weather conditions, etc.):

PROPERTY COMMENTS:

Small lot with house and a shed in back yard. Small front yard so only did a 3-point composite.

Grid for property sketch

~~xx~~ Fence

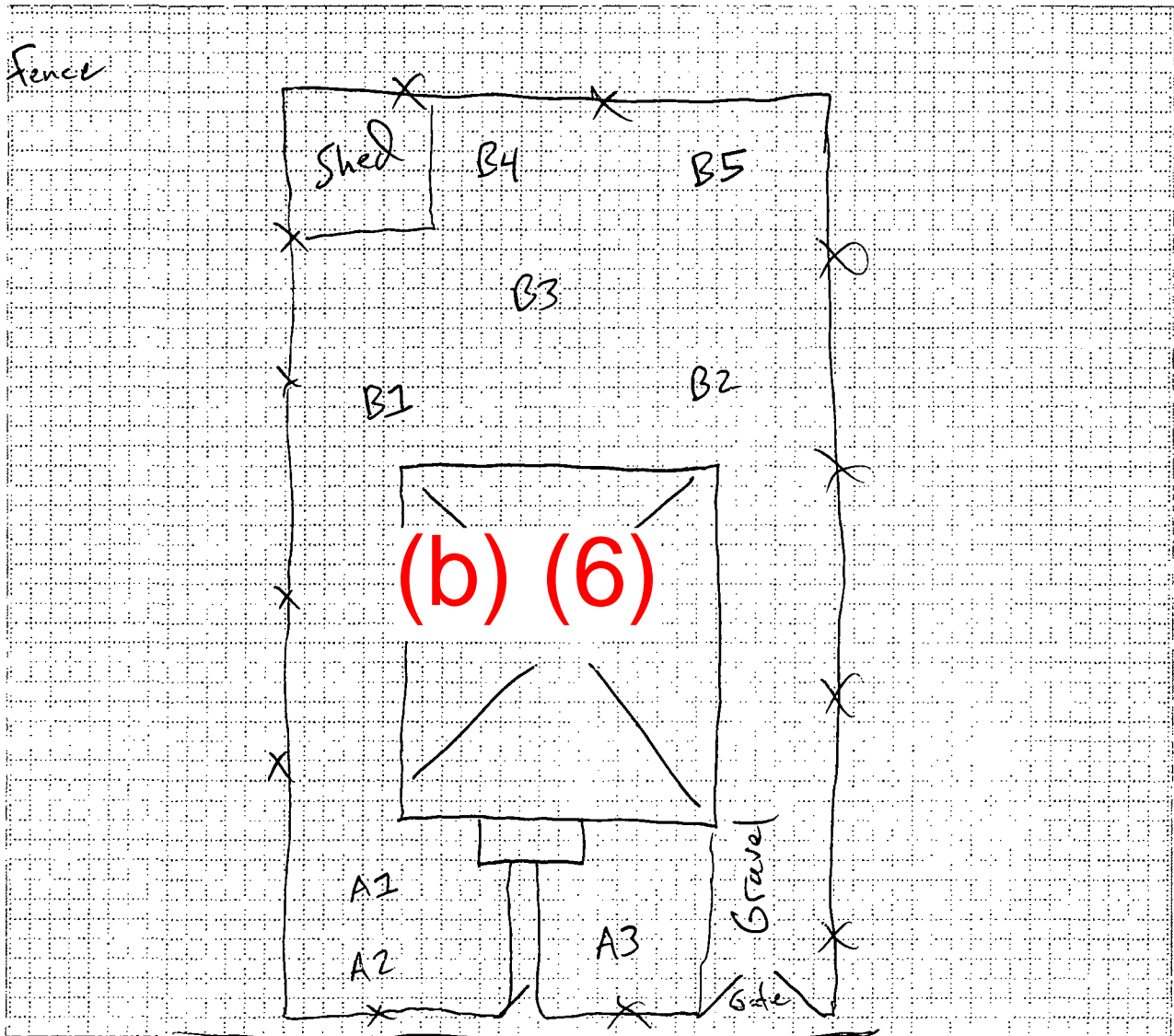

**(b) (6)**

STATION ID: CV1351B SAMPLE ID: CV1351B-CS

SAMPLE COLLECTION TIME: 1040

Description of sample location (front, back, side yard; vegetable garden; play set; ditch, etc):  
Back yard

Collection: Composite or Grab MS/MSD? Y or N

Field Duplicate or Split: Yes or No If yes, indicate Duplicate/split sample station ID: \_\_\_\_\_

GPS Coordinates: Trimble <input checked="" type="checkbox"/> Instrument #: <u>020168</u> Logged? <input checked="" type="checkbox"/> or N
Aliquot #1: Latitude: <u>33.55165812</u> N Longitude <u>86.79864849</u> W Media description: <u>DK brn silty clay</u>
Aliquot #2: Latitude: <u>33.55170557</u> N Longitude <u>86.79868419</u> W Media description: <u>Same as A1</u>
Aliquot #3: Latitude: <u>33.55166759</u> N Longitude <u>86.79868989</u> W Media description: <u>Same as A1</u>
Aliquot #4: Latitude: <del>Brn clay</del> <u>33.55168171</u> N Longitude <u>86.79872354</u> W Media description: <u>Brn clay with coal</u>
Aliquot #5: Latitude: <u>33.55171262</u> N Longitude <u>86.79871369</u> W Media description: <u>Brn clay with coal</u>

STATION ID: CV1351A SAMPLE ID: CV1351A-CS

SAMPLE COLLECTION TIME: 1050

Description of sample location (front, back, side yard; vegetable garden; play set; ditch, etc):  
Front yard

Collection: Composite or Grab MS/MSD? Y or N

Field Duplicate or Split: Yes or No If yes, indicate Duplicate/split sample station ID: \_\_\_\_\_

GPS Coordinates: Trimble <input checked="" type="checkbox"/> Instrument #: <u>020168</u> Logged? <input checked="" type="checkbox"/> or N
Aliquot #1: Latitude: <u>33.55163656</u> N Longitude <u>86.79847827</u> W Media description: <u>DK brn silty clay</u>
Aliquot #2: Latitude: <u>33.55163507</u> N Longitude <u>86.79845175</u> W Media description: <u>Same as B1</u>
Aliquot #3: Latitude: <u>33.55170112</u> N Longitude <u>86.79845606</u> W Media description: <u>Same as B1</u>
<del>Aliquot #4: Latitude: _____ N Longitude _____ W Media description: _____</del>
<del>Aliquot #5: Latitude: _____ N Longitude _____ W Media description: _____</del>



(b) (6)

ADDRESS:

PROPERTY ID:

FMO217

DATE:

5/21/13

ARRIVAL TIME:

1455

Other pertinent information (weather conditions, etc.):

~ 90°F + partly cloudy

PROPERTY COMMENTS:

Empty lot with dense brush.

Grid for property sketch

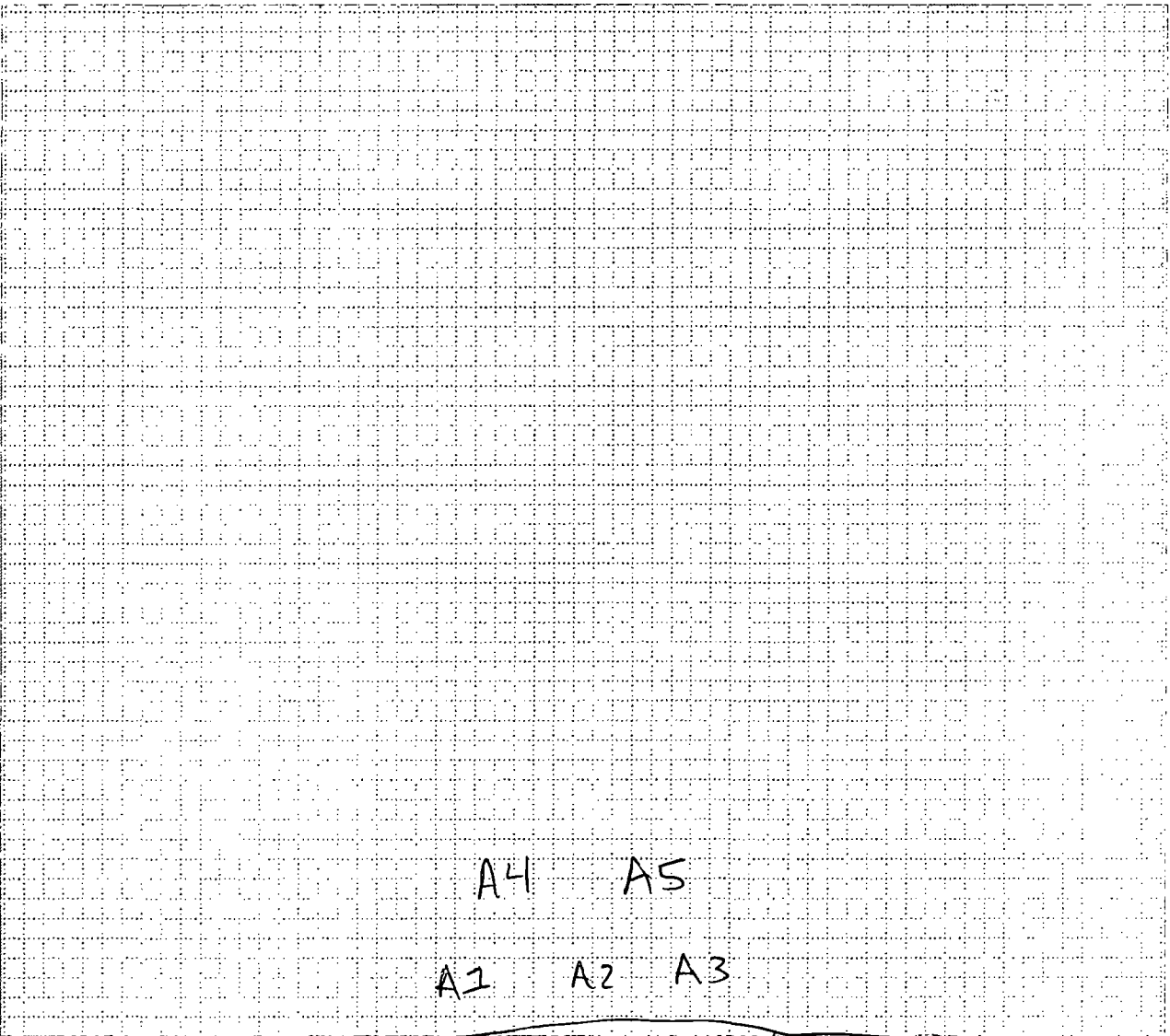

(b) (6)

STATION ID: FM0217A

SAMPLE ID: FM0217A-CS

SAMPLE COLLECTION TIME: 1500

Description of sample location (front, back, side yard; vegetable garden; play set; ditch, etc):  
North end of lot

Collection: Composite or Grab MS/MSD? Y or N

Field Duplicate or Split: No If yes, indicate Duplicate/split sample station ID: \_\_\_\_\_

GPS Coordinates: Trimble <input checked="" type="checkbox"/>	Instrument #: <u>020168</u>	Logged? <input checked="" type="checkbox"/>	Y or N
Aliquot #1: Latitude: <u>33.57115962</u>	N Longitude: <u>86.80588283</u>		W
Media description: <u>Dk bra silty clay</u>			
Aliquot #2: Latitude: <u>33.57117450</u>	N Longitude: <u>86.80597055</u>		W
Media description: <u>Same as A1</u>			
Aliquot #3: Latitude: <u>33.57116356</u>	N Longitude: <u>86.80596478</u>		W
Media description: <u>Same as A1</u>			
Aliquot #4: Latitude: <u>33.57112095</u>	N Longitude: <u>86.80590128</u>		W
Media description: <u>Same as A1</u>			
Aliquot #5: Latitude: <u>33.57112916</u>	N Longitude: <u>86.80591837</u>		W
Media description: <u>Same as A1</u>			

~~STATION ID: \_\_\_\_\_ SAMPLE ID: \_\_\_\_\_~~

~~SAMPLE COLLECTION TIME: \_\_\_\_\_~~

~~Description of sample location (front, back, side yard; vegetable garden; play set; ditch, etc):  
\_\_\_\_\_~~

~~Collection: Composite or Grab MS/MSD? Y or N~~

~~Field Duplicate or Split: Yes or No If yes, indicate Duplicate/split sample station ID: \_\_\_\_\_~~

GPS Coordinates: Trimble [ ]	Instrument #: _____	Logged? Y or N
Aliquot #1: Latitude: _____	N Longitude: _____	W
Media description: _____		
Aliquot #2: Latitude: _____	N Longitude: _____	W
Media description: _____		
Aliquot #3: Latitude: _____	N Longitude: _____	W
Media description: _____		
Aliquot #4: Latitude: _____	N Longitude: _____	W
Media description: _____		
Aliquot #5: Latitude: _____	N Longitude: _____	W
Media description: _____		

ADDRESS: (b) (6)

PROPERTY ID: CV1034

DATE: 5/22/13

ARRIVAL TIME: 0817

Other pertinent information (weather conditions, etc.):

~ 74°F & cloudy

PROPERTY COMMENTS:

Empty lot at the intersection of (b) (6) and (b) (6). Only 1-5 point composite sample collected due to lot being only 3,454 square feet.

Grid for property sketch

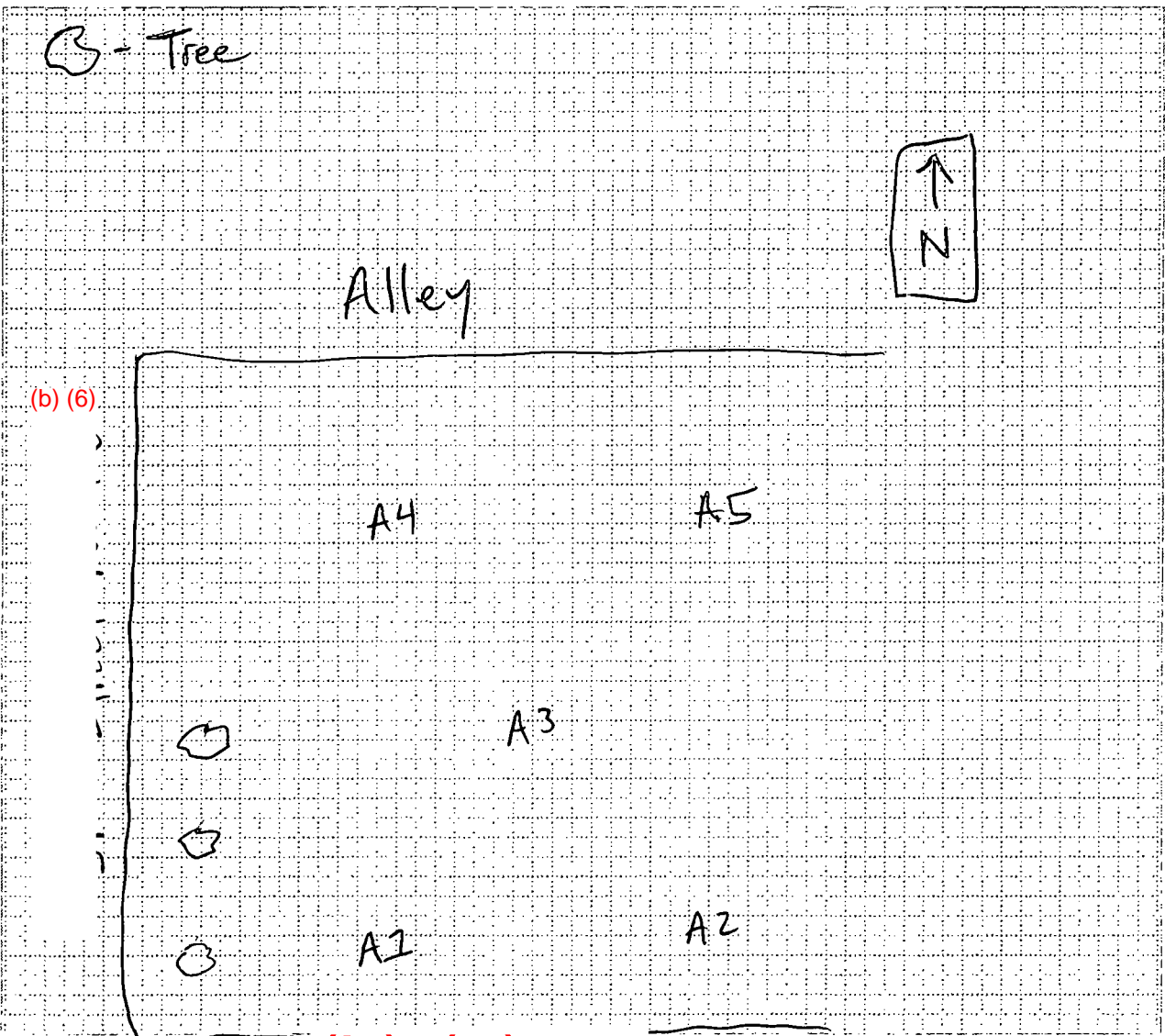

(b) (6)

STATION ID: CV1034A SAMPLE ID: CV1034A-CS

SAMPLE COLLECTION TIME: 0825

Description of sample location (front, back, side yard; vegetable garden; play set; ditch, etc):

Collection: Composite or Grab MS/MSD? Y or N  
Field Duplicate or Split: Yes or No If yes, indicate Duplicate/split sample station ID: CV1034A

GPS Coordinates: Trimble <input checked="" type="checkbox"/>	Instrument #: <u>020168</u>	Logged? <input checked="" type="checkbox"/>	Y or N
Aliquot #1: Latitude: <u>33.55057808</u>	N Longitude: <u>86.80478470</u>		W
Media description: <u>Dk brn silty clay with coal + pieces of shingle.</u>			
Aliquot #2: Latitude: <u>33.55058275</u>	N Longitude: <u>86.80474999</u>		W
Media description: <u>Same as A1</u>			
Aliquot #3: Latitude: <u>33.55068292</u>	N Longitude: <u>86.80475820</u>		W
Media description: <u>Same as A1</u>			
Aliquot #4: Latitude: <u>33.55077018</u>	N Longitude: <u>86.80478131</u>		W
Media description: <u>Same as A1</u>			
Aliquot #5: Latitude: <u>33.5507<sup>NS</sup>55075343</u>	N Longitude: <u>86.80474366</u>		W
Media description: <u>Same as A1</u>			

STATION ID: \_\_\_\_\_ SAMPLE ID: \_\_\_\_\_

SAMPLE COLLECTION TIME: \_\_\_\_\_

Description of sample location (front, back, side yard; vegetable garden; play set; ditch, etc):

Collection: Composite or Grab MS/MSD? Y or N  
Field Duplicate or Split: Yes or No If yes, indicate Duplicate/split sample station ID: \_\_\_\_\_

GPS Coordinates: Trimble [ ]	Instrument #: _____	Logged? Y or N
Aliquot #1: Latitude: _____	N Longitude: _____	W
Media description: _____		
Aliquot #2: Latitude: _____	N Longitude: _____	W
Media description: _____		
Aliquot #3: Latitude: _____	N Longitude: _____	W
Media description: _____		
Aliquot #4: Latitude: _____	N Longitude: _____	W
Media description: _____		
Aliquot #5: Latitude: _____	N Longitude: _____	W
Media description: _____		

(b) (6)

ADDRESS:

PROPERTY ID: CV0986

DATE: 5/22/13

ARRIVAL TIME: 0844

Other pertinent information (weather conditions, etc.):

~ 74°F & cloudy

PROPERTY COMMENTS:

Empty lot

Grid for property sketch

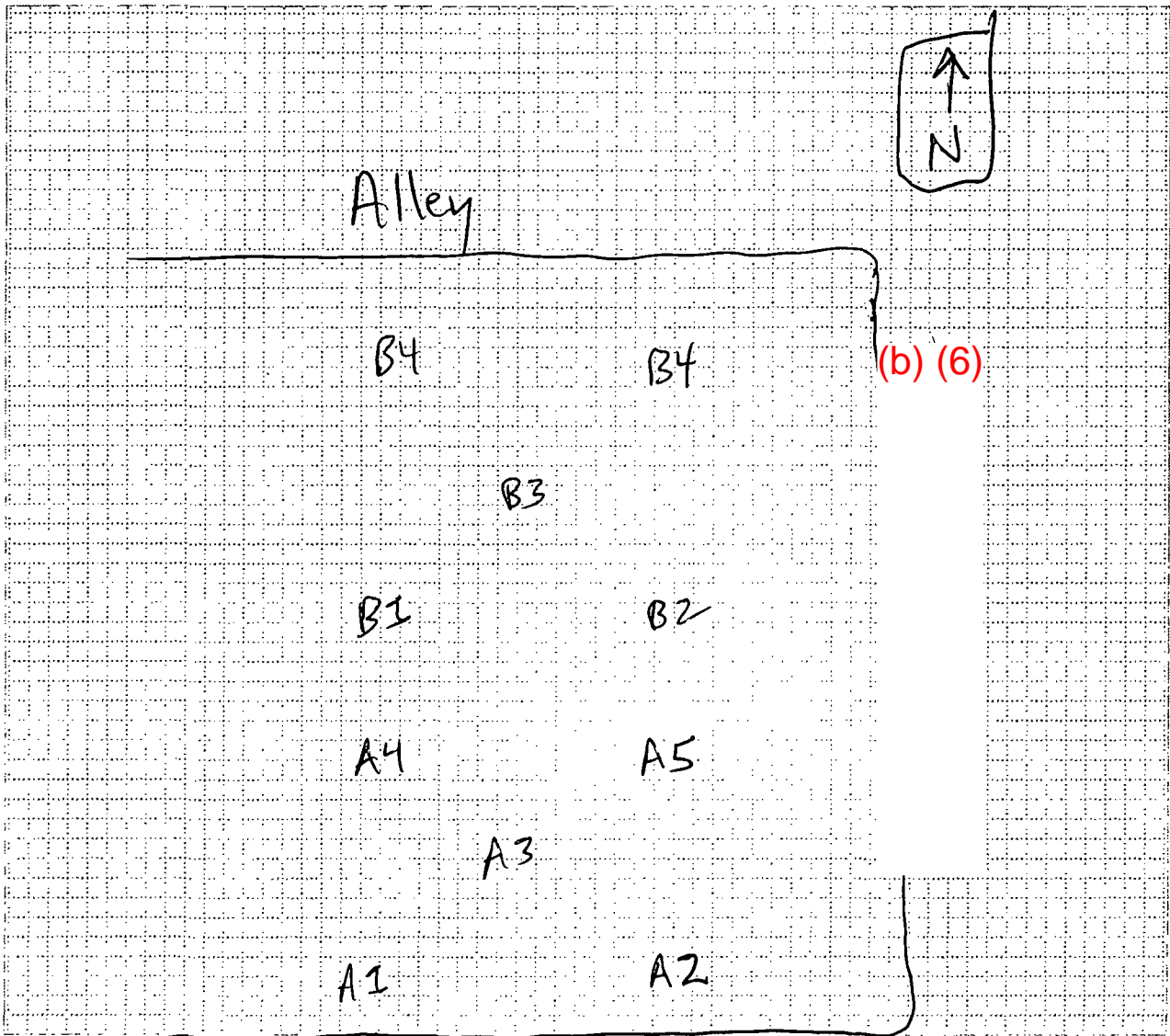

(b) (6)

STATION ID: CV0986A SAMPLE ID: CV0986A-CS

SAMPLE COLLECTION TIME: 0855

Description of sample location (front, back, side yard; vegetable garden; play set; ditch, etc):  
South half

Collection: Composite or Grab MS/MSD? Y or N

Field Duplicate or Split: Yes or No If yes, indicate Duplicate/split sample station ID: CV0986

GPS Coordinates: Trimble <input checked="" type="checkbox"/> Instrument #: <u>020168</u> Logged? <input checked="" type="checkbox"/> or N
Aliquot #1: Latitude: <u>33.54975882</u> N Longitude <u>86.80255527</u> W Media description: <u>Brn silty clay with coal</u>
Aliquot #2: Latitude: <u>33.54976561</u> N Longitude <u>86.80244819</u> W Media description: <u>Same as A1</u>
Aliquot #3: Latitude: <u>33.54980498</u> N Longitude <u>86.80249938</u> W Media description: <u>Dk brn silty clay with coal</u>
Aliquot #4: Latitude: <u>33.54986314</u> N Longitude <u>86.80255842</u> W Media description: <u>Same as B3</u>
Aliquot #5: Latitude: <u>33.54986282</u> N Longitude <u>86.80245361</u> W Media description: <u>Same as B3</u>

STATION ID: CV0986B SAMPLE ID: CV0986B-CS

SAMPLE COLLECTION TIME: 0905

Description of sample location (front, back, side yard; vegetable garden; play set; ditch, etc):  
North half

Collection: Composite or Grab MS/MSD? Y or N

Field Duplicate or Split: Yes or No If yes, indicate Duplicate/split sample station ID: \_\_\_\_\_

GPS Coordinates: Trimble <input checked="" type="checkbox"/> Instrument #: <u>020168</u> Logged? <input checked="" type="checkbox"/> or N
Aliquot #1: Latitude: <u>33.54991126</u> N Longitude <u>86.80255341</u> W Media description: <u>Dk brn silty clay with coal + gravel</u>
Aliquot #2: Latitude: <u>33.54991995</u> N Longitude <u>86.80244505</u> W Media description: <u>Same as B1</u>
Aliquot #3: Latitude: <u>33.54995458</u> N Longitude <u>86.80248741</u> W Media description: <u>Same as B1</u>
Aliquot #4: Latitude: <u>33.55003100</u> N Longitude <u>86.80254565</u> W Media description: <u>Same as B1</u>
Aliquot #5: Latitude: <u>33.55001441</u> N Longitude <u>86.80244987</u> W Media description: <u>Same as B1</u>

(b) (6)

ADDRESS: \_\_\_\_\_ PROPERTY ID: CV1073

DATE: 5/22/13 ARRIVAL TIME: 0920

Other pertinent information (weather conditions, etc.):

~ 75° F + cloudy

PROPERTY COMMENTS:

Empty lot with vegetation + trees.

Grid for property sketch

○ - Tree

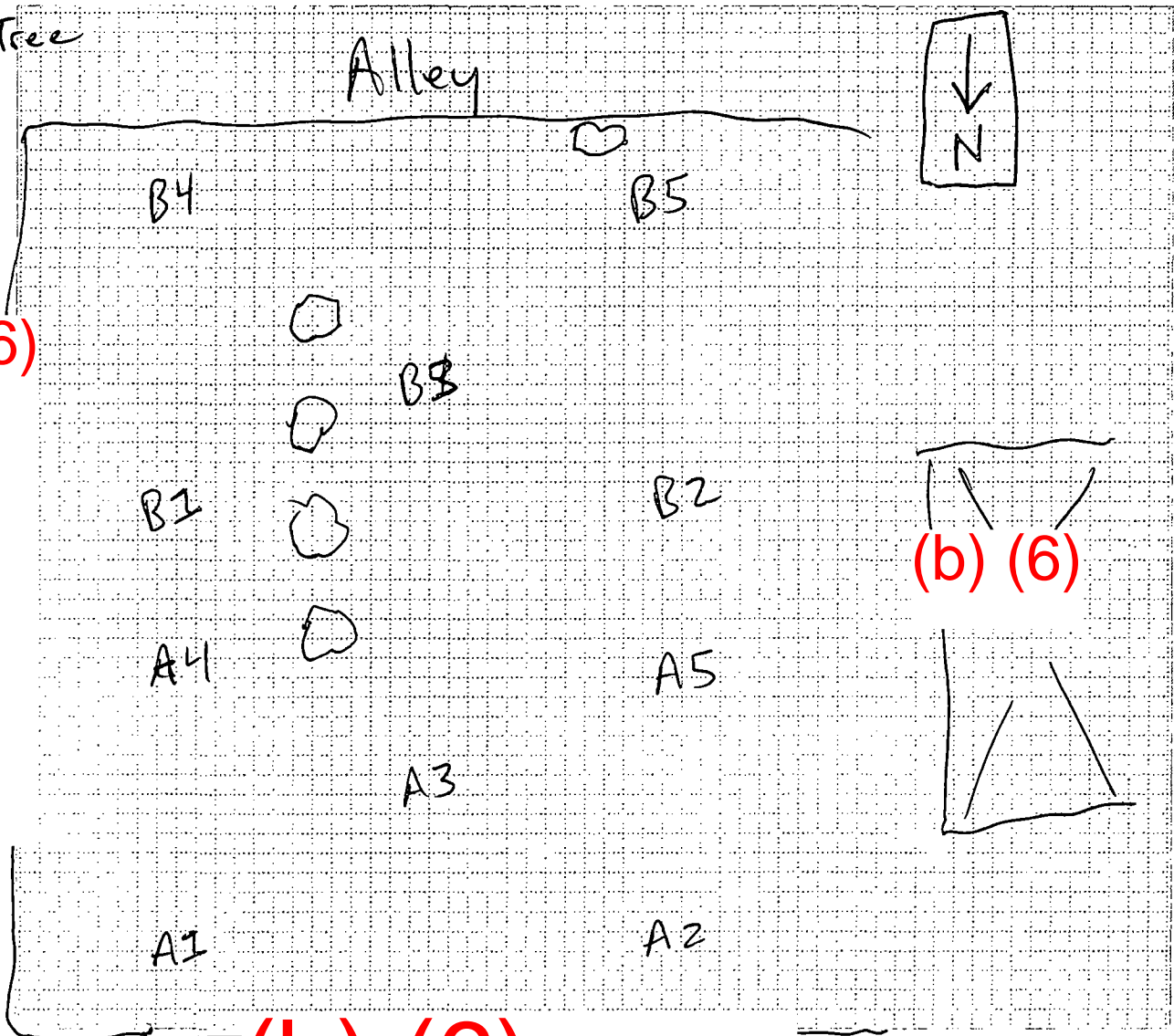

(b) (6)

STATION ID: CV1073A

SAMPLE ID: CV1073A-CS

SAMPLE COLLECTION TIME: 0930

Description of sample location (front, back, side yard; vegetable garden; play set; ditch, etc):

North half

Collection: Composite or Grab

MS/MSD? Y or N

Field Duplicate or Split: Yes or No If yes, indicate Duplicate/split sample station ID: \_\_\_\_\_

GPS Coordinates: Trimble <input checked="" type="checkbox"/>	Instrument #: <u>020168</u>	Logged? <input checked="" type="checkbox"/>	Y or N
Aliquot #1: Latitude: <u>33.55030921</u>	N Longitude: <u>86.80073900</u>		W
Media description: <u>Brn sandy silt with gravel</u>			
Aliquot #2: Latitude: <u>33.55032473</u>	N Longitude: <u>86.80085511</u>		W
Media description: <u>Same as A1</u>			
Aliquot #3: Latitude: <u>33.55027496</u>	N Longitude: <u>86.80080430</u>		W
Media description: <u>Same as A1</u>			
Aliquot #4: Latitude: <u>33.55022568</u>	N Longitude: <u>86.80074059</u>		W
Media description: <u>Same as A1</u>			
Aliquot #5: Latitude: <u>33.55022361</u>	N Longitude: <u>86.80089901</u>		W
Media description: <u>Same as A1</u>			

STATION ID: CV1073B-

SAMPLE ID: CV1073B-CS

SAMPLE COLLECTION TIME: 0940

Description of sample location (front, back, side yard; vegetable garden; play set; ditch, etc):

South half

Collection: Composite or Grab

MS/MSD? Y or N

Field Duplicate or Split: Yes or No If yes, indicate Duplicate/split sample station ID: \_\_\_\_\_

GPS Coordinates: Trimble <input checked="" type="checkbox"/>	Instrument #: <u>020168</u>	Logged? <input checked="" type="checkbox"/>	Y or N
Aliquot #1: Latitude: <u>33.55016914</u>	N Longitude: <u>86.80072267</u>		W
Media description: <u>Brn sandy silt</u>			
Aliquot #2: Latitude: <u>33.55016470</u>	N Longitude: <u>86.80088943</u>		W
Media description: <u>Dk brn silty clay</u>			
Aliquot #3: Latitude: <u>33.55009799</u>	N Longitude: <u>86.80082818</u>		W
Media description: <u>Same as B2</u>			
Aliquot #4: Latitude: <u>33.55065621</u>	N Longitude: <u>86.80074067</u>		W
Media description: <u>Same as B2</u>			
Aliquot #5: Latitude: <u>33.55009336</u>	N Longitude: <u>86.80087078</u>		W
Media description: <u>Same as B2</u>			



(b) (6)

ADDRESS:

PROPERTY ID: CV0992

DATE: 5/22/13

ARRIVAL TIME: 1005

Other pertinent information (weather conditions, etc.):

~ 77°F + cloudy

PROPERTY COMMENTS:

Empty lot with thick vegetation and trees.

This lot is adjacent to the east of

CV0991.

Grid for property sketch

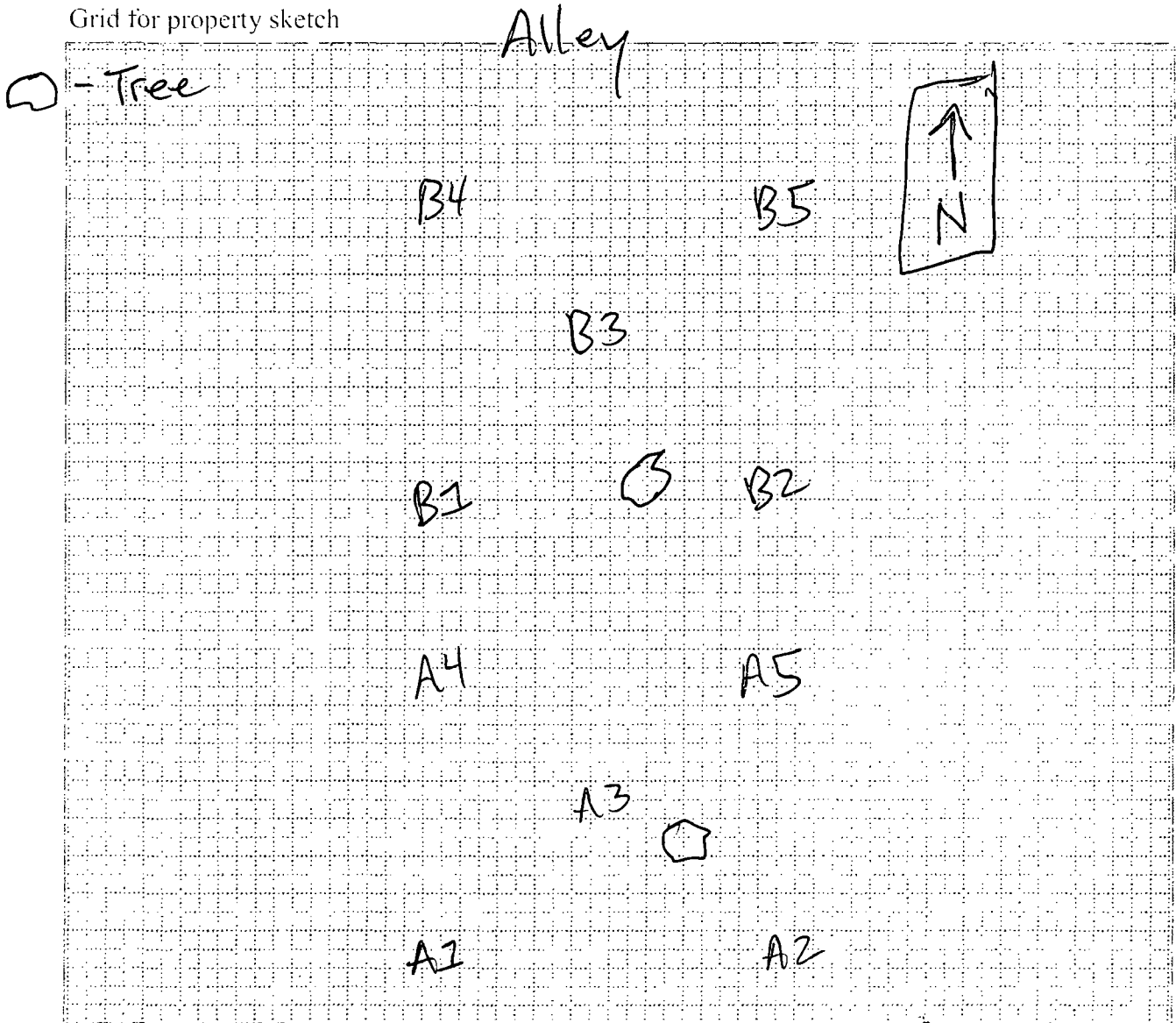

(b) (6)

STATION ID: CV0992A SAMPLE ID: CV0992A-CS

SAMPLE COLLECTION TIME: 1015

Description of sample location (front, back, side yard; vegetable garden; play set; ditch, etc):

South half

Collection: Composite or Grab

MS/MSD? Y or N

Field Duplicate or Split: Yes or No If yes, indicate Duplicate/split sample station ID: \_\_\_\_\_

GPS Coordinates: Trimble <input checked="" type="checkbox"/> Instrument #: <u>020168</u>	Logged? <input checked="" type="checkbox"/> or N
Aliquot #1: Latitude: <u>33.54968272</u>	N Longitude <u>86.80105854</u> W
Media description: <u>dk brn silty clay with coal</u>	
Aliquot #2: Latitude: <u>33.54967754</u>	N Longitude <u>86.80092830</u> W
Media description: <u>Same as A1</u>	
Aliquot #3: Latitude: <u>33.54974552</u>	N Longitude <u>86.80097626</u> W
Media description: <u>Same as A1</u>	
Aliquot #4: Latitude: <u>33.54980004</u>	N Longitude <u>86.80104517</u> W
Media description: <u>Blk silty clays with coal</u>	
Aliquot #5: Latitude: <u>33.54979772</u>	N Longitude <u>86.80096493</u> W
Media description: <u>Same as A4</u>	

STATION ID: CV0992B SAMPLE ID: CV0992B-CS

SAMPLE COLLECTION TIME: 1025

Description of sample location (front, back, side yard; vegetable garden; play set; ditch, etc):

North half

Collection: Composite or Grab

MS/MSD? Y or N

Field Duplicate or Split: Yes or No If yes, indicate Duplicate/split sample station ID: \_\_\_\_\_

GPS Coordinates: Trimble <input checked="" type="checkbox"/> Instrument #: <u>020168</u>	Logged? <input checked="" type="checkbox"/> or N
Aliquot #1: Latitude: <u>33.54983882</u>	N Longitude <u>86.80106524</u> W
Media description: <u>Blk silty clay</u>	
Aliquot #2: Latitude: <u>33.54983997</u>	N Longitude <u>86.80096012</u> W
Media description: <u>Same as B1</u>	
Aliquot #3: Latitude: <u>33.54988377</u>	N Longitude <u>86.80102476</u> W
Media description: <u>Same as B1</u>	
Aliquot #4: Latitude: <u>33.54993322</u>	N Longitude <u>86.80108931</u> W
Media description: <u>Same as B1</u>	
Aliquot #5: Latitude: <u>33.54995772</u>	N Longitude <u>86.80106668</u> W
Media description: <u>Same as B1</u>	

(b) (6)

ADDRESS: \_\_\_\_\_

PROPERTY ID: CV0991

DATE: 5/22/13

ARRIVAL TIME: 1035

Other pertinent information (weather conditions, etc.):

~ 78°F + cloudy

PROPERTY COMMENTS:

Empty mowed lot. This lot is adjacent to the west of CV0992.

Grid for property sketch

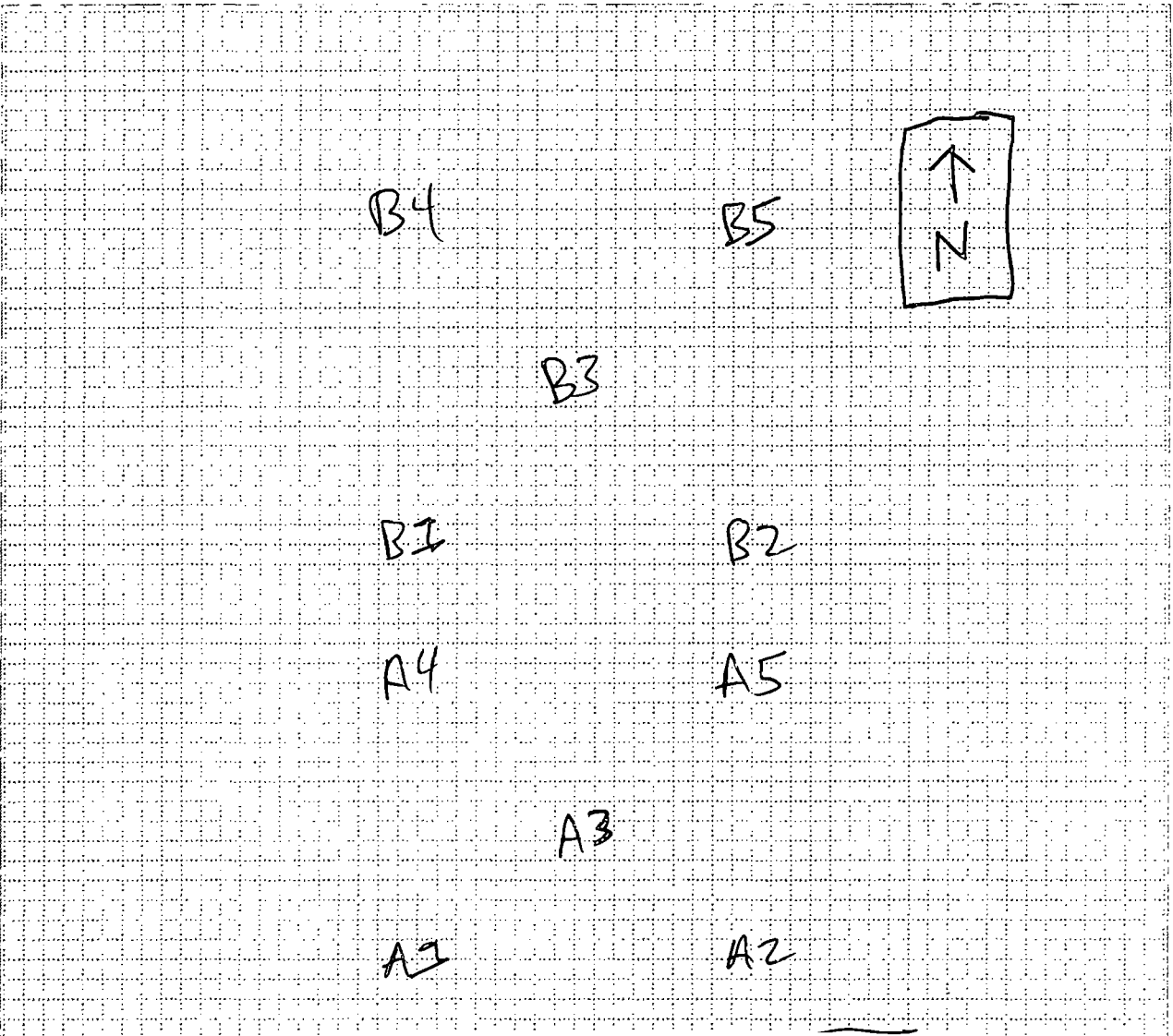

(b) (6)

STATION ID: CV0991A SAMPLE ID: CV0991A-CS

SAMPLE COLLECTION TIME: 1045

Description of sample location (front, back, side yard; vegetable garden; play set; ditch, etc):

South half

Collection: Composite or Grab

MS/MSD? Y or N

Field Duplicate or Split: Yes or No If yes, indicate Duplicate/split sample station ID: \_\_\_\_\_

GPS Coordinates: Trimble <input checked="" type="checkbox"/>	Instrument #: <u>020168</u>	Logged? <input checked="" type="checkbox"/>	Y or N
Aliquot #1: Latitude: <u>33.54970969</u>	N Longitude: <u>86.80173654</u>		W
Media description: <u>Dk brn silty clays with coal</u>			
Aliquot #2: Latitude: <u>33.54973528</u>	N Longitude: <u>86.80114415</u>		W
Media description: <u>Same as A1</u>			
Aliquot #3: Latitude: <u>33.54973967</u>	N Longitude: <u>86.80119070</u>		W
Media description: <u>Same as A1</u>			
Aliquot #4: Latitude: <u>33.54979962</u>	N Longitude: <u>86.80125100</u>		W
Media description: <u>Same as A1</u>			
Aliquot #5: Latitude: <u>33.54978386</u>	N Longitude: <u>86.80112294</u>		W
Media description: <u>Same as A1</u>			

STATION ID: CV0991B SAMPLE ID: CV0991B-CS

SAMPLE COLLECTION TIME: 1055

Description of sample location (front, back, side yard; vegetable garden; play set; ditch, etc):

North half

Collection: Composite or Grab

MS/MSD? Y or N

Field Duplicate or Split: Yes or No If yes, indicate Duplicate/split sample station ID: \_\_\_\_\_

GPS Coordinates: Trimble <input checked="" type="checkbox"/>	Instrument #: <u>020168</u>	Logged? <input checked="" type="checkbox"/>	Y or N
Aliquot #1: Latitude: <u>33.54983236</u>	N Longitude: <u>86.80124667</u>		W
Media description: <u>Dk brn silty clay</u>			
Aliquot #2: Latitude: <u>33.54983030</u>	N Longitude: <u>86.80113137</u>		W
Media description: <u>Same as B1</u>			
Aliquot #3: Latitude: <u>33.54988374</u>	N Longitude: <u>86.80118009</u>		W
Media description: <u>Gray sand</u>			
Aliquot #4: Latitude: <u>33.54996482</u>	N Longitude: <u>86.80122896</u>		W
Media description: <u>Same as B1</u>			
Aliquot #5: Latitude: <u>33.54996085</u>	N Longitude: <u>86.8011764</u>		W
Media description: <u>Blk silty clay with coal</u>			

(b) (6)

ADDRESS:

PROPERTY ID:

CV0990

DATE:

5/22/13

ARRIVAL TIME:

1223

Other pertinent information (weather conditions, etc.):

84°F + cloudy

PROPERTY COMMENTS:

Empty lot with one hackberry tree. From the road to about 15-20 feet into the lot the vegetation is browned out / stressed.

Grid for property sketch

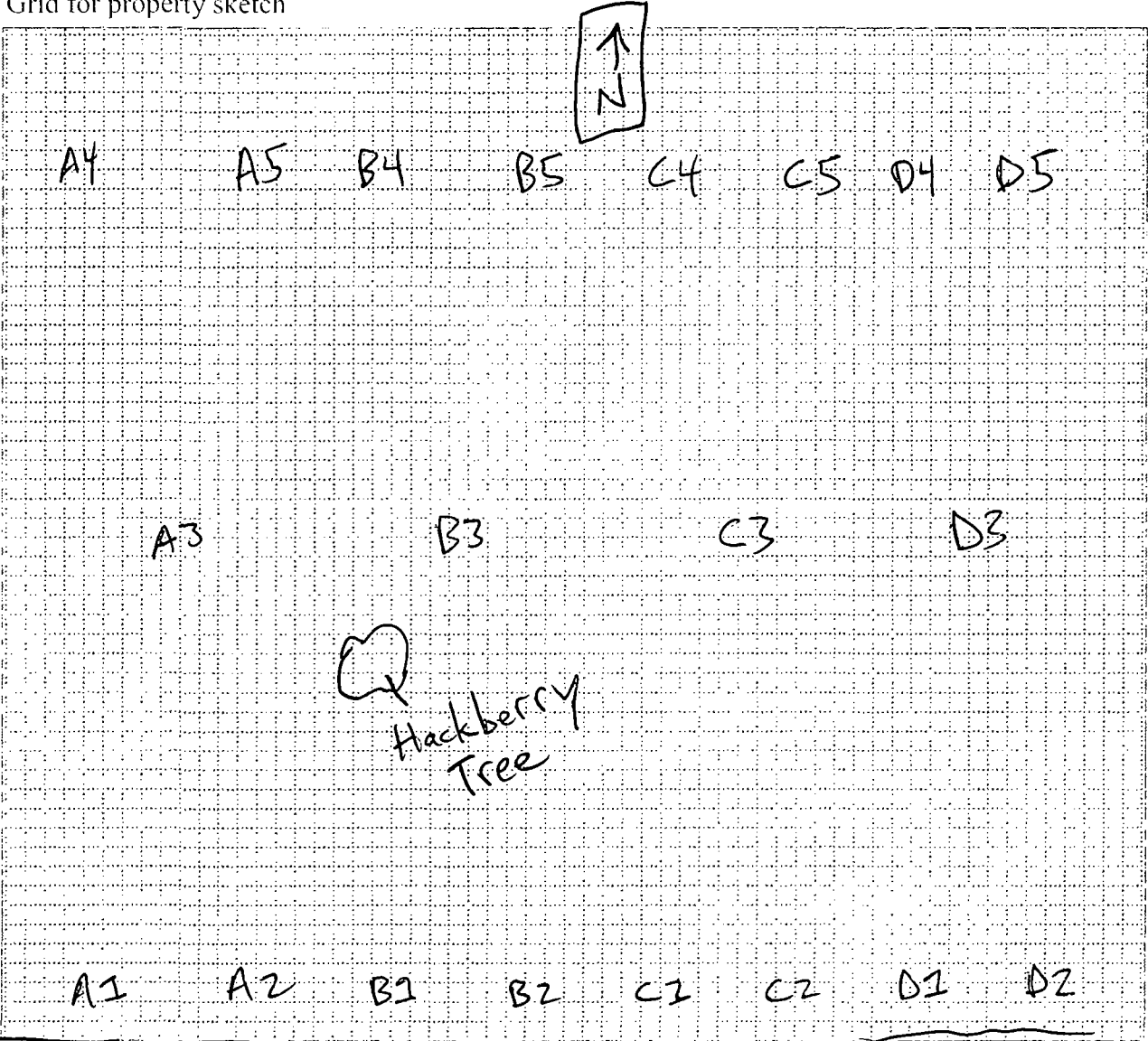

(b) (6)

STATION ID: CV0990A SAMPLE ID: CV0990A-CS

SAMPLE COLLECTION TIME: 1235

Description of sample location (front, back, side yard; vegetable garden; play set; ditch, etc):

West 1/4 of lot

Collection: Composite or Grab

MS/MSD? Y or N

Field Duplicate or Split: Yes or No If yes, indicate Duplicate/split sample station ID: \_\_\_\_\_

GPS Coordinates: Trimble <input checked="" type="checkbox"/>	Instrument #: <u>020168</u>	Logged? <input checked="" type="checkbox"/> or N
Aliquot #1: Latitude: <u>33.54970868</u>	N Longitude: <u>86.80171466</u>	W
Media description: <u>DK brn silty clays</u>		
Aliquot #2: Latitude: <u>33.54969729</u>	N Longitude: <u>86.80166692</u>	W
Media description: <u><del>33.54</del><sup>RS</sup> Same as A1</u>		
Aliquot #3: Latitude: <u><del>Brn silty</del><sup>RS</sup> 33.54982679</u>	N Longitude: <u>86.80168932</u>	W
Media description: <u>Brn silty sand</u>		
Aliquot #4: Latitude: <u>33.54993382</u>	N Longitude: <u>86.80171236</u>	W
Media description: <u>Brn silty sand</u>		
Aliquot #5: Latitude: <u>33.54996670</u>	N Longitude: <u>86.80167999</u>	W
Media description: <u>Brn silty sand</u>		

STATION ID: CV0990B SAMPLE ID: CV0990B-CS

SAMPLE COLLECTION TIME: 1245

Description of sample location (front, back, side yard; vegetable garden; play set; ditch, etc):

Left center 1/4 of lot

Collection: Composite or Grab

MS/MSD? Y or N

Field Duplicate or Split: Yes or No If yes, indicate Duplicate/split sample station ID: \_\_\_\_\_

GPS Coordinates: Trimble <input checked="" type="checkbox"/>	Instrument #: <u>020168</u>	Logged? <input checked="" type="checkbox"/> or N
Aliquot #1: Latitude: <u>33.54970372</u>	N Longitude: <u>86.80161122</u>	W
Media description: <u>DK brn silty clays</u>		
Aliquot #2: Latitude: <u>33.54970154</u>	N Longitude: <u>86.80155456</u>	W
Media description: <u>Same as B1</u>		
Aliquot #3: Latitude: <u>33.54981820</u>	N Longitude: <u>86.80158601</u>	W
Media description: <u>Same as B1</u>		
Aliquot #4: Latitude: <u>33.54991902</u>	N Longitude: <u>86.80155659</u>	W
Media description: <u>Brn silty sand</u>		
Aliquot #5: Latitude: <u>33.54991711</u>	N Longitude: <u>86.80153673</u>	W
Media description: <u>Same as B1</u>		

(b) (6)

ADDRESS:

PROPERTY ID: CV0990

DATE: 5/22/13

ARRIVAL TIME: 1223

Other pertinent information (weather conditions, etc.):

+84°F cloudy

PROPERTY COMMENTS:

See page 30.

Grid for property sketch

See sketch on page 30.

STATION ID: CV0990C SAMPLE ID: CV0990C-CS

SAMPLE COLLECTION TIME: 1255

Description of sample location (front, back, side yard; vegetable garden; play set; ditch, etc):

Right center 1/4 of lot

Collection: Composite or Grab

MS/MSD? Y or N

Field Duplicate or Split: Yes or No If yes, indicate Duplicate/split sample station ID: \_\_\_\_\_

GPS Coordinates: Trimble <input checked="" type="checkbox"/> Instrument #: <u>020168</u> Logged? <input checked="" type="checkbox"/> or N
Aliquot #1: Latitude: <u>33.54970408</u> N Longitude: <u>86.80150809</u> W
Media description: <u>Dk brn silty clays</u>
Aliquot #2: Latitude: <u>33.54970784</u> N Longitude: <u>86.80146213</u> W
Media description: <u>Same as C1</u>
Aliquot #3: Latitude: <u>33.54983346</u> N Longitude: <u>86.80147962</u> W
Media description: <u>Blk silty clays</u>
Aliquot #4: Latitude: <u>33.54991628</u> N Longitude: <u>86.80149650</u> W
Media description: <u>Same as C3</u>
Aliquot #5: Latitude: <u>33.54992633</u> N Longitude: <u>86.80143803</u> W
Media description: <u>Same as C3</u>

STATION ID: CV0990D SAMPLE ID: CV0990D-CS

SAMPLE COLLECTION TIME: ~~1305~~ 1310

Description of sample location (front, back, side yard; vegetable garden; play set; ditch, etc):

East 1/4 of lot

Collection: Composite or Grab

MS/MSD? Y or N

Field Duplicate or Split: Yes or No If yes, indicate Duplicate/split sample station ID: \_\_\_\_\_

GPS Coordinates: Trimble <input checked="" type="checkbox"/> Instrument #: <u>020168</u> Logged? <input checked="" type="checkbox"/> or N
Aliquot #1: Latitude: <u>33.54967670</u> N Longitude: <u>86.80139212</u> W
Media description: <u>Dk brn silty clay with coal</u>
Aliquot #2: Latitude: <u>33.54967273</u> N Longitude: <u>86.80131342</u> W
Media description: <u>Same as D1</u>
Aliquot #3: Latitude: <u>33.54981025</u> N Longitude: <u>86.80135586</u> W
Media description: <u>Same as D1</u>
Aliquot #4: Latitude: <u>33.54992437</u> N Longitude: <u>86.80138243</u> W
Media description: <u>Same as D1</u>
Aliquot #5: Latitude: <u>33.54993531</u> N Longitude: <u>86.80131981</u> W
Media description: <u>Same as D1</u>



(b) (6)

ADDRESS:

PROPERTY ID: CV1081

DATE: 5/22/13

ARRIVAL TIME: 1336

Other pertinent information (weather conditions, etc.):

~86°F + cloudy

PROPERTY COMMENTS:

Empty lot with thick vegetation.

Grid for property sketch

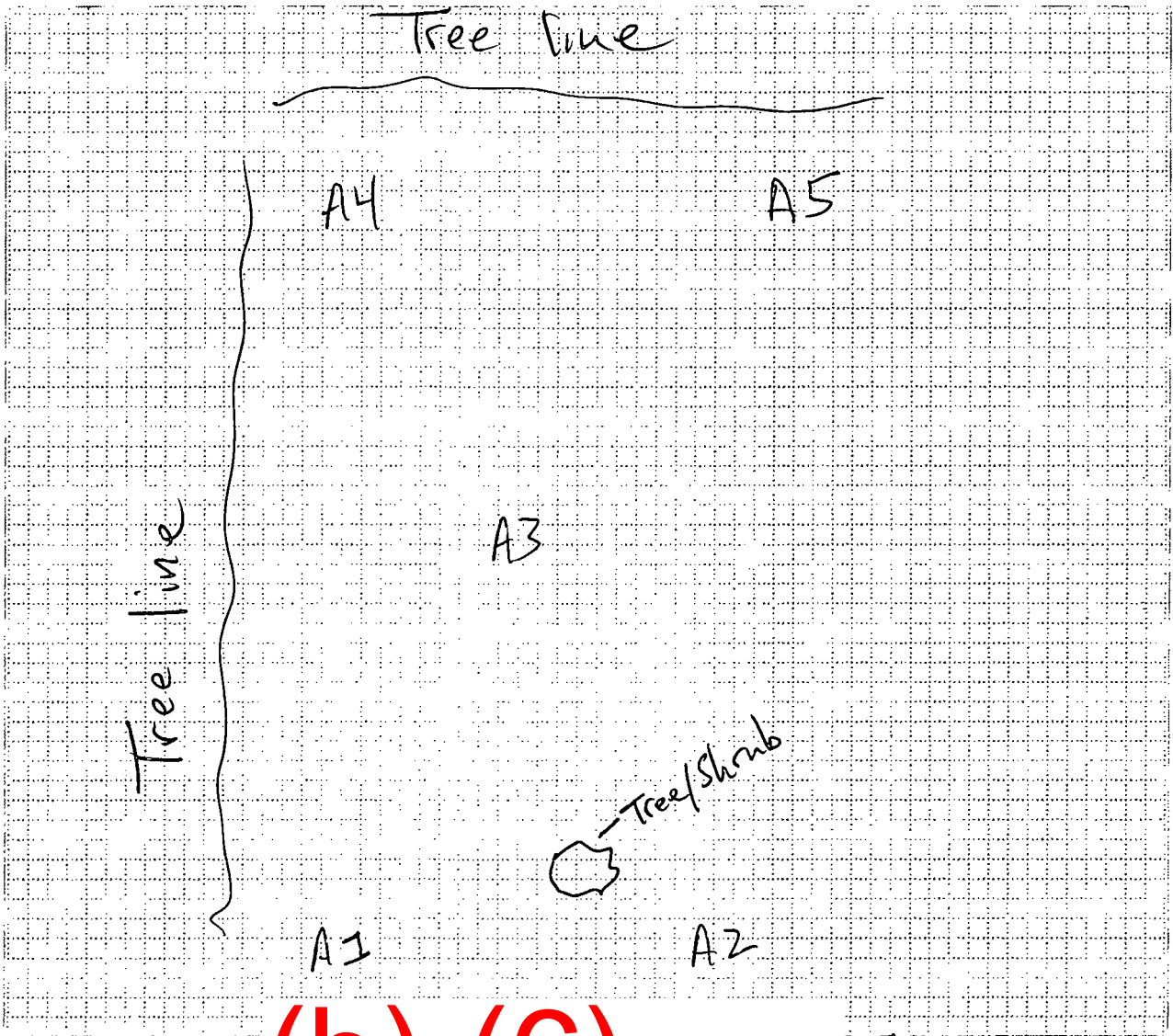

(b) (6)

STATION ID: CV1081A SAMPLE ID: CV1081A-CS

SAMPLE COLLECTION TIME: 1350

Description of sample location (front, back, side yard; vegetable garden; play set; ditch, etc):

Collection: Composite or Grab MS/MSD? Y or N

Field Duplicate or Split: Yes or No If yes, indicate Duplicate/split sample station ID: \_\_\_\_\_

GPS Coordinates: Trimble <input checked="" type="checkbox"/>	Instrument #: <u>02068</u>	Logged? <input checked="" type="checkbox"/>	Y or N
Aliquot #1: Latitude: <u>33.55015927</u>	N Longitude: <u>86.79999561</u>		W
Media description: <u>Dk brn silty clay with coal</u>			
Aliquot #2: Latitude: <u>33.55014215</u>	N Longitude: <u>86.80008663</u>		W
Media description: <u>Same as A1</u>			
Aliquot #3: Latitude: <u>33.55007039</u>	N Longitude: <u>86.80004294</u>		W
Media description: <u>Same as A1</u>			
Aliquot #4: Latitude: <u>33.54999733</u>	N Longitude: <u>86.80002277</u>		W
Media description: <u>Same as A1</u>			
Aliquot #5: Latitude: <u>33.54998771</u>	N Longitude: <u>86.80009192</u>		W
Media description: <u>Same as A1</u>			

STATION ID: \_\_\_\_\_ SAMPLE ID: \_\_\_\_\_

SAMPLE COLLECTION TIME: \_\_\_\_\_

Description of sample location (front, back, side yard; vegetable garden; play set; ditch, etc):

Collection: Composite or Grab MS/MSD? Y or N

Field Duplicate or Split: Yes or No If yes, indicate Duplicate/split sample station ID: \_\_\_\_\_

GPS Coordinates: Trimble [ ]	Instrument #: _____	Logged? Y or N
Aliquot #1: Latitude: _____	N Longitude: _____	W
Media description: _____		
Aliquot #2: Latitude: _____	N Longitude: _____	W
Media description: _____		
Aliquot #3: Latitude: _____	N Longitude: _____	W
Media description: _____		
Aliquot #4: Latitude: _____	N Longitude: _____	W
Media description: _____		
Aliquot #5: Latitude: _____	N Longitude: _____	W
Media description: _____		

ADDRESS: (b) (6)

PROPERTY ID: CV1084

DATE: 5/22/13

ARRIVAL TIME: 1400

Other pertinent information (weather conditions, etc.):

~86°F + cloudy

PROPERTY COMMENTS:

Small narrow empty lot

Grid for property sketch

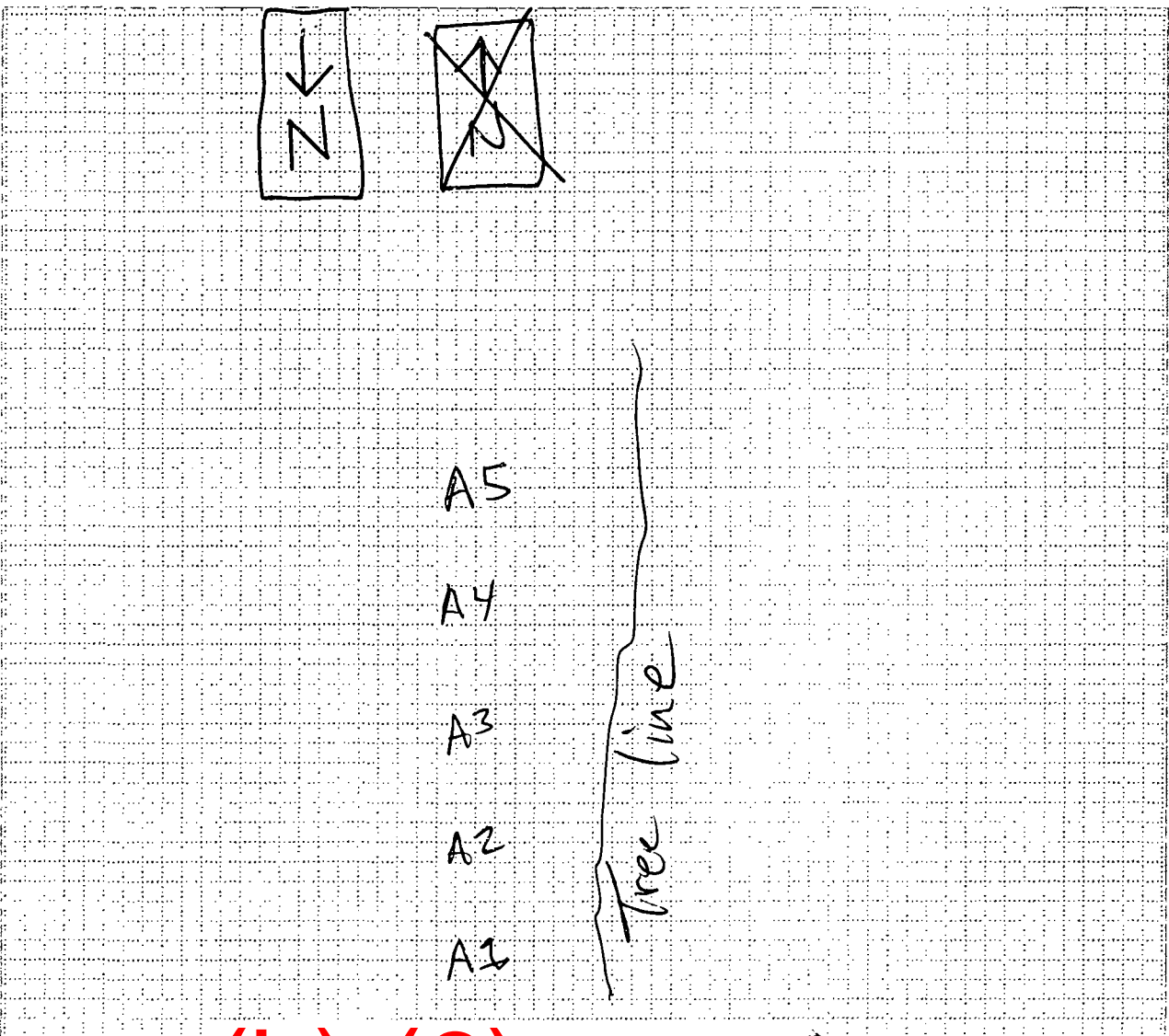

(b) (6)

STATION ID: CV1084A SAMPLE ID: CV1084A-CS

SAMPLE COLLECTION TIME: 1405

Description of sample location (front, back, side yard; vegetable garden; play set; ditch, etc):  
Down the center of the lot

Collection: Composite or Grab MS/MSD? Y or N

Field Duplicate or Split: No If yes, indicate Duplicate/split sample station ID: \_\_\_\_\_

GPS Coordinates: Trimble <input checked="" type="checkbox"/>	Instrument #: <u>820168</u>	Logged? <input checked="" type="checkbox"/>	Y or N
Aliquot #1: Latitude: <u>33.55009959</u>	N Longitude: <u>86.79979249</u>		W
Media description: <u>Lt. brn + orange silty clay with coal</u>			
Aliquot #2: Latitude: <u>33.55007466</u>	N Longitude: <u>86.79985231</u>		W
Media description: <u>Same as A1</u>			
Aliquot #3: Latitude: <u>33.55005860</u>	N Longitude: <u>86.79983898</u>		W
Media description: <u>Same as A1</u>			
Aliquot #4: Latitude: <u>33.55002921</u>	N Longitude: <u>86.79983886</u>		W
Media description: <u>Same as A2</u>			
Aliquot #5: Latitude: <u>33.54998509</u>	N Longitude: <u>86.79985500</u>		W
Media description: <u>Dk brn silty clay</u>			

STATION ID: \_\_\_\_\_ SAMPLE ID: \_\_\_\_\_

SAMPLE COLLECTION TIME: \_\_\_\_\_

Description of sample location (front, back, side yard; vegetable garden; play set; ditch, etc):  
\_\_\_\_\_

Collection: Composite or Grab MS/MSD? Y or N

Field Duplicate or Split: Yes or No If yes, indicate Duplicate/split sample station ID: \_\_\_\_\_

GPS Coordinates: Trimble [ ]	Instrument #: _____	Logged? Y or N
Aliquot #1: Latitude: _____	N Longitude: _____	W
Media description: _____		
Aliquot #2: Latitude: _____	N Longitude: _____	W
Media description: _____		
Aliquot #3: Latitude: _____	N Longitude: _____	W
Media description: _____		
Aliquot #4: Latitude: _____	N Longitude: _____	W
Media description: _____		
Aliquot #5: Latitude: _____	N Longitude: _____	W
Media description: _____		

(b) (6)

ADDRESS:

PROPERTY ID: CV0996

DATE: 5/22/13

ARRIVAL TIME: 1420

Other pertinent information (weather conditions, etc.):

+86°F + cloudy

PROPERTY COMMENTS:

Empty lot with thick vegetation and a tree lines on 3 sides.

Grid for property sketch

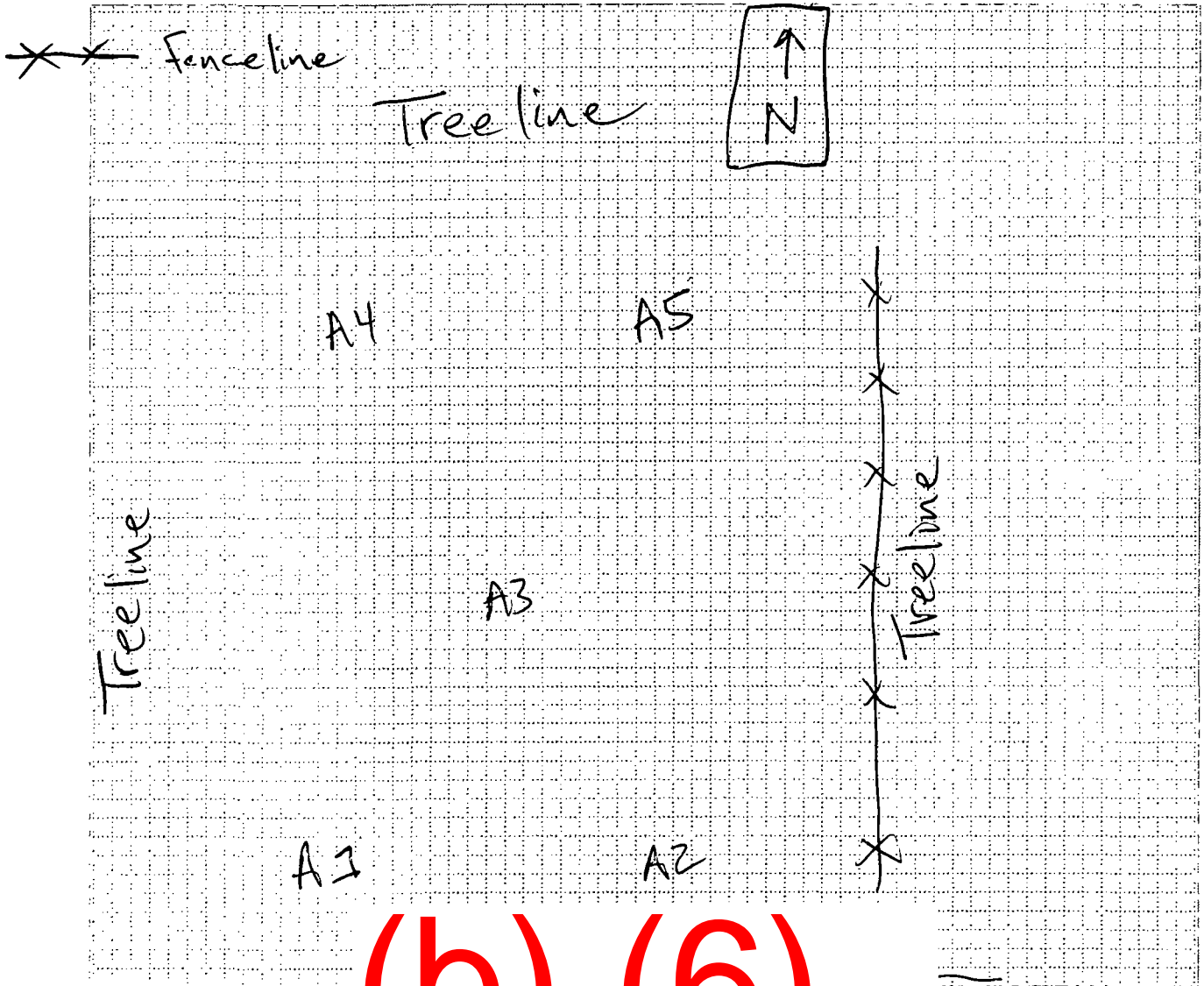

(b) (6)

STATION ID: CV0996A SAMPLE ID: CV0996A

SAMPLE COLLECTION TIME: ~~1425~~ 1425

Description of sample location (front, back, side yard; vegetable garden; play set; ditch, etc):

Collection: Composite or Grab MS/MSD? Y or N

Field Duplicate or Split: No If yes, indicate Duplicate/split sample station ID: \_\_\_\_\_

GPS Coordinates: Trimble <input checked="" type="checkbox"/> Instrument #: <u>020168</u> Logged? <input checked="" type="checkbox"/> or N
Aliquot #1: Latitude: <u>33.54965537</u> N Longitude: <u>86.80005648</u> W Media description: <u>Dk brn silty clay</u>
Aliquot #2: Latitude: <u>33.54961240</u> N Longitude: <u>86.80002076</u> W Media description: <u>Same as A1</u>
Aliquot #3: Latitude: <u>33.54972671</u> N Longitude: <u>86.80004744</u> W Media description: <u>Same as A1</u>
Aliquot #4: Latitude: <u>33.54982896</u> N Longitude: <u>86.80007822</u> W Media description: <u>Same as A1</u>
Aliquot #5: Latitude: <u>33.54982094</u> N Longitude: <u>86.80002467</u> W Media description: <u>Same as A1</u>

STATION ID: \_\_\_\_\_ SAMPLE ID: \_\_\_\_\_

SAMPLE COLLECTION TIME: \_\_\_\_\_

Description of sample location (front, back, side yard; vegetable garden; play set; ditch, etc):

Collection: Composite or Grab MS/MSD? Y or N

Field Duplicate or Split: Yes or No If yes, indicate Duplicate/split sample station ID: \_\_\_\_\_

GPS Coordinates: Trimble [ ] Instrument #: _____ Logged? Y or N
Aliquot #1: Latitude: _____ N Longitude: _____ W Media description: _____
Aliquot #2: Latitude: _____ N Longitude: _____ W Media description: _____
Aliquot #3: Latitude: _____ N Longitude: _____ W Media description: _____
Aliquot #4: Latitude: _____ N Longitude: _____ W Media description: _____
Aliquot #5: Latitude: _____ N Longitude: _____ W Media description: _____

(b) (6)

ADDRESS:

PROPERTY ID: CV1002

DATE: 5/22/13

ARRIVAL TIME: 1440

Other pertinent information (weather conditions, etc.):

~ 86°F + cloudy

PROPERTY COMMENTS:

Empty lot with tree lines to north and east.

Grid for property sketch

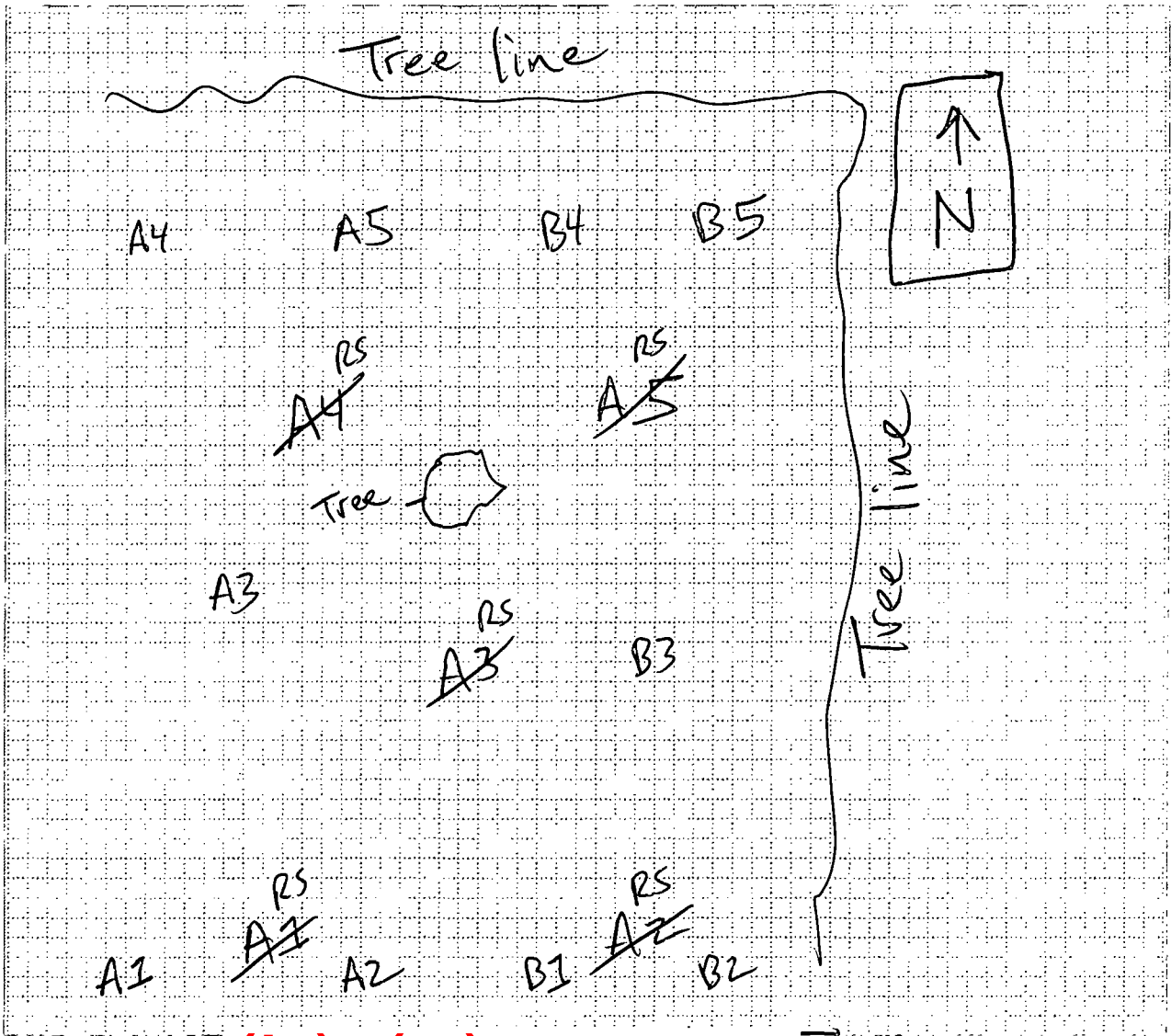

(b) (6)

STATION ID: CV1002A SAMPLE ID: CV1002A-CS

SAMPLE COLLECTION TIME: 1455

Description of sample location (front, back, side yard; vegetable garden; play set; ditch, etc):

West half

Collection: Composite or Grab

MS/MSD? Y or N

Field Duplicate or Split: Yes or No If yes, indicate Duplicate/split sample station ID: \_\_\_\_\_

GPS Coordinates: Trimble <input checked="" type="checkbox"/> Instrument #: <u>620168</u>	Logged? <input checked="" type="checkbox"/> or N
Aliquot #1: Latitude: <u>33.54961501</u>	N Longitude <u>86.79912452</u> W
Media description: <u>Brn silty clay</u>	
Aliquot #2: Latitude: <u>33.54961753</u>	N Longitude <u>86.79908176</u> W
Media description: <u>Same as A1</u>	
Aliquot #3: Latitude: <u>33.54969225</u>	N Longitude <u>86.79910408</u> W
Media description: <u>Dk brn silty clay</u>	
Aliquot #4: Latitude: <u>33.54978646</u>	N Longitude <u>86.79912192</u> W
Media description: <u>Same as A3</u>	
Aliquot #5: Latitude: <u>33.54977700</u>	N Longitude <u>86.79905343</u> W
Media description: <u>Same as A3</u>	

STATION ID: CV1002B SAMPLE ID: CV1002B

SAMPLE COLLECTION TIME: 1505

Description of sample location (front, back, side yard; vegetable garden; play set; ditch, etc):

East half

Collection: Composite or Grab

MS/MSD? Y or N

Field Duplicate or Split: Yes or No If yes, indicate Duplicate/split sample station ID: \_\_\_\_\_

GPS Coordinates: Trimble <input checked="" type="checkbox"/> Instrument #: <u>620168</u>	Logged? <input checked="" type="checkbox"/> or N
Aliquot #1: Latitude: <u>33.54962916</u>	N Longitude <u>86.79900766</u> W
Media description: <u>Brn silty clays</u>	
Aliquot #2: Latitude: <u>33.54960601</u>	N Longitude <u>86.79892633</u> W
Media description: <u>Same as B1</u>	
Aliquot #3: Latitude: <u>33.54970008</u>	N Longitude <u>86.79895361</u> W
Media description: <u>Brn + orange silty clay with coal</u>	
Aliquot #4: Latitude: <u>33.54979399</u>	N Longitude <u>86.79901787</u> W
Media description: <u>Dk brn silty clay with coal</u>	
Aliquot #5: Latitude: <u>33.54976895</u>	N Longitude <u>86.79891463</u> W
Media description: <u>Same as B4</u>	



(b) (6)

ADDR

PROPERTY ID: CV0978

DATE: 5/23/13

ARRIVAL TIME: 0920

Other pertinent information (weather conditions, etc.):

~78°F & partly cloudy

PROPERTY COMMENTS:

Large empty ~~par~~<sup>RS</sup> lot. Splitting lot into eighths. 8 five point ~~comple~~<sup>RS</sup> composite samples. Stations CV0978A thru CV0978H. High vegetation throughout lot.

Grid for property sketch

Alley



○ - Tree

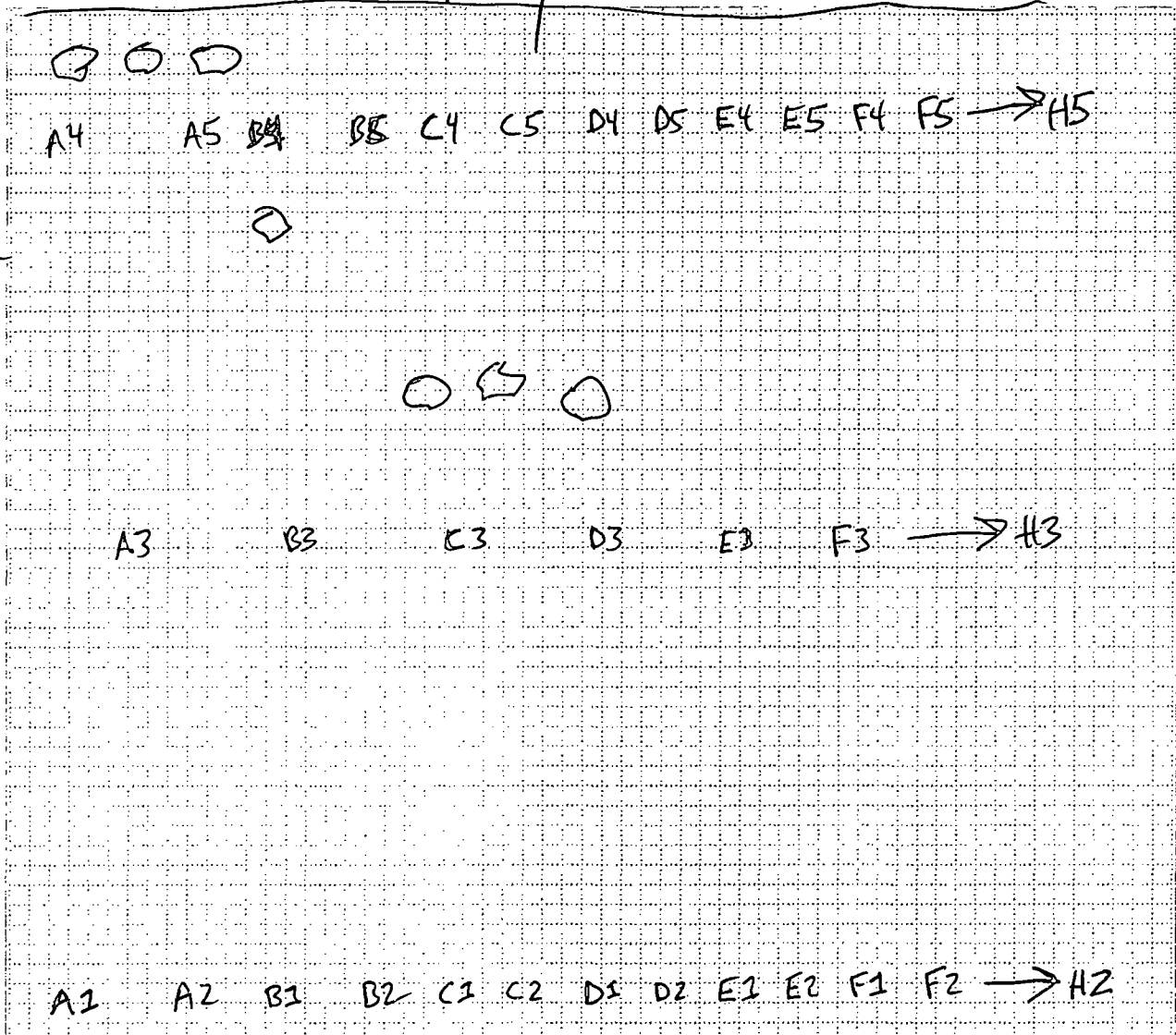

(b) (6)

STATION ID: CV0978A SAMPLE ID: CV0978A-CS

SAMPLE COLLECTION TIME: 0945

Description of sample location (front, back, side yard; vegetable garden; play set; ditch, etc):

1<sup>st</sup> eighth (from left to right) with 27<sup>th</sup> Ave N to your back.

Collection: Composite or Grab MS/MSD? Y or N

Field Duplicate or Split: Yes or No If yes, indicate Duplicate split sample station ID: CV0978A

GPS Coordinates:	Trimble <input checked="" type="checkbox"/>	Instrument #:	<u>020168</u>	Logged?	<input checked="" type="checkbox"/>	Y or N
Aliquot #1:	Latitude:	<u>33.54976414</u>	N Longitude	<u>86.80483880</u>		W
	Media description:	<u>Dk brn silty clay with coal</u>				
Aliquot #2:	Latitude:	<u>33.54976400</u>	N Longitude	<u>86.80478405</u>		W
	Media description:	<u>Same as A1</u>				
Aliquot #3:	Latitude:	<u>33.54920199</u>	N Longitude	<u>86.80480337</u>		W
	Media description:	<u>Same as A1</u>				
Aliquot #4:	Latitude:	<u>33.55004904</u>	N Longitude	<u>86.80483527</u>		W
	Media description:	<u>Same as A1</u>				
Aliquot #5:	Latitude:	<u>33.55004661</u>	N Longitude	<u>86.80478247</u>		W
	Media description:	<u>Same as A1</u>				

STATION ID: CV0978B SAMPLE ID: CV0978B-CS

SAMPLE COLLECTION TIME: 1000

Description of sample location (front, back, side yard; vegetable garden; play set; ditch, etc):

2<sup>nd</sup> eighth

Collection: Composite or Grab MS/MSD? Y or N

Field Duplicate or Split: Yes or No If yes, indicate Duplicate split sample station ID: CV0978B

GPS Coordinates:	Trimble <input checked="" type="checkbox"/>	Instrument #:	<u>020168</u>	Logged?	<input checked="" type="checkbox"/>	Y or N
Aliquot #1:	Latitude:	<u>33.54976346</u>	N Longitude	<u>86.80472138</u>		W
	Media description:	<u>Dk brn silty clay with coal + slag</u>				
Aliquot #2:	Latitude:	<u>33.54976120</u>	N Longitude	<u>86.80466035</u>		W
	Media description:	<u>Same as B1</u>				
Aliquot #3:	Latitude:	<u>33.54988659</u>	N Longitude	<u>86.80468698</u>		W
	Media description:	<u>Dk brn silty sand with coal</u>				
Aliquot #4:	Latitude:	<u>33.55003484</u>	N Longitude	<u>86.80471490</u>		W
	Media description:	<u>Same as B3</u>				
Aliquot #5:	Latitude:	<u>33.55003247</u>	N Longitude	<u>86.80464728</u>		W
	Media description:	<u>Same as B3</u>				

ADDRESS: **(b) (6)**

PROPERTY ID: CV0978

DATE: 5/23/13

ARRIVAL TIME: 0920

Other pertinent information (weather conditions, etc.):

~ 78° F + partly cloudy

PROPERTY COMMENTS:

See comments on Page 42.

Grid for property sketch

See sketch on Page 42.

STATION ID: CV0978C SAMPLE ID: CV0978C-CS

SAMPLE COLLECTION TIME: 1015

Description of sample location (front, back, side yard; vegetable garden; play set; ditch, etc):

3<sup>rd</sup> Eighth

Collection: Composite or Grab MS/MSD? Y or N

Field Duplicate or Split: Yes or No If yes, indicate Duplicate/split sample station ID: \_\_\_\_\_

GPS Coordinates: Trimble <input checked="" type="checkbox"/> Instrument #: <u>020168</u> Logged? <input checked="" type="checkbox"/> or N
Aliquot #1: Latitude: <u>33.54975930</u> N Longitude: <u>86.80459496</u> W Media description: <u>Dk brn silty clay with coal</u>
Aliquot #2: Latitude: <u>33.54975997</u> N Longitude: <u>86.80452809</u> W Media description: <u>Same as C1</u>
Aliquot #3: Latitude: <u>33.54986907</u> N Longitude: <u>86.80454550</u> W Media description: <u>Same as C1</u>
Aliquot #4: Latitude: <u>33.55003460</u> N Longitude: <u>86.80458163</u> W Media description: <u>Same as C1</u>
Aliquot #5: Latitude: <u>33.55003261</u> N Longitude: <u>86.80451356</u> W Media description: <u>Same as C1</u>

STATION ID: CV0978D SAMPLE ID: CV0978D-CS

SAMPLE COLLECTION TIME: 1030

Description of sample location (front, back, side yard; vegetable garden; play set; ditch, etc):

4<sup>th</sup> Eighth

Collection: Composite or Grab MS/MSD? Y or N

Field Duplicate or Split: Yes or No If yes, indicate Duplicate/split sample station ID: \_\_\_\_\_

GPS Coordinates: Trimble <input checked="" type="checkbox"/> Instrument #: <u>020168</u> Logged? <input checked="" type="checkbox"/> or N
Aliquot #1: Latitude: <u>33.54976035</u> N Longitude: <u>86.80446172</u> W Media description: <u>Dk brn silty clay with coal</u>
Aliquot #2: Latitude: <u>33.54975443</u> N Longitude: <u>86.80439378</u> W Media description: <u>Same as D1</u>
Aliquot #3: Latitude: <u>33.54987966</u> N Longitude: <u>86.80441126</u> W Media description: <u>Same as D1</u>
Aliquot #4: Latitude: <u>33.55003379</u> N Longitude: <u>86.80444874</u> W Media description: <u>Blk silty clay with coal + glass</u>
Aliquot #5: Latitude: <u>33.55002732</u> N Longitude: <u>86.80437570</u> W Media description: <u>Same as D4</u>

(b) (6)

ADDRESS:

PROPERTY ID: CV10978

DATE:

5/23/13

ARRIVAL TIME:

0920

Other pertinent information (weather conditions, etc.):

~78°F + partly cloudy

PROPERTY COMMENTS:

See comments on page 42.

Grid for property sketch

See sketch on page 42.

STATION ID: CV0978E SAMPLE ID: CV0978E-CS

SAMPLE COLLECTION TIME: 1045

Description of sample location (front, back, side yard; vegetable garden; play set; ditch, etc):  
5th Eighth

Collection: Composite or Grab MS/MSD? Y or N

Field Duplicate or Split: Yes or No If yes, indicate Duplicate/split sample station ID: \_\_\_\_\_

GPS Coordinates: Trimble <input checked="" type="checkbox"/> Instrument #: <u>020168</u>	Logged? <input checked="" type="checkbox"/> or N
Aliquot #1: Latitude: <u>33.54974967</u>	N Longitude <u>86.80432842</u> W
Media description: <u>Dk brn silty clay with coal</u>	
Aliquot #2: Latitude: <u>33.54974754</u>	N Longitude <u>86.80426240</u> W
Media description: <u>Same as E1</u>	
Aliquot #3: Latitude: <u>33.54987904</u>	N Longitude <u>86.80425817</u> W
Media description: <u>Same as E1</u>	
Aliquot #4: Latitude: <u>33.55004964</u>	N Longitude <u>86.80430165</u> W
Media description: <u>Blk silty clay with coal</u>	
Aliquot #5: Latitude: <u>33.55004533</u>	N Longitude <u>86.80423515</u> W
Media description: <u>Same as E4</u>	

STATION ID: CV0978F SAMPLE ID: CV0978F-CS

SAMPLE COLLECTION TIME: 1100

Description of sample location (front, back, side yard; vegetable garden; play set; ditch, etc):  
6th Eighth

Collection: Composite or Grab MS/MSD? Y or N

Field Duplicate or Split: Yes or No If yes, indicate Duplicate/split sample station ID: \_\_\_\_\_

GPS Coordinates: Trimble <input checked="" type="checkbox"/> Instrument #: <u>020168</u>	Logged? <input checked="" type="checkbox"/> or N
Aliquot #1: Latitude: <u>33.54974416</u>	N Longitude <u>86.80419702</u> W
Media description: <u>Dk brn silty clays with coal + glass</u>	
Aliquot #2: Latitude: <u>33.54974457</u>	N Longitude <u>86.80412789</u> W
Media description: <u>Same as F1</u>	
Aliquot #3: Latitude: <u>33.54989305</u>	N Longitude <u>86.80411995</u> W
Media description: <u>Same as F1</u>	
Aliquot #4: Latitude: <u>33.55003985</u>	N Longitude <u>86.80417738</u> W
Media description: <u>Blk silty clay with coal + glass</u>	
Aliquot #5: Latitude: <u>33.55004060</u>	N Longitude <u>86.80410931</u> W
Media description: <u>Same as F4</u>	

(b) (6)

ADDRESS:

PROPERTY ID: CU0978

DATE: 5/23/13

ARRIVAL TIME: 0920

Other pertinent information (weather conditions, etc.):

~ 80°F + partly cloudy

PROPERTY COMMENTS:

See comments on page 42.

Grid for property sketch

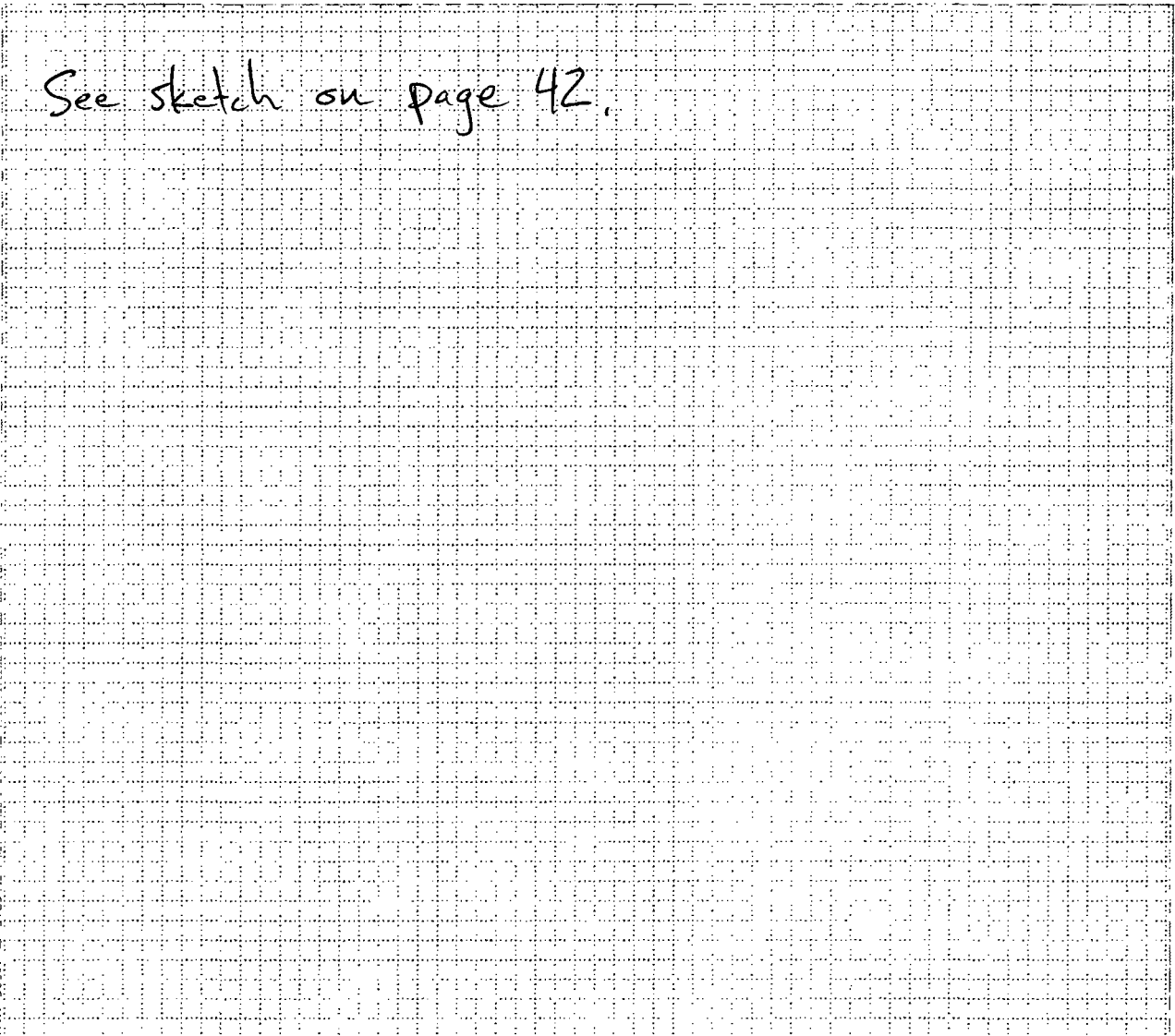

STATION ID: CV0978 G

SAMPLE ID: CV0978G-CS

SAMPLE COLLECTION TIME: 1115

Description of sample location (front, back, side yard; vegetable garden; play set; ditch, etc):

7<sup>th</sup> Eighth

Collection: Composite or Grab

MS/MSD? Y or N

Field Duplicate or Split: Yes or No If yes, indicate Duplicate/split sample station ID: \_\_\_\_\_

GPS Coordinates: Trimble <input checked="" type="checkbox"/>	Instrument #: <u>020168</u>	Logged? <input checked="" type="checkbox"/> or N
Aliquot #1: Latitude: <u>33.54974058</u>	N Longitude: <u>86.80405789</u>	W
Media description: <u>DK brn silty clay with coal</u>		
Aliquot #2: Latitude: <u>33.54973912</u>	N Longitude: <u>86.80398891</u>	W
Media description: <u>DK brn silty clay with gray sand + coal</u>		
Aliquot #3: Latitude: <u>33.54989640</u>	N Longitude: <u>86.80399491</u>	W
Media description: <u>Blk silty clay with coal</u>		
Aliquot #4: Latitude: <u>33.55003478</u>	N Longitude: <u>86.80404326</u>	W
Media description: <u>Same as G3 with gravel</u>		
Aliquot #5: Latitude: <u>33.55003659</u>	N Longitude: <u>86.80398117</u>	W
Media description: <u>Same as G3</u>		

STATION ID: CV0978 H

SAMPLE ID: CV0978H-CS

SAMPLE COLLECTION TIME: 1130

Description of sample location (front, back, side yard; vegetable garden; play set; ditch, etc):

8<sup>th</sup> Eighth

Collection: Composite or Grab

MS/MSD? Y or N

Field Duplicate or Split: Yes or No If yes, indicate Duplicate/split sample station ID: \_\_\_\_\_

GPS Coordinates: Trimble <input checked="" type="checkbox"/>	Instrument #: <u>020168</u>	Logged? <input checked="" type="checkbox"/> or N
Aliquot #1: Latitude: <u>33.54974007</u>	N Longitude: <u>86.80391585</u>	W
Media description: <u>DK brn silty clay</u>		
Aliquot #2: Latitude: <u>33.54973942</u>	N Longitude: <u>86.80385218</u>	W
Media description: <u>Same as H1</u>		
Aliquot #3: Latitude: <u>33.54989506</u>	N Longitude: <u>86.80387157</u>	W
Media description: <u>DK brn + red silty clay</u>		
Aliquot #4: Latitude: <u>33.55003541</u>	N Longitude: <u>86.80391559</u>	W
Media description: <u>Blk silty clay</u>		
Aliquot #5: Latitude: <u>33.55003432</u>	N Longitude: <u>86.80384205</u>	W
Media description: <u>Same as H4</u>		





STATION ID: CV1301A SAMPLE ID: CV1301A-CS

SAMPLE COLLECTION TIME: 1300

Description of sample location (front, back, side yard; vegetable garden; play set; ditch, etc):

West half

Collection:  Composite or Grab

MS/MSD? Y or  N

Field Duplicate or Split: Yes or  No If yes, indicate Duplicate/split sample station ID: \_\_\_\_\_

GPS Coordinates: Trimble <input checked="" type="checkbox"/>	Instrument #: <u>020168</u>	Logged? <input checked="" type="radio"/> Y or N
Aliquot #1: Latitude: <u>33.55122837</u>	N Longitude: <u>86.80050307</u>	W
Media description: <u>Brn silty clay</u>		
Aliquot #2: Latitude: <u>33.55114598</u>	N Longitude: <u>86.80049317</u>	W
Media description: <u>Dk brn silty clay</u>		
Aliquot #3: Latitude: <u>33.55118873</u>	N Longitude: <u>86.80042995</u>	W
Media description: <u>Orange clay</u>		
Aliquot #4: Latitude: <u>Same as 1</u>	N Longitude: <u>86.80038258</u>	W
Media description: <u>33.55123025</u>		
Aliquot #5: Latitude: <u>33.55115418</u>	N Longitude: <u>86.80038030</u>	W
Media description: <u>Orange clay</u>		

STATION ID: CV1301B SAMPLE ID: CV1301B-CS

SAMPLE COLLECTION TIME: 1310

Description of sample location (front, back, side yard; vegetable garden; play set; ditch, etc):

East half

Collection:  Composite or Grab

MS/MSD? Y or  N

Field Duplicate or Split: Yes or  No If yes, indicate Duplicate/split sample station ID: \_\_\_\_\_

GPS Coordinates: Trimble <input checked="" type="checkbox"/>	Instrument #: <u>020168</u>	Logged? <input checked="" type="radio"/> Y or N
Aliquot #1: Latitude: <u>33.55122839</u>	N Longitude: <u>86.80031425</u>	W
Media description: <u>Lt brn silty clay</u>		
Aliquot #2: Latitude: <u>33.55113249</u>	N Longitude: <u>86.80030085</u>	W
Media description: <u>Dk brn silty clay</u>		
Aliquot #3: Latitude: <u>33.55117815</u>	N Longitude: <u>86.80018673</u>	W
Media description: <u>Same as B2</u>		
Aliquot #4: Latitude: <u>33.55123850</u>	N Longitude: <u>86.80006220</u>	W
Media description: <u>Same as B2</u>		
Aliquot #5: Latitude: <u>33.55115370</u>	N Longitude: <u>86.80004500</u>	W
Media description: <u>Same as B2 with coal</u>		

ADDRESS: (b) (6)

PROPERTY ID: CV1164

DATE: 5/23/13

ARRIVAL TIME: 1325

Other pertinent information (weather conditions, etc.):

~86°F + partly cloudy

PROPERTY COMMENTS:

Empty lot with treelines on the east, south + west boundaries. The lot doesn't front on a street. Three 5-point composite samples collected.

Grid for property sketch

Tree line

Tree line



Fence line with razorbarb wire

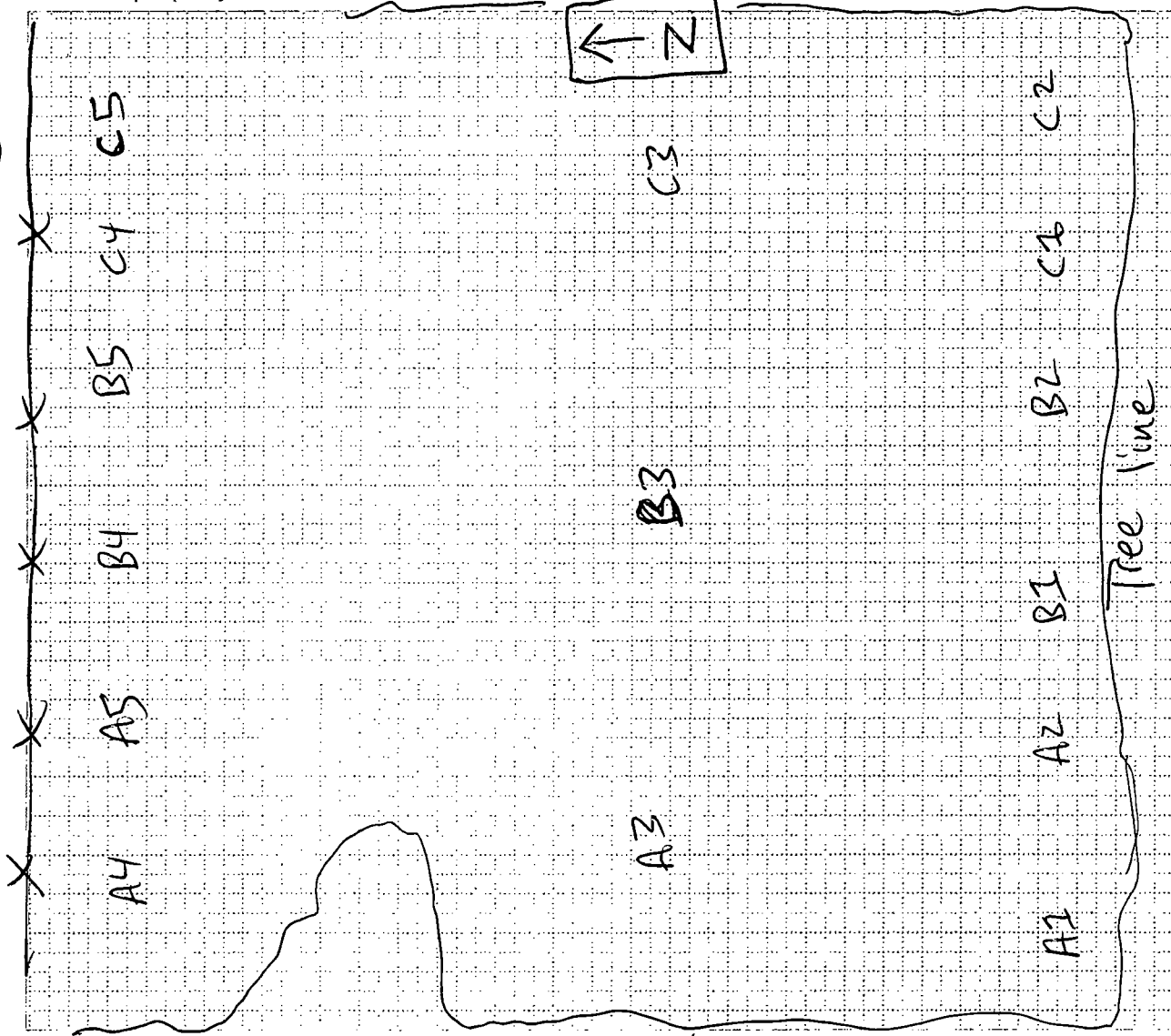

STATION ID: CV1164A SAMPLE ID: CV1164A-CS

SAMPLE COLLECTION TIME: 1335

Description of sample location (front, back, side yard; vegetable garden; play set; ditch, etc):

West third of lot

Collection: Composite or Grab

MS/MSD? Y or N

Field Duplicate or Split: Yes or No If yes, indicate Duplicate/split sample station ID: \_\_\_\_\_

GPS Coordinates: Trimble <input checked="" type="checkbox"/> Instrument #: <u>020168</u> Logged? <input checked="" type="checkbox"/> or N
Aliquot #1: Latitude: <u>33.55099460</u> N Longitude <u>86.79989812</u> W Media description: <u>Dk brn silty clay</u>
Aliquot #2: Latitude: <u>33.55100394</u> N Longitude <u>86.79984860</u> W Media description: <u>Same as A1</u>
Aliquot #3: Latitude: <u>33.55111209</u> N Longitude <u>86.79992256</u> W Media description: <u>Same as A1</u>
Aliquot #4: Latitude: <u>33.55120519</u> N Longitude <u>86.79994147</u> W Media description: <u>Same as A1</u>
Aliquot #5: Latitude: <u>33.55120241</u> N Longitude <u>86.79984251</u> W Media description: <u>Same as A1</u>

STATION ID: CV1164B SAMPLE ID: CV1164B-CS

SAMPLE COLLECTION TIME: 1345

Description of sample location (front, back, side yard; vegetable garden; play set; ditch, etc):

Middle third of lot

Collection: Composite or Grab

MS/MSD? Y or N

Field Duplicate or Split: Yes or No If yes, indicate Duplicate/split sample station ID: \_\_\_\_\_

GPS Coordinates: Trimble <input checked="" type="checkbox"/> Instrument #: <u>020168</u> Logged? <input checked="" type="checkbox"/> or N
Aliquot #1: Latitude: <u>33.55099891</u> N Longitude <u>86.79979399</u> W Media description: <u>Brn silty clay</u>
Aliquot #2: Latitude: <u>33.55099822</u> N Longitude <u>86.79972872</u> W Media description: <u>Same as B1</u>
Aliquot #3: Latitude: <u>33.55110395</u> N Longitude <u>86.79974221</u> W Media description: <u>Same as B1</u>
Aliquot #4: Latitude: <u>33.55120161</u> N Longitude <u>86.79978100</u> W Media description: <u>Same as B1 with coal</u>
Aliquot #5: Latitude: <u>33.55121405</u> N Longitude <u>86.79969562</u> W Media description: <u>Same as B1 with coal</u>

(b) (6)

ADDRESS

PROPERTY ID: CV1164

DATE: 5/23/13

ARRIVAL TIME: 1325

Other pertinent information (weather conditions, etc.):

~ 86°F + partly cloudy

PROPERTY COMMENTS:

See page 52.

Grid for property sketch

See page 52.

STATION ID: CV1164C SAMPLE ID: CV1164C-CS

SAMPLE COLLECTION TIME: 1355

Description of sample location (front, back, side yard; vegetable garden; play set; ditch, etc):  
East third of lot

Collection: Composite or Grab MS/MSD? Y or N

Field Duplicate or Split: Yes or No If yes, indicate Duplicate/split sample station ID: \_\_\_\_\_

GPS Coordinates: Trimble <input checked="" type="checkbox"/> Instrument #: <u>020168</u> Logged? <input checked="" type="checkbox"/> Y or N
Aliquot #1: Latitude: <u>33.55099546</u> N Longitude <u>86.79966308</u> W Media description: <u>Dk brn silty clay</u>
Aliquot #2: Latitude: <u>33.55099126</u> N Longitude <u>86.79960051</u> W Media description: <u>Dk brn silty clay</u>
Aliquot #3: Latitude: <u>33.55109937</u> N Longitude <u>86.79961995</u> W Media description: <u>Dk brn silty clay with orange clay</u>
Aliquot #4: Latitude: <u>33.55121118</u> N Longitude <u>86.79964668</u> W Media description: <u>Dk brn silty clay with gray sand</u>
Aliquot #5: Latitude: <u>33.55121285</u> N Longitude <u>86.79958673</u> W Media description: <u>Dk brn silty clay with coal</u>

~~STATION ID: \_\_\_\_\_ SAMPLE ID: \_\_\_\_\_~~

~~SAMPLE COLLECTION TIME: \_\_\_\_\_~~

~~Description of sample location (front, back, side yard; vegetable garden; play set; ditch, etc):  
\_\_\_\_\_~~

~~Collection: Composite or Grab MS/MSD? Y or N~~

~~Field Duplicate or Split: Yes or No If yes, indicate Duplicate/split sample station ID: \_\_\_\_\_~~

<del>GPS Coordinates: Trimble [ ] Instrument #: _____ Logged? Y or N</del>
<del>Aliquot #1: Latitude: _____ N Longitude _____ W Media description: _____</del>
<del>Aliquot #2: Latitude: _____ N Longitude _____ W Media description: _____</del>
<del>Aliquot #3: Latitude: _____ N Longitude _____ W Media description: _____</del>
<del>Aliquot #4: Latitude: _____ N Longitude _____ W Media description: _____</del>
<del>Aliquot #5: Latitude: _____ N Longitude _____ W Media description: _____</del>

(b) (6)

ADDRESS: \_\_\_\_\_

PROPERTY ID: \_\_\_\_\_

CV0315

DATE: \_\_\_\_\_

5/23/13

ARRIVAL TIME: \_\_\_\_\_

1435

Other pertinent information (weather conditions, etc.):

~ 86°F & partly cloudy

PROPERTY COMMENTS:

House on lot. Back yard is small only big enough for a 3-point composite

Grid for property sketch

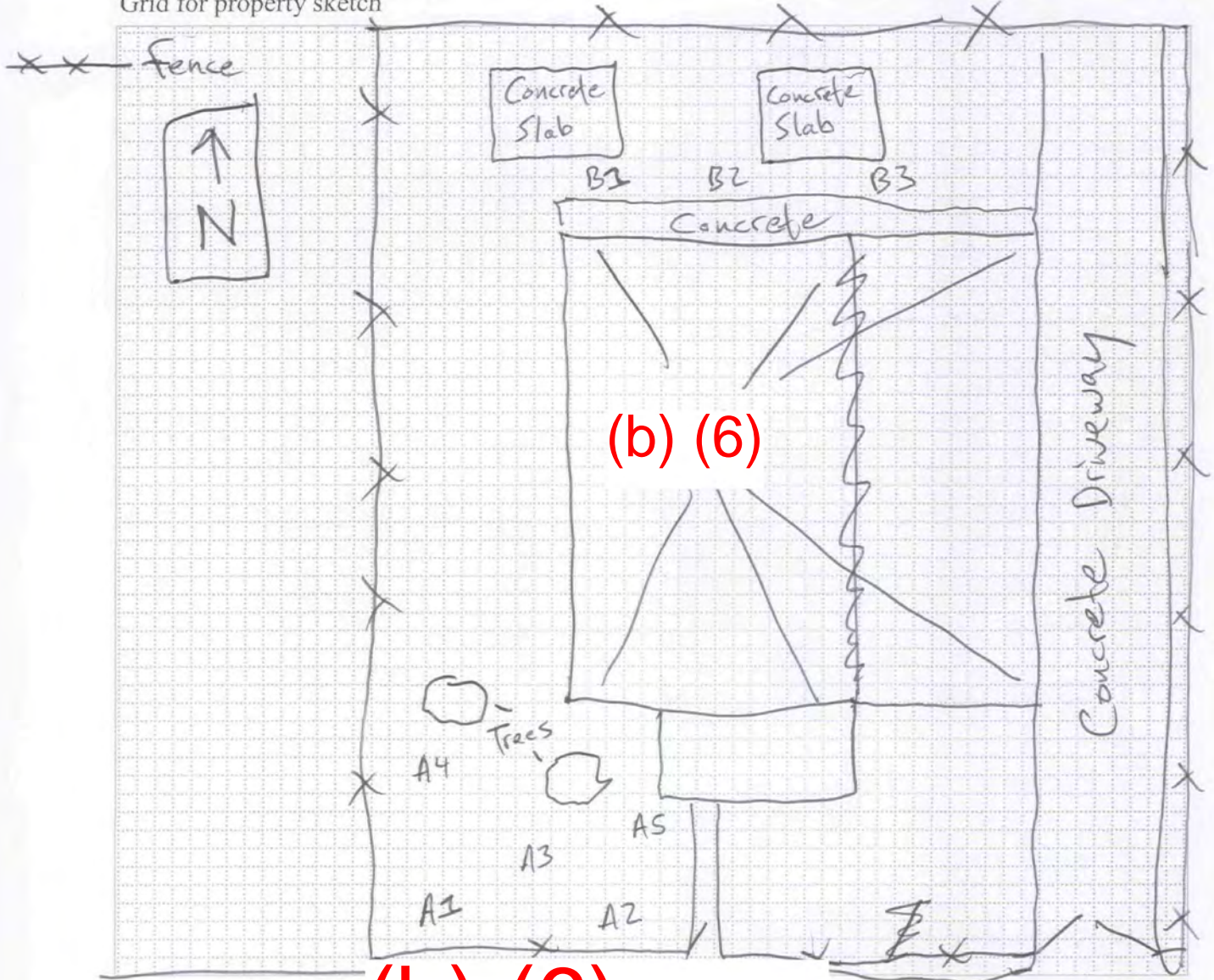

(b) (6)

STATION ID: CV0315A SAMPLE ID: CV0315A-CS

SAMPLE COLLECTION TIME: 1445

Description of sample location (front, back, side yard; vegetable garden; play set; ditch, etc):

Front yard

Collection:  Composite or Grab

MS/MSD? Y or  N

Field Duplicate or Split: Yes or  No If yes, indicate Duplicate/split sample station ID: \_\_\_\_\_

GPS Coordinates: Trimble <input checked="" type="checkbox"/> Instrument #: <u>020168</u>	Logged? <input checked="" type="radio"/> Y or N
Aliquot #1: Latitude: <u>33.55639217</u>	N Longitude: <u>86.80849150</u> W
Media description: <u>Dk brn silty clay</u>	
Aliquot #2: Latitude: <u>33.55639274</u>	N Longitude: <u>86.80841413</u> W
Media description: <u>Dk brn silty clay</u>	
Aliquot #3: Latitude: <u>33.55640838</u>	N Longitude: <u>86.80844635</u> W
Media description: <u>Brn silty clay with coal</u>	
Aliquot #4: Latitude: <u>33.55642515</u>	N Longitude: <u>86.80848316</u> W
Media description: <u>Brn silty clay</u>	
Aliquot #5: Latitude: <u>33.55642326</u>	N Longitude: <u>86.80840621</u> W
Media description: <u>Same as A3</u>	

STATION ID: CV0315B SAMPLE ID: CV0315B-CS

SAMPLE COLLECTION TIME: 1455

Description of sample location (front, back, side yard; vegetable garden; play set; ditch, etc):

Back yard (small back yard only a 3-point composite)

Collection:  Composite or Grab

MS/MSD? Y or  N

Field Duplicate or Split: Yes or  No If yes, indicate Duplicate/split sample station ID: \_\_\_\_\_

GPS Coordinates: Trimble <input checked="" type="checkbox"/> Instrument #: <u>020168</u>	Logged? <input checked="" type="radio"/> Y or N
Aliquot #1: Latitude: <u>33.55660685</u>	N Longitude: <u>86.80847186</u> W
Media description: <u>Brn sandy silt</u>	
Aliquot #2: Latitude: <u>33.55661054</u>	N Longitude: <u>86.80842472</u> W
Media description: <u>Same as B2</u>	
Aliquot #3: Latitude: <u>33.55661020</u>	N Longitude: <u>86.80838126</u> W
Media description: <u>Dk brn silty clay</u>	
<del>Aliquot #4: Latitude: _____</del>	<del>N Longitude: _____ W</del>
<del>Media description: _____</del>	
<del>Aliquot #5: Latitude: _____</del>	<del>N Longitude: _____ W</del>
<del>Media description: _____</del>	



(b) (6)

ADDRESS: \_\_\_\_\_

PROPERTY ID: \_\_\_\_\_

CV1242

DATE: \_\_\_\_\_

5/24/13

ARRIVAL TIME: \_\_\_\_\_

0815

Other pertinent information (weather conditions, etc.):

~68°F + partly cloudy

PROPERTY COMMENTS:

Empty lot with treelines on south + west.  
Lot divided into thirds for 3 five-point  
composite samples.

Grid for property sketch

W-Tree

(b) (6)

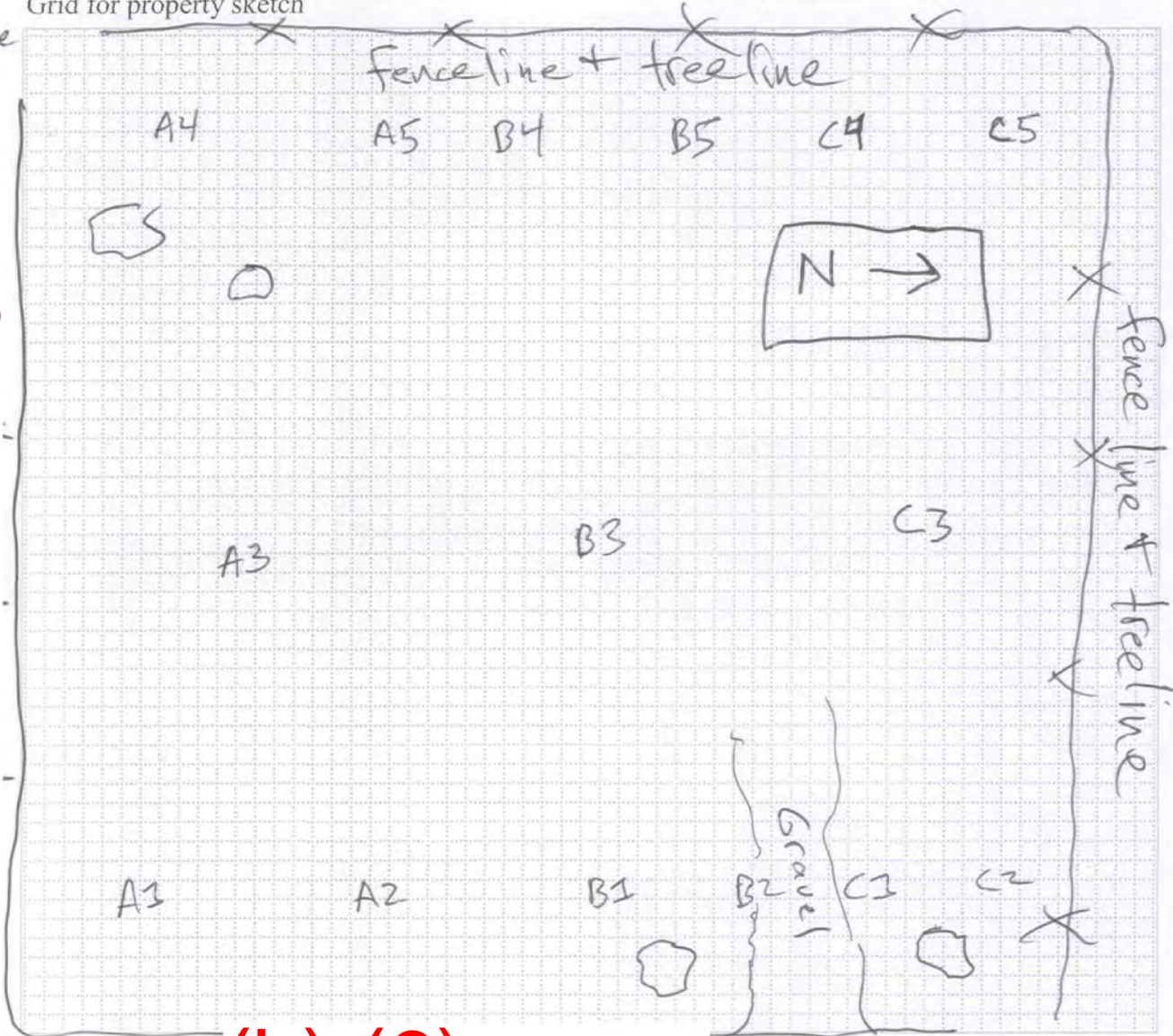

(b) (6)

STATION ID: CV1242A SAMPLE ID: CV1242A-CS

SAMPLE COLLECTION TIME: 0835

Description of sample location (front, back, side yard; vegetable garden; play set; ditch, etc):  
South third

Collection: Composite or Grab MS/MSD? Y or N

Field Duplicate or Split: Yes or No If yes, indicate Duplicate split sample station ID: CV1242A

GPS Coordinates: Trimble <input checked="" type="checkbox"/>	Instrument #: <u>020168</u>	Logged? <input checked="" type="checkbox"/>	Y or N
Aliquot #1: Latitude: <u>33.55133617</u>	N Longitude: <u>86.79847472</u>		W
Media description: <u>Dk brn silty clay</u>			
Aliquot #2: Latitude: <u>33.55133853</u>	N Longitude: <u>86.79859114</u>		W
Media description: <u>Dk brn sandy silt</u>			
Aliquot #3: Latitude: <u>33.55125687</u>	N Longitude: <u>86.79853757</u>		W
Media description: <u>Same as A1</u>			
Aliquot #4: Latitude: <u>33.55117328</u>	N Longitude: <u>86.79850214</u>		W
Media description: <u>Same as A1</u>			
Aliquot #5: Latitude: <u>33.55118571</u>	N Longitude: <u>86.79858690</u>		W
Media description: <u>Same as A1</u>			

STATION ID: CV1242B SAMPLE ID: CV1242B-CS

SAMPLE COLLECTION TIME: 0845

Description of sample location (front, back, side yard; vegetable garden; play set; ditch, etc):  
Middle third

Collection: Composite or Grab MS/MSD? Y or N

Field Duplicate or Split: Yes or No If yes, indicate Duplicate/split sample station ID: \_\_\_\_\_

GPS Coordinates: Trimble <input checked="" type="checkbox"/>	Instrument #: <u>ET15 020168</u>	Logged? <input checked="" type="checkbox"/>	Y or N
Aliquot #1: Latitude: <u>33.55134803</u>	N Longitude: <u>86.79865747</u>		W
Media description: <u>Brn sandy silt</u>			
Aliquot #2: Latitude: <u>33.55136317</u>	N Longitude: <u>86.79870538</u>		W
Media description: <u>Brn + orange silty clay</u>			
Aliquot #3: Latitude: <u>33.55126331</u>	N Longitude: <u>86.79870599</u>		W
Media description: <u>Dk brn silty clay</u>			
Aliquot #4: Latitude: <u>33.55117651</u>	N Longitude: <u>86.79867248</u>		W
Media description: <u>Same as B3</u>			
Aliquot #5: Latitude: <u>33.55117926</u>	N Longitude: <u>86.79872489</u>		W
Media description: <u>Same as B3</u>			

(b) (6)

ADDRESS: \_\_\_\_\_

PROPERTY ID: \_\_\_\_\_

CV1242

DATE: \_\_\_\_\_

5/24/13

ARRIVAL TIME: \_\_\_\_\_

0815

Other pertinent information (weather conditions, etc.):

~68°F & partly cloudy

PROPERTY COMMENTS:

See page 58.

Grid for property sketch

See page 58.

STATION ID: CV1242C SAMPLE ID: CV1242C-CS

SAMPLE COLLECTION TIME: 0855

Description of sample location (front, back, side yard; vegetable garden; play set; ditch, etc):  
North third

Collection: Composite or Grab MS/MSD? Y or N

Field Duplicate or Split: Yes or No If yes, indicate Duplicate/split sample station ID: \_\_\_\_\_

GPS Coordinates: Trimble <input checked="" type="checkbox"/>	Instrument #: <u>020168</u>	Logged? <input checked="" type="checkbox"/>	Y or N
Aliquot #1: Latitude: <u>33.55136558</u>	N Longitude: <u>86.79883408</u>		W
Media description: <u>Brn silty clay</u>			
Aliquot #2 Latitude: <u>33.55136302</u>	N Longitude: <u>86.79886178</u>		W
Media description: <u>Same as C1</u>			
Aliquot #3: Latitude: <u>33.55125931</u>	N Longitude: <u>86.79885459</u>		W
Media description: <u>Same as C1</u>			
Aliquot #4: Latitude: <u>33.55117953</u>	N Longitude: <u>86.79880026</u>		W
Media description: <u>DK brn silty clay with slag</u>			
Aliquot #5: Latitude: <u>33.55118902</u>	N Longitude: <u>86.79883960</u>		W
Media description: <u>DK brn silty clay</u>			

~~STATION ID: \_\_\_\_\_ SAMPLE ID: \_\_\_\_\_~~

~~SAMPLE COLLECTION TIME: \_\_\_\_\_~~

~~Description of sample location (front, back, side yard; vegetable garden; play set; ditch, etc):  
\_\_\_\_\_~~

~~Collection: Composite or Grab MS/MSD? Y or N~~

~~Field Duplicate or Split: Yes or No If yes, indicate Duplicate/split sample station ID: \_\_\_\_\_~~

GPS Coordinates: Trimble [ ]	Instrument #: _____	Logged? Y or N
Aliquot #1: Latitude: _____	N Longitude: _____	W
Media description: _____		
Aliquot #2 Latitude: _____	N Longitude: _____	W
Media description: _____		
Aliquot #3: Latitude: _____	N Longitude: _____	W
Media description: _____		
Aliquot #4: Latitude: _____	N Longitude: _____	W
Media description: _____		
Aliquot #5: Latitude: _____	N Longitude: _____	W
Media description: _____		

ADDRESS: \_\_\_\_\_ PROPERTY ID: \_\_\_\_\_

DATE: \_\_\_\_\_ ARRIVAL TIME: \_\_\_\_\_

Other pertinent information (weather conditions, etc.):

PROPERTY COMMENTS:  
\_\_\_\_\_  
\_\_\_\_\_  
\_\_\_\_\_  
\_\_\_\_\_

Grid for property sketch

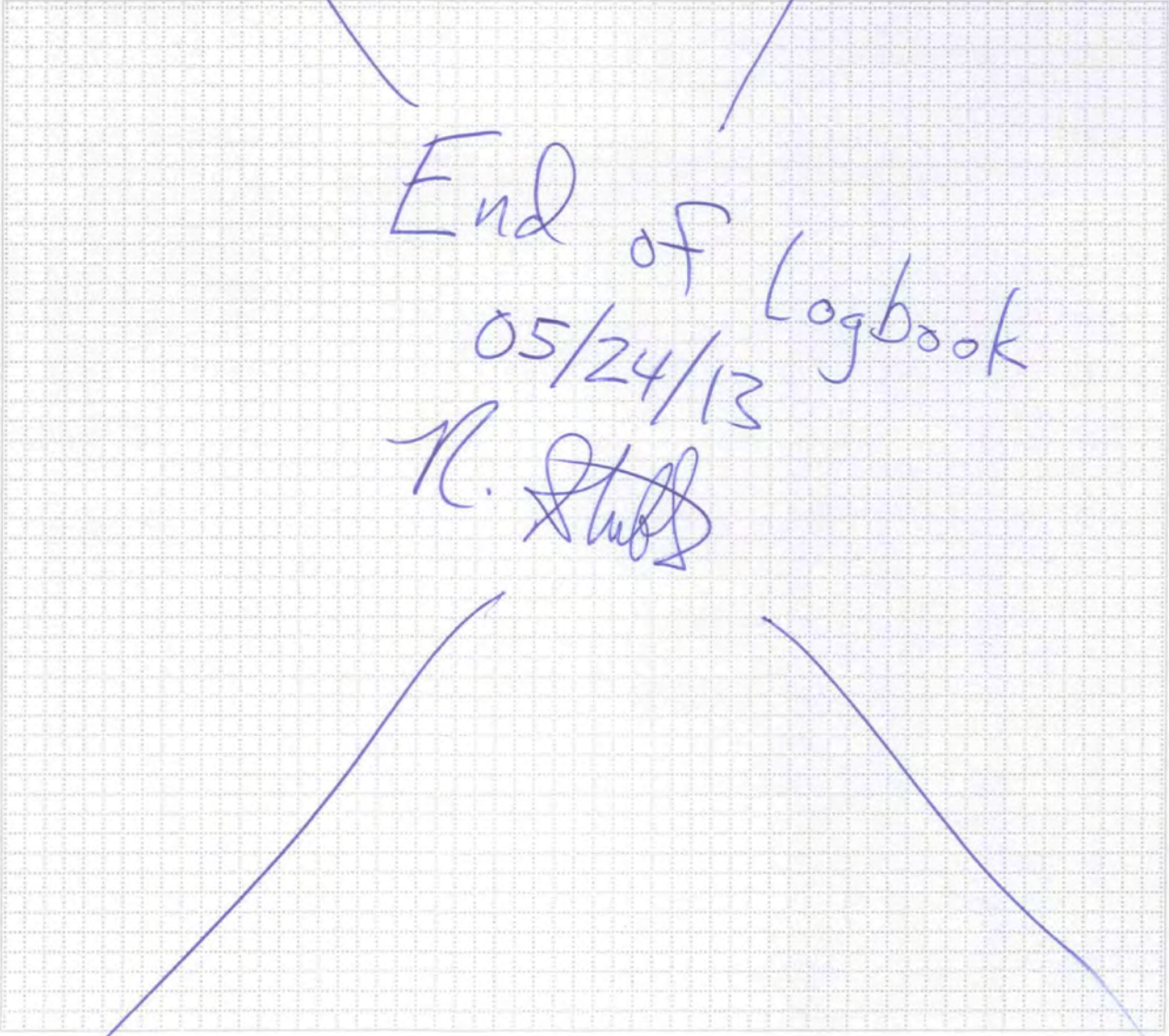

The remaining pages in this logbook are  
blank and have not been scanned.