



What is Green Infrastructure?

Tapping natural landscapes or incorporating features that mimic the ability to store, absorb, and/or cleanse stormwater runoff is collectively referred to as "Green Infrastructure."



What Does GIWiz Do?

GIWiz offers quick, direct access to Green Infrastructure tools and resources. Users can produce customized reports that include links to the resources they want to utilize.



What is the Problem?

Exploring the breadth and depth of information on all of EPA's various websites can be a daunting task. EPA's GIWiz Project is designed to simplify the process.



What is GIWiz?

GIWiz is an interactive, online information portal. It provides communities with quick and easy access to EPA's Green Infrastructure tools and resources.

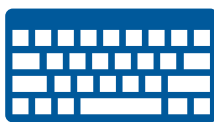

Where Do I Go?

To see GIWiz for yourself, visit:
<http://app2.epg.com/giwiz/>
Username: qa-epa
Password: erg4epa



Contacts

Bob Sachs
sachs.robert@epa.gov
202.566.2884

Mike Nye
nye.michael@epa.gov
303.312.6989



How GIWiz Works

1. Quick Links

In just two clicks, you can find a variety of green infrastructure tools and resources from a range of categories including general information, community-specific projects, and ideas for designing and assessing projects.

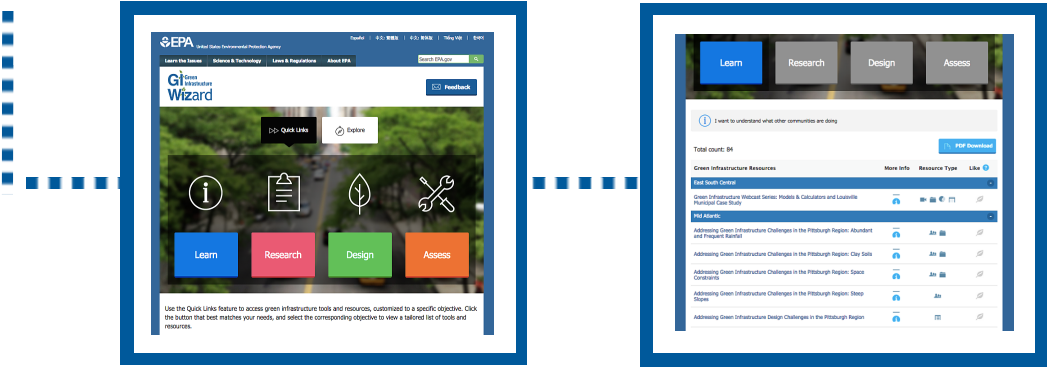

2. Explore

Choose from a variety of search filters to identify resources that meet your specific needs and interests. Results are updated in real-time, so there's no need to keep refreshing the page. In both Quick Links and Explore, you can download your favorite links in a PDF for future access.

