



AECOM  
303 E. Wacker Drive, Suite 1400  
Chicago, Illinois 60601

312-373-7700 tel  
312-373-6800 fax

July 21, 2014

Mr. Dan Martinez  
Project Manager, Lakefront Trail Improvement  
F.H. Paschen  
5515 N. East River Road  
Chicago, IL 60656

RE: Bi-weekly Letter Report Update #6  
Lakefront Trail Improvement, Chicago, IL  
AECOM Project No. 60318016

Dear Mr. Martinez:

Pursuant to conditions specified in permits issued by the City of Chicago, radiation monitoring was required to be performed for the above referenced project. AECOM Technical Services, Inc. (AECOM) provided the required radiation surveillance. The last update was issued on July 7, 2014 and summarized the surveying of excavation work performed between June 16 and July 3, 2014. This update letter provides a summary of the radiological surveying performed between July 7 and July 18, 2014.

Gamma radiation count measurements were made using Ludlum Model 2221 survey meter and an unshielded 2 x 2 inch NaI probe (Model 44-10). The U. S. Environmental Protection Agency (USEPA) cleanup value for Chicago's Streeterville area is 7.1 picocuries per gram (pCi/g) total radium (Ra-226 + Ra-228). The field instrument (Serial #172039) gamma count equivalent to 7.1 pCi/g was 19,598 counts per minute (cpm) unshielded. No excavation activities requiring monitoring were conducted the week of July 7, 2014. Monitoring the week of July 11, 2014, revealed no gamma readings indicative of contaminated fill soil above the clean-up value established by the USEPA for the Streeterville area of Chicago.

#### **New Sewer (Grand Avenue)**

On July 16 and 17, 2014, excavation of a trench for the installation of a new sewer line was performed within Grand Avenue at Lake Shore Drive. For the instrument used, the gamma count threshold equivalent to the USEPA cleanup value of 7.1 pCi/g is 19,958 (cpm) unshielded. The field gamma background for the area is approximately 5,000 cpm unshielded. The field gamma measurements within the excavation and the spoil materials generated during the excavation process did not exceed the instrument threshold previously stated. A range of readings between 3,000 and 9,200 cpm unshielded were recorded during the excavation. Thus, there was no indication of the presence of radiologically-contaminated material and/or an exceedance of the USEPA cleanup value of 7.1 pCi/g total radium.

Please contact us with any questions you have regarding this letter or the reported results.

Regards,

Steve T. Newlin  
Senior Project Geologist

Steven C. Kornder, Ph.D.  
Senior Project Geoscientist

cc: Chris Tryka, F.H. Paschen

Attachments: Location Map

## LOCATION MAP

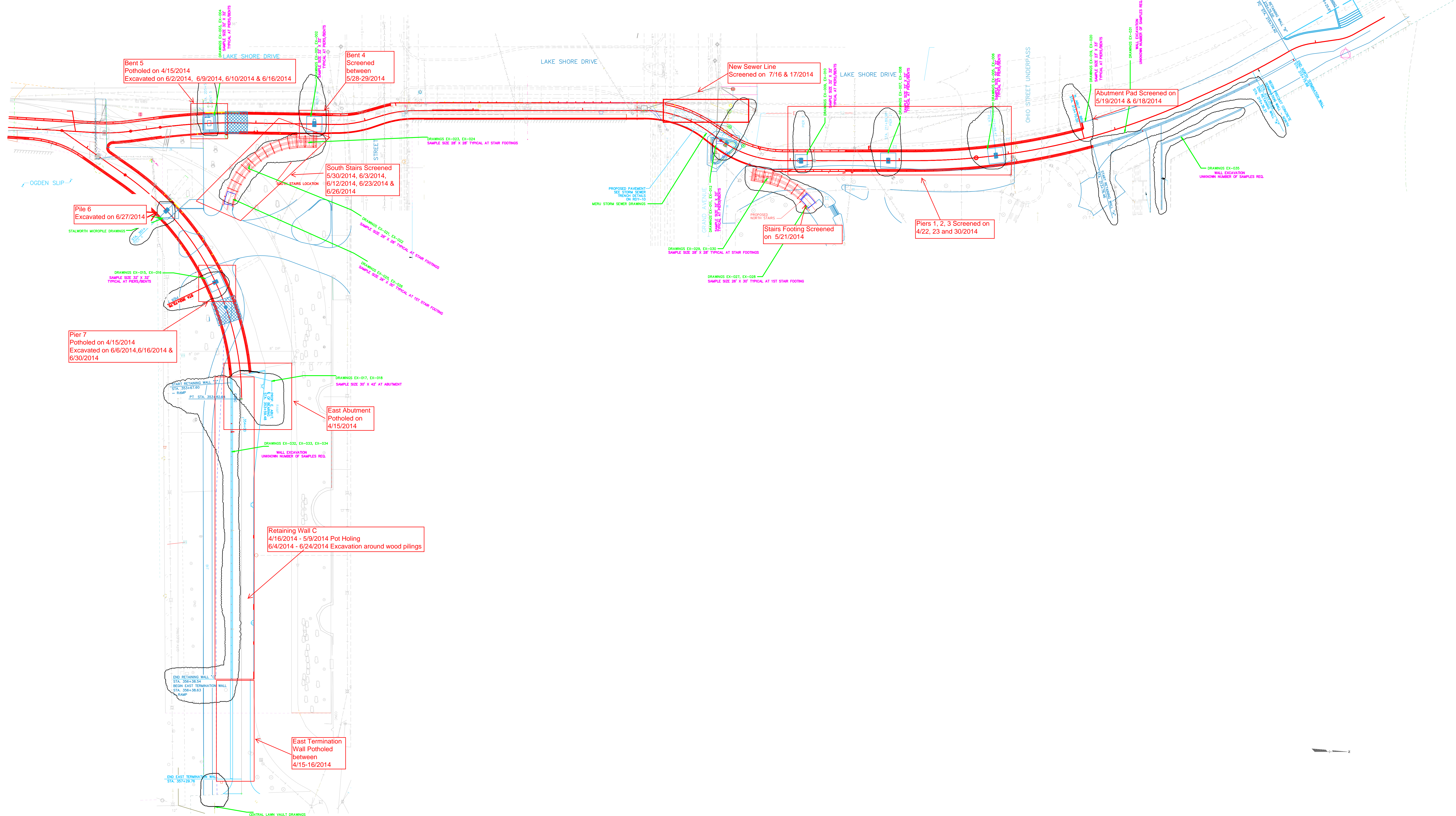

LAKEFRONT TRAIL IMPROVEMENT  
FROM JANE ADDAMS PARK  
TO OGDEN SLIP

OVERALL PROJECT PLAN  
AECOM EXCAVATION PITS

REVISIONS			
NO.	BY	DATE	DESCRIPTION

	<b>F.H. PASCHEN, S.N. NIELSEN &amp; ASSOCIATES LLC</b> GENERAL CONTRACTORS	
	DATE: 11/11/2013	SCALE: N.T.S.
DRAWING: G-001		