



AECOM  
303 E. Wacker Drive, Suite 900  
Chicago, Illinois 60601

312-938-0300 tel  
312-938-1109 fax

December 23, 2011

Mr. Narendra Prasad  
People's Gas Light & Coke Co.  
Environmental Services Department  
130 East Randolph, 22nd Floor  
Chicago, IL 60601

RE: Radiological Survey of Right-of-Way Utility Excavation  
Permit No.: 172966293  
Permit Address: 2525 South Martin Luther King Dr  
AECOM Project No. 60157647

Dear Mr. Prasad:

Pursuant to conditions specified in a permit (see attached) issued by the City of Chicago, radiation monitoring was required to be performed at the above referenced site. AECOM Technical Services, Inc. (AECOM) provided the required radiation surveillance on December 15, 2011 for the installation of an anode on existing gas service piping.

Surveying was performed for the soil removed from a 4 by 4-foot excavation to a depth of 5-feet required for the installation of the anode protection on the existing gas service piping. The USEPA threshold to temporarily be used for this area is 5 picocuries per gram (pCi/g total radium (Ra-226 + Ra-228) since total radium background and cleanup values have not yet been established for this area.

Gamma radiation count measurements for the project were made using Ludlum Model 2221 survey meter and an unshielded 2 x 2 NaI probe (Model 44-10). For the instrument used, the gamma count indicative of the 5 pCi/g threshold was 14,622 counts per minute (cpm) unshielded (5,435 cpm shielded). The field instrumentation gamma background for the surrounding area outside of the excavation based on multiple measurements was approximately 8,200 cpm unshielded. Twice this field instrumentation background (i.e., 16,400 cpm) was also considered as a potential conservative indicator of potential contamination based on discussions with the USEPA.

The excavation monitoring revealed no indication of soils above either the 5 pCi/g or twice the area background for the field instrumentation. The field gamma measurements within the excavation and of the spoil materials generated during the excavation process did not exceed these respective threshold values and ranged from a minimum of 5,500 cpm to a maximum of 7,500 cpm unshielded. Thus, there was no indication of the presence of radiologically contaminated material and/or an exceedance of the USEPA 5 pCi/g total radium value or twice the site specific background.

As part of the permit conditions this letter has been forwarded to:

Chicago Department of Environment  
Attention: Ms. Rahmat Begum  
30 North LaSalle Street, 2<sup>nd</sup> Floor  
Chicago, Illinois 60602

Radiological Survey of Right-of-Way Utility Excavation  
Permit No.: 172966293  
Page 2

Please contact us with any questions you have regarding this letter or the reported results.

Regards,



Joshua J. Rowe  
Project Scientist II



Steven C. Kornder, Ph.D.  
Senior Project Geoscientist

cc: Rahmat Begum, Chicago Department of Environment  
Verneta Simon, USEPA

Attachments: Permit  
Sketch

**Permit # 172966293**

**AMENDED**



Received Date: Aug 17, 2011 4:53:42

**PEOPLES GAS LIGHT & COKE CO  
130 EAST RANDOLPH  
DRIVE  
CHICAGO, IL 60601**

**City of Chicago  
Department of Transportation  
(312) 744-4652**

**NIELSEN,RACHEL E 773-542-7830**

**ACTIVITY HOURS**  
See RESTRICTIONS for permitted hours  
**DATES**  
Oct 24, 2011 through Dec 31, 2011

**ACTIVITIES**

**Street Opening** **Dig #: TBD**  
**(Sidewalk, Parkway, Curb Lane & Traffic Lane):**

There will be 1 opening(s) in the public way for the purpose: CUAN DIG.  
5 Feet x 3 Feet x 3 Feet

Excavation may commence on - NO SOONER.  
2525 - 2527 S DR MARTIN LUTHER KING JR DR  
CNTR: MEADE ELECTRIC<20935>CORR WORK

The above referenced request(s) should be issued as three separate permits and include the following language:  
2525-27 S. King (172966293) ? 462 NN 26th St. and 26 WE King Dr. - DIG LOCATION GIVEN IS CLEAR OF IRRIGATION. THERE IS A LANDSCAPED MEDIAN AT THIS LOCATION. NO ENTRY TO THE LANDSCAPED MEDIAN. NOTIFY CDOT IF ANY WATER LINES, CONDUITS, IRRIGATION

**Street Opening**  
**(Sidewalk, Parkway, Curb Lane & Traffic Lane):**

**Dig #: TBD**

LINES, AND WIRES ENCOUNTERED. MAINTAIN AT LEAST 2 FEET  
CLEARANCE FROM THE MEDIAN CURB AND GUTTER.

OK TO RELEASE, PER RAHMAT BEGUM ON 10/21/11

AMENDED ON DEC 7, 2011 TO EXTEND TO DEC 31, 2011

**Restrictions:**

1. A copy of the permit must remain on-site for inspector's review.
2. Permit fees must be paid within 24 hours of the date of issuance. Failure to pay will result in you being considered in violation of the terms and agreement of the permit and subject to any applicable fine and fees as if you never attained a permit. Additionally, you will still be responsible for the cost of the original permit. Monthly billing accounts are not applicable to the 24 hour payment criteria but failure to pay the monthly bill by the due date will result in the same penalties applying.
3. All directional boring must be pre-approved by the Office of Underground Coordination.
4. All traffic control will be the responsibility of the contractor and must comply with all MUTCD standards.
5. Restore all lanes to normal operation during non-working hours.
6. Contractor must secure plating over all openings in the roadway and secure all sidewalk/parkway openings during non-working hours until such time when the road surface is restored.
7. Must use flagmen and/or arrow boards to maintain traffic operations through the work zone.
8. Contractor must notify DIGGER at 312-744-7000 no less than 48 hours (exclusive of Saturdays, Sundays and Holidays) but no more than 14 calendar days in advance of the start of the excavation or demolition, unless the excavation date was provided with the application and remains unchanged. Prior to 26 calendar days the Contractor must notify DIGGER to renew the dig date!
9. It is the Excavator's responsibility to request refreshing of marks when needed, but no longer than 28 calendar days after the last requested date.
10. Excavators requesting dig tickets are responsible for the protection of utility markings at the job site. Any markings of underground utilities utilizing utility colors, must be done by facility owners or authorized agents only.
11. When applicable, all excavation areas are to be clearly marked in safety white paint prior to calling DIGGER. White paint is not required for joint meets or emergency work.
12. Use of pneumatic equipment must not begin before 8:00 A.M. or continue after 8:00 P.M.
13. Permittee must provide a sign which identifies the telephone number and company or person performing the work. Signage may be affixed to barricades.

**Restrictions:**

14. Permanent base pavement restoration to follow within 5 days after the completion of underground work.
15. All pavements and pavement markings are to be restored in accordance with CDOT Construction Standards.
16. All street openings must be restored with concrete base to grade.
17. Work to be performed as per plans and specifications.
18. Streets recently resurfaced must be restored to proper standards (resurface to nearest 1/4 pt, see CDOT Construction Standards for further details).
19. WARNING: THIS WORKSITE(S) CONTAINS RADIOACTIVE MATERIAL. ANY QUESTIONS PERTAINING TO HANDLING OF MATERIALS, CONTACT THE DEPT. OF ENVIRONMENT AT 312-744-3152.
20. Contractors to post signs to indicate: BIKE LANE CLOSED - SHARED LANE YIELD TO BIKES.

It is also the permit holder's responsibility to restore to original condition any damage to any bikeway, including replacement pavement markings and signage. You must contact Ben Gomberg (312) 744-8093 48 hours in advance of any activity.

21. No work in or use of the public right of way is to be done when a special event is taking place. It is up to the applicant to determine if an event is scheduled. To obtain a listing of programs or events within the City of Chicago please dial 311 when you are within the City boundaries.
22. It is the responsibility of the applicant to fund Traffic Control Aides if the City deems it necessary due to heavy congestion situations.
23. Pursuit to City Ordinances 10-20-150 and 10-28-281.3 a re-inspection fee of \$100 may be assessed for each inspection conducted after the initial inspection.
24. All metal plates used for public way construction or placed within the right-of-way must indicate Ownership!

**Street Opening (Sidewalk, Parkway, Curb Lane & Traffic Lane)**

10-24-2011 - Fee Pavement Opening

CBD:	N	Cost Per EA:	\$ 372.00	CAPS:	300-84-2135-256
Tiered:	N	# Of EA:	1.00	Late charge:	\$ .00
Mora:	N			Amount:	\$ 372.00

**Total Fees: \$ 372.00**

Grand Total Fees: \$ 372.00

Affected CUAN Sites: 5, 12, 15, 21, 22, 24, 28, 29, 31, 34, 35, 41, 61, 68, 70, 71, 144, 148

### EFFECTIVE DATES OF PERMIT

Current: Oct 24, 2011 through Dec 31, 2011 ( Input date: Dec 07, 2011 2:38:02 p.m. )  
Previous: Oct 24, 2011 through Nov 15, 2011 ( Input date: Aug 18, 2011 11:01:03 a.m. )  
Previous: Aug 17, 2011 through Nov 15, 2011 ( Input date: Oct 24, 2011 11:00:57 a.m. )  
Previous: Aug 17, 2011 through Sep 16, 2011 ( Input date: Aug 17, 2011 4:53:42 p.m. )

END OF PERMIT

JOB TITLE 2525 S Martin Luther King Dr  
 JOB NO. 60157647 CALCULATION NO. \_\_\_\_\_  
 ORIGINATOR JJR DATE 12/15/11  
 REVIEWER JJR DATE 12/15/11  
 SCALE N/A SHEET NO. 1 OF 1

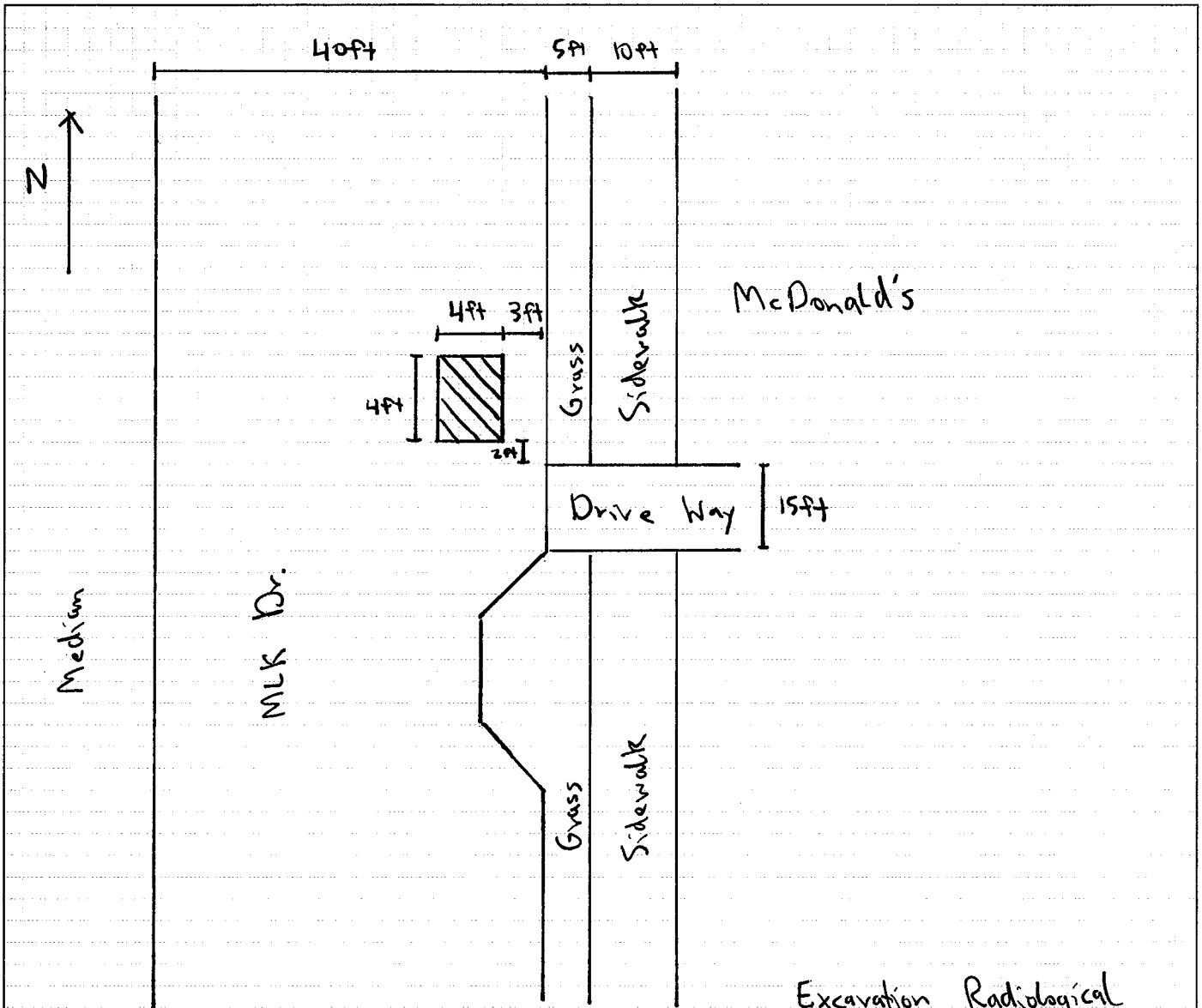

Excavation	Radiological
<u>Monitoring</u> <u>depth</u>	<u>Results</u> <u>counts per minute</u>
0-12"	Asphalt
12-24"	5400 cpm
24-36"	6400 cpm
36-48"	7500 cpm
48-60"	7300 cpm