



UNITED STATES
ENVIRONMENTAL PROTECTION AGENCY
REGION III

STATEMENT OF BASIS

World Resources Company
POTTSVILLE, PENNSYLVANIA
EPA ID # PAD981038227

Prepared by
Office of Pennsylvania Remediation
Land and Chemicals Division
August 2013

Table of Contents

Section 1: Introduction.....	1
Section 2: Facility Background.....	1
Section 3: Summary of Environmental History	2
Section 4: Environmental Indicators	2
Section 5: Public Participation.....	2
Index to Administrative Record.....	3

Section 1: Introduction

The United States Environmental Protection Agency (EPA) has prepared this Statement of Basis (SB) to solicit public comment on its proposed No Further Action (NFA) Determination for the World Resources Company (WRC) facility located at 170 Walnut Lane, Pottsville, Pennsylvania 17901 (Facility or Site). EPA's review of available information indicates that there are no unaddressed releases of hazardous waste or hazardous constituents from the Facility. Based on that assessment, EPA is proposing a NFA Determination because no further investigation or cleanup is required. EPA has determined that its proposed NFA Determination is protective of human health and the environment. This SB highlights key information relied upon by EPA in making its proposed decision.

The Facility is subject to EPA's Corrective Action Program under the Solid Waste Disposal Act, as amended by the Resource Conservation and Recovery Act (RCRA) of 1976, and the Hazardous and Solid Waste Amendments (HSWA) of 1984, 42 U.S.C. §§ 6901 et seq. (Corrective Action Program). The Corrective Action Program is designed to ensure that certain facilities subject to RCRA have investigated and cleaned up any releases of hazardous waste and hazardous constituents that have occurred at their property. The Commonwealth of Pennsylvania (Commonwealth) is not authorized for the Corrective Action Program under Section 3006 of RCRA. Therefore, EPA retains primary authority in the Commonwealth for the Corrective Action Program.

The Administrative Record (AR) for the Facility contains all documents, including data and quality assurance information, on which EPA's proposed decision is based. See Section 5, Public Participation, for information on how you may review the AR.

Section 2: Facility Background

The WRC Facility is approximately 36 acres with 9 developed acres (Developed Property) and 27 recently purchased, undeveloped acres (Undeveloped Property). It is located in Pottsville, Pennsylvania which is among mixed commercial and undeveloped wooded property. See Figure 1. The Developed Property is situated on the northeast quadrant of the Facility and is bordered by Walnut Lane to the north.

The Developed Property has a containment building of approximately 28,000 square feet and houses the production/process areas and associated equipment that includes a wastewater treatment system. See Figure 2. Located adjacent to the north side of the containment buildings is the on-site laboratory where analyses of waste material prior to arrival are performed. The administrative and office buildings are located adjacent to the northeast corner of the containment building and hold a reception area, administrative offices and conference rooms. The storage building is located on the east side of the parking area. The supply building is located adjacent to the southeast corner of the containment building and contains uniforms and general supplies. The Undeveloped Property which constitutes the majority of the Facility property is unused land that is forested or covered by grass.

The Developed Property was initially owned by the Greater Pottsville Industrial Development Corporation. In 1974 the Developed Property was developed by the Oliver Organization, which constructed a steel warehouse with adjoining offices. Argo operated a steel fabrication line at the Site, and in 1980 ceased operation. WRC leased the Developed Property in 1982 and started

Statement of Basis

operation in 1983. WRC is a recycler of metal bearing sludge's that are generated primarily by metal finishing and electroplating industries. In 1988 WRC purchased the Developed Property.

In 2012, WRC purchased the Undeveloped Property.

The Facility has had several inspections with the most recent in 2012. There was a site walkthrough with members of the Office of Pennsylvania remediation team on June 11, 2013.

Section 3: Summary of Environmental History

In 1988, WRC conducted a Phase I and Phase II Environmental Site Assessment (ESAs) at the Developed Property. During the ESAs five monitoring wells were installed at the Facility (four shallow wells and one deep well). EPA has reviewed all available groundwater monitoring results and has determined that groundwater under the Developed Property meets drinking water standards established by the Maximum Contaminant Levels (MCLs) promulgated at 40 C.F.R. Part 141 pursuant to Section 1412 of the Safe Drinking Water Act, 42 U.S.C. Section 300g-1. Soil borings were also conducted during the ESAs. Based on the sampling results, EPA has determined that soils on the Developed Property meet EPA's residential risk based standards.

In 1998, a minimal amount (below reportable quantities) of recyclable electroplating waste water treatment sludge, listed as F006, was tracked off the Developed Property's lined receiving pad by the tires of a delivery transport vehicle. The F006 material was cleaned up. WRC installed a bermed tire wash station and paved the truck entrance driveway with asphalt to prevent releases from happening again. No other known releases have occurred at the Facility requiring investigation or remedial actions.

In 2012, the Facility conducted a limited Phase II Environmental Site Assessment (2012 ESA), for the Undeveloped Property, tax parcel number 20-06-0034-000 (27 acres). EPA has reviewed the 2012 ESA and determined that there is no release of a hazardous waste or hazardous constituent resulting from historic or current operations at the Facility, at the Undeveloped Property.

WRC has conducted groundwater roughly twice a year since 1990 and soil samples roughly twice a year since 1997.

Section 4: Environmental Indicators

EPA sets national goals to measure progress toward meeting the nation's major environmental goals. For Corrective Action, EPA evaluates two key environmental indicators for each facility: (1) current human exposures under control and (2) migration of contaminated groundwater under control. The EPA has determined that the Facility met the migration of contaminated groundwater under control indicator on April 30, 2013. The EPA has determined that the Facility met the current human exposures under control indicator on April 30, 2013.

Section 5: Public Participation

Before EPA makes a final decision on its proposed NFA Determination for the Facility, the public may participate in the decision selection process by reviewing this SB and documents Statement of Basis

U.S. EPA Region III
1650 Arch Street
Philadelphia, PA 19103
Contact: Ms. Catheryn Blankenbiller
Phone: (215) 814-3464
Fax: (215) 814-3113
Email: Blankenbiller.Catheryn@epa.gov

Interested parties are encouraged to review the AR and comment on EPA's proposed NFA Determination. The public comment period will last forty-five (45) calendar days from the date that notice is published in a local newspaper. You may submit comments by mail, fax, or e-mail to Ms. Catheryn Blankenbiller. EPA will hold a public meeting to discuss this proposed decision upon request. Requests for a public meeting should be made to Ms. Catheryn Blankenbiller.

EPA will respond to all relevant comments received during the comment period. If EPA determines that new information warrants a modification to the proposed NFA Determination, EPA will modify the proposed NFA Determination or select other alternatives based on such new information and/or public comments. EPA will announce its final decision and explain the rationale for any changes in a document entitled the Final Decision and Response to Comments (FDRTC). All persons who comment on this proposed NFA Determination will receive a copy of the FDRTC. Others may obtain a copy by contacting Ms. Catheryn Blankenbiller at the address listed above.

Date:

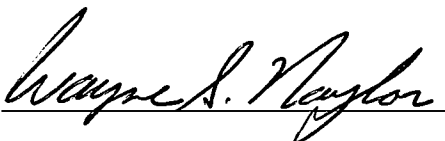
For John A. Armstead, Director
Land and Chemicals Division
US EPA, Region III

Index to Administrative Record

Phase I and Phase II Environmental Site Assessment prepared by Versar Inc, for World Resource Company, 1988.

Monitoring Well Water Analytical Report prepared by SSM laboratories for World Resources Company 1990-1991.

Monitoring Well Water Analysis Record prepared by World Resources Company 1990-2012.

Soil Analytical Report prepared by World Resources Company 1997-2012.

Monitoring Well Water Analytical Report prepared by PSC Analytical Services for World Resource Company, 2001.

Purgeables 601/602 & Semivolatiles 8270 prepared by PHILIP Analytical Services for World Resources Company, January 2001.

Statement of Basis

Documentation of Groundwater Contamination Detected prepared by World Resources Company for World Resources Company File, February 2001.

Environmental Indicator (EI) Current Human Exposures under Control, prepared by PADEP, November 2012.

Groundwater Analytical Report Prepared by GeoLabs, Inc for World Resources Company, 2011.

Environmental Indicator Inspection Report for World Resources Company, Inc., prepared by Michael J. Baker Inc., for US EPA August 2012.

Environmental Indicator (EI) Migration of Contaminated Groundwater under Control, prepared by PADEP, November 2012.

Hazardous Waste Permit No. PAD981038227 for World Resources Company March 2012.

Limited Phase II Environmental Site Assessment for Tax Parcel Number 20-06-0034-000 prepared by Gimlore & Associates, Inc for World Resources Company, May 2012.



WORLD RESOURCES
COMPANY

Source: www.pasda.psu.edu 2008

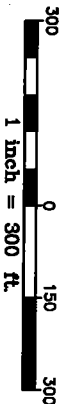

LAT=40°41'13.12"N
LON=76°13'58.72"W

SCALE: 1" = 300'
S.O. NO.: 120690
DSN/DWN:JBM/RRR

DATE:OCTOBER 2011
FILE: 120690-WR_01
CHK: SRF

Baker

MICHAEL BAKER JR., INC.
MOON TOWNSHIP, PENNSYLVANIA

FIGURE 1
FACILITY LOCATION MAP
WORLD RESOURCES COMPANY
POTTSVILLE, PENNSYLVANIA

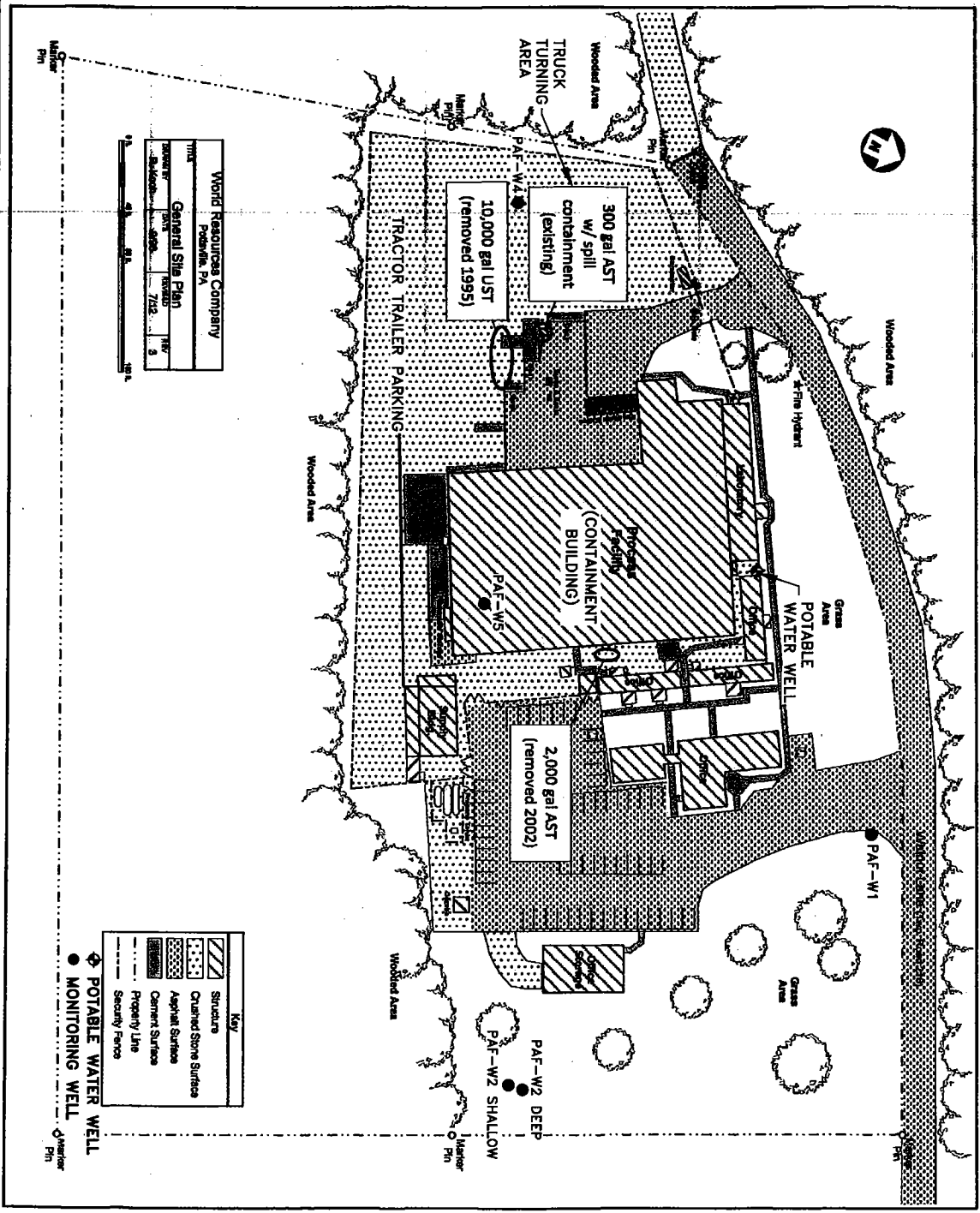

World Resources Company			
Pottsville, PA			
TITLE	General Site Plan		
DATE	DATE	DATE	REV
12/12	12/12	12/12	3

Key	
	Structure
	Crushed Stone Surface
	Asphalt Surface
	Concrete Surface
	Property Line
	Security Fence

- POTABLE WATER WELL
- MONITORING WELL

SOURCE: WRC LETTER DATED JULY 26, 2012
 EDITS IN BLUE ADDED BY BAKER

SCALE: AS SHOWN DATE: JULY 2012
 S.O. NO.: 120690 FILE: 120690-WR_04
 DSN/DWN: JBM/RRR CHK: SRF

Baker MICHAEL BAKER JR., INC.
 MOON TOWNSHIP, PENNSYLVANIA

FIGURE 2
 FACILITY LAYOUT
 WORLD RESOURCES COMPANY
 POTTSVILLE, PENNSYLVANIA