



Trust Mines Background and Site Updates

U.S. Environmental Protection Agency • Region 9 • San Francisco, CA • May 2018

The Navajo Nation negotiated with the United States to address the U.S. Atomic Energy Commission's role in developing historical uranium mining on Navajo lands. As a result, the United States and the Navajo Nation entered into two legal agreements (the Phase 1 Settlement in 2015 and the Phase 2 Settlement in 2016) that provide funds to assess and clean up 16 "priority" mines¹, assess an additional 30 mines, and conduct two water studies located on the Navajo Nation.

The settlement work is being done in two phases (i.e., Phase 1 and Phase 2). The Navajo Nation has selected Navajo trustees to manage the trust funds and do the work under the oversight of the United States Environmental Protection Agency (USEPA) and the Navajo Nation Environmental Protection Agency (NNEPA).



The Phase 1 Trust team installs guides for conducting aerial photography of a mine. High-resolution photographs provide details of the landscape, which help reveal the extent of any contamination.

Settlement Agreements

The **Phase 1 Settlement** covers detailed assessments, called Removal Site Evaluations (RSEs), at 16 "priority" mines. Phase 1 Settlement funds make up what is called the Phase 1 Trust.

The **Phase 2 Settlement** covers the detailed assessments of 30 additional mines, two water studies on the Navajo Nation, and the cleanup, as needed, at the 16 "priority" mines in the Phase 1 Settlement. This settlement has two trust funds called the Phase 2 RSE Trust and the Phase 2 Priority Orphan (PO) Trust.

Trust Mines and Trustees

Phase 1 Trust

The Phase 1 Trustee, Sadie Hoskie, is completing RSEs to show the extent of potential mine waste contamination at 16 "priority" mine sites. Trustee Hoskie is expected to complete the work in 2018. The final RSE reports will be shared with the community.

Phase 2 RSE Trust

In 2018, the Phase 2 RSE Trustee, Derrith Watchman-Moore, will conduct investigations at 13 mines in the Western AUM region and a water study at the Claim 28 mine in the Central AUM region. Trustee Watchman-Moore will assess 17 additional mines and conduct one additional water study on Navajo Nation.

Phase 2 PO Trust

The Phase 2 PO Trustee has not yet been selected. Once selected, the trustee will begin work to clean up the 16 "priority" mines, as needed, that were assessed by Trustee Hoskie.

¹USEPA and NNEPA prioritized 46 mines (called priority mines) out of the 523 on the Navajo Nation based on gamma radiation levels, proximity to homes and potential for water contamination identified in the preliminary assessments. The Trust Settlements are responsible for 16 of these 46 priority mines.

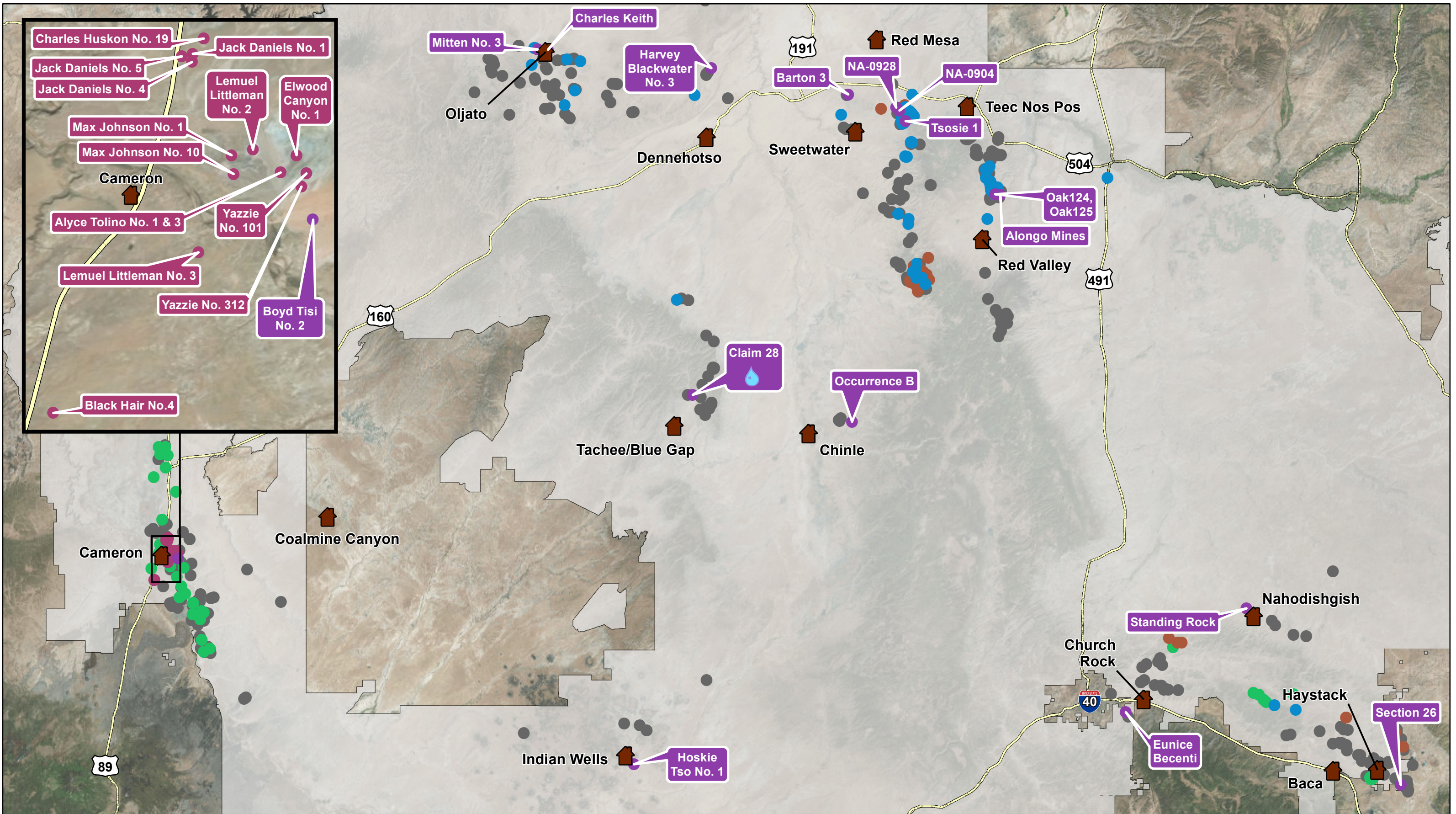

Navajo Nation - Central Abandoned Uranium Mine Region

- | | | |
|-----------------------|-------------------------|-----------------------------------|
| Nearby Chapter Houses | Phase 1 Trust Mines | Cyprus Amax/Western Nuclear Mines |
| Navajo Nation | Phase 2 RSE Trust Mines | Tronox Settlement Mines |
| All Other Mines | Phase 2 RSE Water Study | Private Companies Mines |

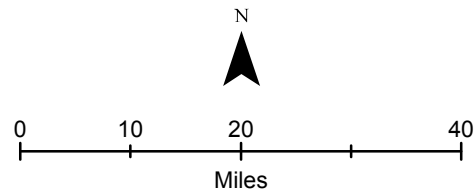

What Has Been Done?

- The Navajo Nation Abandoned Mine Lands Reclamation Program performed activities to address physical hazards at most of the mine sites in the 1990s.
- The Phase 1 Trustee completed all field work for the RSEs at the 16 “priority” mines. This included biological and cultural surveys, radiation scanning, aerial photography, and soil and water sampling.
- The Phase 1 Trustee also worked to reduce physical hazards found on sites.
- USEPA and NNEPA have reviewed data collected by the Phase 1 Trustee.

What is Happening Now?

- The Phase 1 Trustee is finalizing the RSE reports, which includes analyzing the data collected during field work.
- USEPA and NNEPA are reviewing these RSE reports and meeting with community members to explain the work and hear concerns.



Assessing soil samples at an abandoned uranium mine (NA-0928) by the Phase 1 Trust team of experts.

What Happens Next?

- In 2018, the Phase 1 Trustee will finalize the RSE reports and the results will be shared with the community. If the RSE shows that a mine poses a risk to human health and the environment, an additional study to look at options for cleaning up the mine, called Engineering Evaluation/Cost Analysis (EE/CA), will be carried out under the Phase 2 PO Trust.
- In 2018, the Phase 2 RSE Trustee will begin RSEs at 13 mines in the Western AUM region, and one water study at Claim 28 in the Central AUM region.

Superfund Process on the Navajo Nation

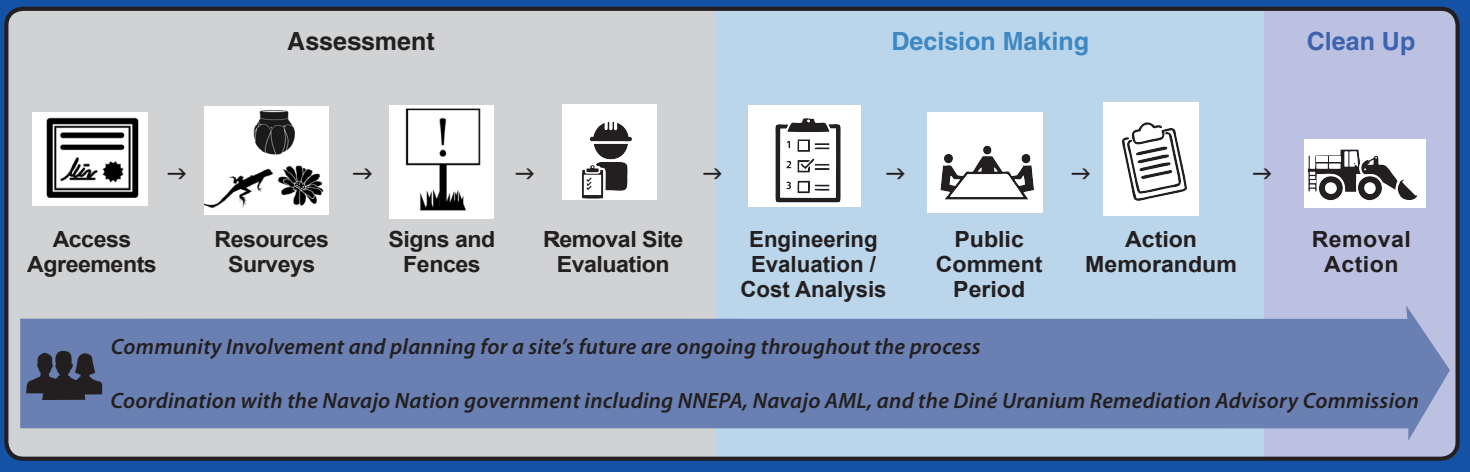

For More Information

Linda Reeves
Remedial Project Manager
(Phase 1 Trust)
USEPA Region 9
(415) 972 – 3445
reeves.linda@epa.gov

Freyja Knapp
Remedial Project Manager
(Phase 2 RSE Trust)
USEPA Region 9
(415) 972 – 3025
knapp.freyja@epa.gov

Elsa Johnson
Community Involvement
Coordinator
USEPA Region 9
(415) 947 – 3552
johnson.elsa@epa.gov

Diane Malone
Department Manager
Waste Regulatory
Compliance Department
NNEPA Superfund
(928) 871 – 7993
dmalone@navajo-nsn.gov

USEPA Trust Mines website: www.epa.gov/navajo-nation-uranium-cleanup/trust-mines