



United States Environmental Protection Agency
Washington, DC 20460

ANNUAL DISPOSAL/INJECTION WELL MONITORING REPORT

Name and Address of Existing Permittee
J.J. Bucher Prod Corp
2566 Dell Run Shinglehouse PA 16748

Name and Address of Surface Owner
VISSCAU/MESSLET
Shinglehouse PA

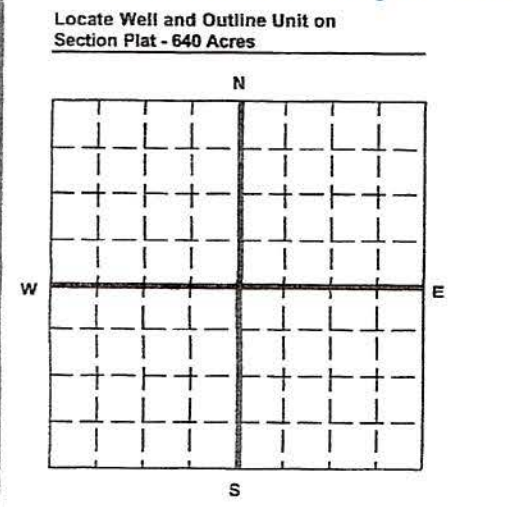

State *PA* County *Potter* Permit Number *PAS2R943APOT*

Surface Location Description
___ 1/4 of ___ 1/4 of ___ 1/4 of ___ 1/4 of Section ___ Township Range

Locate well in two directions from nearest lines of quarter section and drilling unit
Surface
Location ft. frm (N/S) ___ Line of quarter section
and ft. from (E/W) ___ Line of quarter section.

WELL ACTIVITY TYPE OF PERMIT
 Brine Disposal Individual
 Enhanced Recovery Area
 Hydrocarbon Storage Number of Wells *5*
 Lease Name *Henrich/Prince* Well Number *See attch.*

RECEIVED
EPA REGION III
JAN 30 2019
GROUND WATER & ENFORCEMENT
(3WP22)

INJECTION PRESSURE				TOTAL VOLUME INJECTED		TUBING - CASING ANNULUS PRESSURE (OPTIONAL MONITORING)	
MONTH	YEAR	AVERAGE PSIG	MAXIMUM PSIG	BBL	MCF	MINIMUM PSIG	MAXIMUM PSIG
1	18	0	0	0			
2	18	0	0	0			
3	18	0	0	0			
4	18	0	0	0			
5	18	0	0	0			
6	18	0	0	0			
7	18	0	0	0			
8	18	0	0	0			
9	18	0	0	0			
10	18	0	0	0			
11	18	0	0	0			
12	18	0	0	0			

Certification

I certify under the penalty of law that I have personally examined and am familiar with the information submitted in this document and all attachments and that, based on my inquiry of those individuals immediately responsible for obtaining the information, I believe that the information is true, accurate, and complete. I am aware that there are significant penalties for submitting false information, including the possibility of fine and imprisonment. (Ref. 40 CFR 144.32)

Name and Official Title (Please type or print) *Gregory A. Maxson Pres* Signature *Gregory A. Maxson Pres* Date Signed *1/30/19*

Total bbls = 0
 MAX PRESSURE = 052
 Compliance Review Completed
 WMS Updated
 Pdf to G: Drive on 1/17/19

J.J. Bucher Prod. Corp.
2568 Bells Run Road
Shinglehouse, Pa. 16748

PA 52R943A POT

well #

10	37-105-20603
11	37-105-20589
17	37-105-20604
18	37-105-20605
49	37-105-20606

inactive non Endangering