

You Can Get There from Here

Improving transportation accessibility to the Evans-Fintube site in Tulsa, Oklahoma

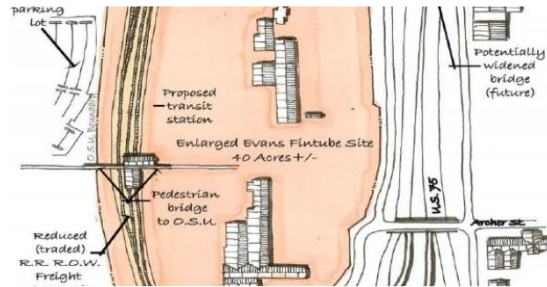

Project Summary

Community: Tulsa, Oklahoma

Technical Assistance: Site Design

Former Use: Steel Mill

Future Use: Residential/Mixed Use

Since the 1920s, the North Tulsa community has been plagued by declining populations, deteriorating infrastructure and limited services. As part of the 2012 North Tulsa Brownfields Area-Wide Plan, the city evaluated six key brownfield sites for potential redevelopment. The largest was the Evans-Fintube site, a former steel manufacturing facility.

The city of Tulsa engaged with interested developers to renovate the former steel mill into a vibrant destination consisting of mixed residential, retail, office and recreational uses. In 2020, the site will become the new home for USA-BMX and its national training center.

The Community's Challenge

A major hurdle to successful redevelopment is the lack of pedestrian and vehicular accessibility to the Evans-Fintube site. There is no direct access to Evans-Fintube from the two freeways that border the site, rendering the property difficult to market. The city needed assistance developing a transportation plan to support the envisioned redevelopment.

EPA's Land Revitalization Technical Assistance

To address the lack of accessibility, U.S. EPA's Land Revitalization Program provided contractor technical assistance to create a plan of proposed multimodal transportation improvements. EPA compiled traffic data, trail transit data, pedestrian bicycle plans, and conceptual

reuse plans among other data to produce an effective transportation strategy. The plan evaluates several key transportation recommendations for the former Evans-Fintube site, along with a discussion regarding priorities, feasibility, potential limiting conditions and next steps. These proposed changes, in conjunction with ongoing environmental remediation at the site, will not only open a critical stretch of land for redevelopment, but also improve public health and welcome new businesses to the area.

With the technical assistance, the city of Tulsa will be able to overcome transportation accessibility obstacles and make the renovation of the Evans-Fintube site more feasible.

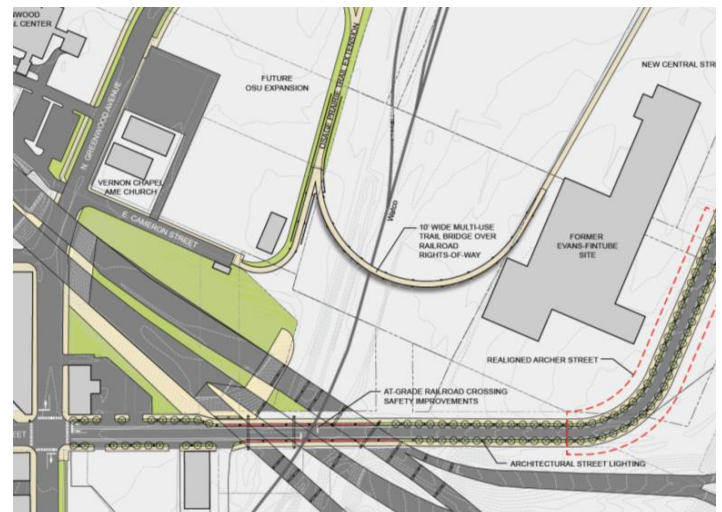

Archer Street improvements connecting the Evans-Fintube site to accessible roads.

For more information, contact Denise Williams, EPA Region 6 Brownfields Program, at williams.denise@epa.gov.