

NEW BEDFORD HARBOR
LOWER HARBOR CAD CELL
NEW BEDFORD HARBOR DEVELOPMENT COMMISSION

CONTRACT # HDC-FY12-006
SEPTEMBER 2012
NEW BEDFORD HARBOR, NEW BEDFORD, MASSACHUSETTS
FOR BIDDING PURPOSES ONLY



ROCKVILLE, MD
SOUTH WINDSOR, CT - BOSTON, MA -
NEW BEDFORD, MA - HOLYOKE, MA

125 BROAD STREET, 5TH FLOOR
BOSTON, MA 02210

58H CONNECTICUT AVENUE
SOUTH WINDSOR, CT

PROJECT
NEW BEDFORD HARBOR
DEVELOPMENT COMMISSION
LOWER HARBOR CAD CELL

OWNER
NEW BEDFORD
HARBOR DEVELOPMENT COMMISSION
52 FISHERMAN'S WHARF, NEW BEDFORD, MA 02740

NO.	DATE	DESCRIPTION	BY
PROJECT NO.		6724	
CADD FILE			
DESIGNED BY			
DRAWN BY			
CHECKED BY			
DATE		SEPTEMBER 2012	
DRAWING SCALE		AS NOTED	

GRAPHIC SCALE

SHEET TITLE

TITLE SHEET

DRAWING NO.

T-1

1 OF 14

PLOT SCALE 1/16"=1'-0"

SHEET LIST TABLE	
Sheet Number	Sheet Title
T-1	TITLE SHEET
T-2	GENERAL ARRANGEMENT PLAN - GENERAL NOTES
E-1	LOWER HARBOR CAD CELL EXISTING CONDITIONS
E-2	CAD CELL #2 EXISTING CONDITIONS
P-1	TOP OF LOWER HARBOR CAD CELL PHASE I
P-2	BOTTOM OF LOWER HARBOR CAD CELL PHASE I
P-3	TOP OF LOWER HARBOR CAD CELL PHASE II
P-4	BOTTOM OF LOWER HARBOR CAD CELL PHASE II
P-5	CAD CELL #2 DISPOSAL PLAN
P-6	LOWER HARBOR CAD CELL PHASE I DISPOSAL PLAN
P-7	LOWER HARBOR CAD CELL PHASE II DISPOSAL PLAN
C-1	LOWER HARBOR CAD CELL PHASE I CROSS SECTIONS
C-2	LOWER HARBOR CAD CELL PHASE II CROSS SECTIONS
C-3	CAD CELL #2 CROSS SECTIONS

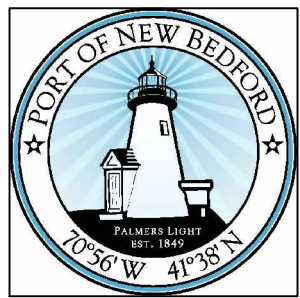

SCALE: 1"=0.5 MIL.S
0 .25 0.5 1.0 MIL.S

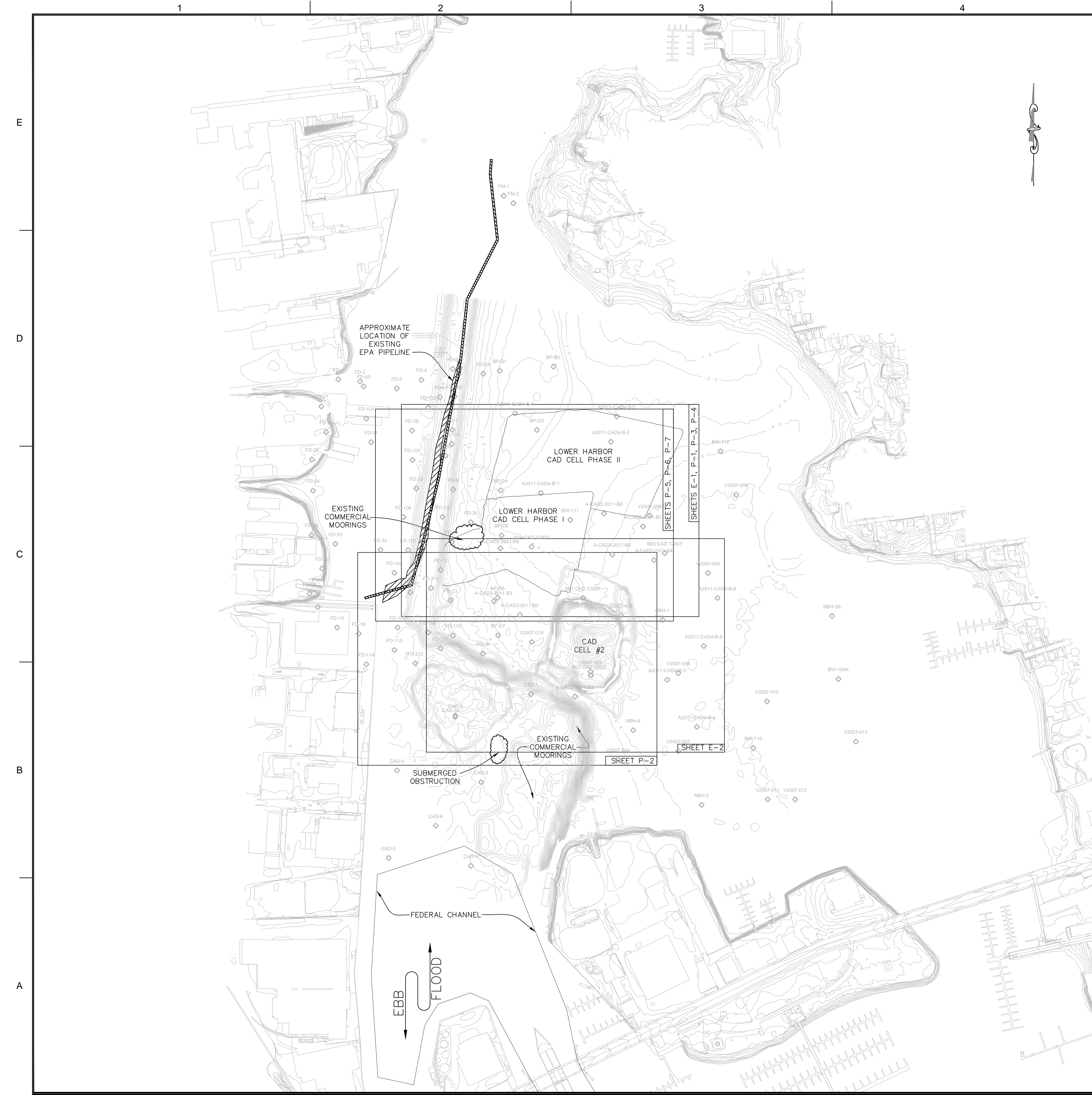

- GENERAL NOTES:
1. NOTES BELOW ARE NOT INTENDED TO REPLACE SPECIFICATIONS. SEE SPECIFICATIONS FOR REQUIREMENTS IN ADDITION TO GENERAL NOTES.
 2. A SIGNIFICANT QUANTITY OF DATA HAS BEEN COLLECTED ASSOCIATED WITH THIS PROJECT. DATA COLLECTED ASSOCIATED WITH THIS PROJECT IS CONTAINED WITHIN THE DOCUMENT ENTITLED "DATA REPORT - LOWER HARBOR CAD CELL".
 3. THE CONTRACTOR IS ADVISED THAT THE DRAWINGS AND SPECIFICATIONS FORM A PART OF THE CONTRACT DOCUMENTS. ALL WORK SHALL BE PERFORMED IN ACCORDANCE WITH THE CONTRACT DOCUMENTS. THE CONTRACTOR SHALL KEEP A COPY OF THE DRAWINGS AND SPECIFICATIONS ONSITE AT ALL TIMES DURING THE PROJECT.
 4. CONTRACTOR SHALL MAINTAIN ADAQUATE SURVEY CONTROL AT ALL TIMES TO ESTABLISH AND MAINTAIN ALL LINES AND ELEVATIONS.
 5. THE CONTRACTOR SHALL VERIFY THE LOCATION OF ALL UNDERGROUND AND SUBMERGED UTILITIES WITHIN THE LIMITS OF THE WORK PRIOR TO COMMENCING ANY EXCAVATION OR GROUND PENETRATING WORK. THE CONTRACTOR SHALL NOTIFY "DIG SAFE" (1-888-344-7223) AT LEAST 3 BUSINESS DAYS PRIOR TO COMMENCEMENT OF THE EXCAVATION OR GROUND PENETRATING ACTIVITY.
 6. ALL DIMENSIONS AND DETAILS OF THE EXISTING CONDITIONS AND THE PROPOSED CONDITIONS SHALL BE CHECKED AND VERIFIED BY THE CONTRACTOR PRIOR TO COMMENCING CONSTRUCTION.
 7. IT IS THE CONTRACTOR'S RESPONSIBILITY TO PROVIDE AND MAINTAIN ENVIRONMENTAL CONTROLS AS REQUIRED BY STATE, LOCAL AND FEDERAL REGULATIONS AND LAW, AS WELL AS REQUIRED WITHIN EXISTING PERMITS AND APPROVALS.
 8. ALL APPLICABLE FEDERAL AND STATE REGULATIONS AND PERMITS SHALL BE FOLLOWED, INCLUDING, BUT NOT LIMITED TO, THE CLEAN WATER ACT, THE FEDERAL DEPARTMENT OF LABOR, OCCUPATIONAL SAFETY, HEALTH ACT, 401 WATER QUALITY CERTIFICATION, CHAPTER 91 LICENSE, AND U.S. ARMY CORPS OF ENGINEERS.
- HYDROGRAPHIC SURVEY, DREDGING AND DISPOSAL NOTES:
1. COORDINATES SHOWN ARE IN THE STATE PLANE COORDINATE SYSTEM, MASSACHUSETTS MAINLAND ZONE 2001, REFERENCED TO THE 1983 NORTH AMERICAN DATUM (NAD83) EXPRESSED IN US SURVEY FEET.
 2. HYDROGRAPHIC SURVEY OF LOWER HARBOR CAD CELL AREA (LHCC), EXISTING CAD CELL 1, CAD CELL 2 AND BORROW PIT CAD CELL WERE COLLECTED BY APEX COMPANIES LLC. ON JANUARY 16, 2012.
 3. HYDROGRAPHIC SURVEY DATUM IS REFERENCED TO MEAN LOWER LOW WATER (MLLW) ON THE NATIONAL OCEANIC AND ATMOSPHERIC ADMINISTRATION NATIONAL OCEAN SERVICE TIDAL BENCHMARK BM7584 J 1977 SURVEY DISK SET FLUSH IN THE SURFACE OF A CONCRETE SIDEWALK ON THE SOUTH SIDE OF U.S. HIGHWAY 6 ON THE NORTH SIDE OF THE MOBIL SERVICE STATION, 4 FEET (1 M) WEST OF A FIRE HYDRANT AND 1 FOOT (0.3 M) SOUTH OF U.S. HIGHWAY 6. DATUM SEPARATIONS WERE COMPUTED BY COLER & COLANTONIO, INC. FEBRUARY, 2002 AS MLLW - 1.52 FT = NGVD29 0.0 FT AND MLLW - 2.34 FT = 0.0 NAVD88. TO OBTAIN VALUES IN NGVD29, SUBTRACT 1.52 FEET FROM THE INDICATED VALUE AT ANY POINT. IN ORDER TO OBTAIN VALUES IN NAVD88 SUBTRACT 2.34 FEET FROM THE GIVEN VALUE AT ANY POINT. HORIZONTAL CONTROL CAN BE OBTAINED FROM THE ENGINEER. SEE GRAPHIC DEPICTION OF DATUM SEPARATIONS ON THIS SHEET.
 4. BASE PLAN OBTAINED FROM U.S. ARMY CORPS OF ENGINEERS. EXISTING CONDITIONS SHALL BE FIELD VERIFIED BY THE CONTRACTOR.
 5. LIMITS OF FEDERAL NAVIGATIONAL CHANNEL WERE OBTAINED FROM U.S. ARMY CORPS OF ENGINEERS.
 6. HORIZONTAL AND VERTICAL CONTROL HAS BEEN PROVIDED BY THE OWNER AND NOT INDEPENDENTLY VERIFIED. THE CONTRACTOR IS RESPONSIBLE FOR FIELD VERIFICATION OF CONTROL DATA.
 7. MUDLINE CONTOUR INTERVAL SHOWN IS ONE FOOT.
 8. THE INFORMATION DEPICTED ON THIS PLAN REPRESENTS THE RESULTS OF SURVEYS MADE ON THE DATES INDICATED ABOVE AND CAN ONLY BE CONSIDERED AS INDICATING THE CONDITIONS AT THE TIME OF THE SURVEYS AND AT THE SOUNDING POINTS NOTED ON THE PLAN.
 9. EXISTING UTILITIES WITHIN THE SITE HAVE NOT BEEN IDENTIFIED. IDENTIFICATION AND PROTECTION OF EXISTING UTILITIES IS THE SOLE RESPONSIBILITY OF THE CONTRACTOR.
 10. NUMEROUS SUBSURFACE EXPLORATIONS HAVE BEEN CONDUCTED WITHIN THE PROJECT SITE TO PROVIDE GEOTECHNICAL AND ANALYTICAL DATA REQUIRED FOR PROJECT DESIGN AND CONSTRUCTION. LOCATIONS OF SUBSURFACE EXPLORATIONS ARE NOT INDICATED ON THIS PLAN FOR CLARITY. REFER TO THE SPECIFICATIONS FOR LOCATION PLAN OF THE SUBSURFACE EXPLORATION, LOGS OF EXPLORATIONS AND RESULTS OF LABORATORY TESTING.
 11. LOCATIONS OF SUBMERGED OBSTRUCTIONS IDENTIFIED ON THIS PLAN ARE APPROXIMATE, AND ARE BASED ON HYDROGRAPHIC SURVEY DATA. SUBMERGED OBSTRUCTIONS LIKELY CONSIST OF SUNKEN WRECKS. THE SUBMERGED OBSTRUCTIONS SHALL NOT BE DISTURBED, AND MAY THEREFORE PRESENT A NAVIGATION HAZARD. THE CONTRACTOR SHALL FIELD VERIFY LOCATION, DEPTH AND CHARACTER OF THE SUBMERGED OBSTRUCTIONS.
 12. CONTRACTOR IS TO VERIFY THAT THERE ARE NO EXISTING HAZARDS OR OBSTRUCTIONS IN THE MOORING AREAS SHOWN HEREON. IT IS KNOWN THAT THE U.S. EPA HAS A PIPELINE NORTH OF CAD CELL 1 (APPROXIMATE LOCATION SHOWN HEREON) WHICH MUST BE ACCURATELY LOCATED BY THE CONTRACTOR PRIOR TO MOORING ANY BARGE OR VESSEL, OR CONDUCTING ANY WORK IN THE AREA SHOWN. CONTRACTOR SHALL NOT DAMAGE THE EPA PIPELINE.
 13. MATERIAL WHICH IS LEAKED FROM A CONTRACTOR BARGE, WHETHER WITHIN OR OUTSIDE OF A DESIGNATED DREDGE OR DISPOSAL LOCATION, SHALL BE REMOVED BY THE CONTRACTOR AT NO COST TO THE OWNER.
 14. LIMITS OF DREDGING SHOWN ON THE CONTRACT DRAWINGS ARE APPROXIMATE, AND ON THE BOTTOM OF LOWER HARBOR CAD CELL (LHCC) PHASE I, AND BOTTOM OF LOWER HARBOR CAD CELL (LHCC) PHASE II PLANS, REPRESENTS TOP OF SLOPE BASED ON AN ASSUMED SLOPE OF 3 HORIZONTAL TO 1 VERTICAL (3H:1V) DRAWN OUTWARD AND UPWARD FROM THE ADJACENT TOE OF SLOPE AT THE ALLOWABLE OVERDREDGE ELEVATION TO THE EXISTING MUDLINE. OVERDREDGE ELEVATION TO THE PROPOSED TOP OF DREDGE SURFACE FOR CAD CELL PHASE I, AND TOP OF LHCC PHASE II PLANS, THE LIMITS OF DREDGING SHOWN REPRESENTS THE TOP OF SLOPE BASED ON AN ASSUMED SLOPE OF 5 HORIZONTAL TO 1 VERTICAL (5H:1V) DRAWN OUTWARD AND UPWARD FROM THE ADJACENT TOE OF SLOPE AT THE ALLOWABLE OVERDREDGE ELEVATION TO THE EXISTING MUDLINE.
 15. MATERIAL BEYOND THE DREDGE LIMITS WHICH SLOUGHS INTO THE DREDGE AREA SHALL BE REMOVED TO THE DESIGN DREDGE ELEVATIONS FOR THE AREA.
 16. EXISTING TEMPORARY STRUCTURES, SUCH AS MOORINGS, FLOATING DOCKS, BARGES, OR VESSELS SHALL BE TEMPORARILY RELOCATED BY THE CONTRACTOR PRIOR TO THE START OF CONSTRUCTION. CONTRACTOR SHALL FIRST COMMUNICATE AND COORDINATE WITH THE OWNER OF SUCH STRUCTURES. ONCE CONSTRUCTION IS COMPLETE, CONTRACTOR SHALL RE-LOCATE THE STRUCTURES TO THEIR ORIGINAL LOCATIONS.
 17. OVERDREDGING BY THE CONTRACTOR IS TO BE MINIMIZED TO THE MAXIMUM EXTENT PRACTICABLE. SEE SECTION 02482 DREDGING FOR ADDITIONAL DETAILS. LIQUIDATED DAMAGES ARE APPLICABLE FOR OVERDREDGING MATERIAL TO BE DREDGED AS SHOWN ON CONTRACT DRAWINGS P-1 AND P-3.
 18. NO SPUDDING OR ANCHORING SHALL OCCUR WITHIN CAD CELL #1 OR THE BORROW PIT CAD CELL.
 19. REFER TO SECTION 02482 DREDGING AND 02492 DISPOSAL AT OFFSHORE DISPOSAL SITES FOR ADDITIONAL INFORMATION REGARDING DREDGING, DISPOSAL AND OFFSHORE DISPOSAL.
 20. THE CONTRACTOR SHALL DESIGN DISPOSAL OPERATIONS SUCH THAT MATERIAL IS PLACED WITHIN THE DESIGNATED DISPOSAL AREA. MATERIAL PLACED BEYOND THE DESIGNATED DISPOSAL AREA CLEAN UP LIMITS OR MORE THAN ONE FOOT OF MATERIAL DEPOSITED INSIDE OF THE DESIGNATED DISPOSAL AREA CLEAN UP LIMITS SHALL BE REMOVED BY THE CONTRACTOR AND PLACED WITHIN THE DESIGNATED DISPOSAL AREA AT NO COST TO THE OWNER.
 21. ELEVATIONS ARE IN FEET ARE REFERENCED TO MEAN LOWER LOW WATER (MLLW). THE FINISHED ELEVATION OF DISPOSED DREDGE MATERIAL IN CAD CELL #2 AND TRANSITIONAL CAD CELL SHALL NOT EXCEED -15' MEAN LOWER LOW WATER (MLLW).
 22. SEE SHEETS P-1 THROUGH P-7 FOR LOCATIONS OF CROSS SECTIONS.
 23. SEE SHEETS C-1, C-2 AND C-3 FOR CROSS SECTIONS.

LEGEND

ACAD3-2011-B5 BORING LOCATION

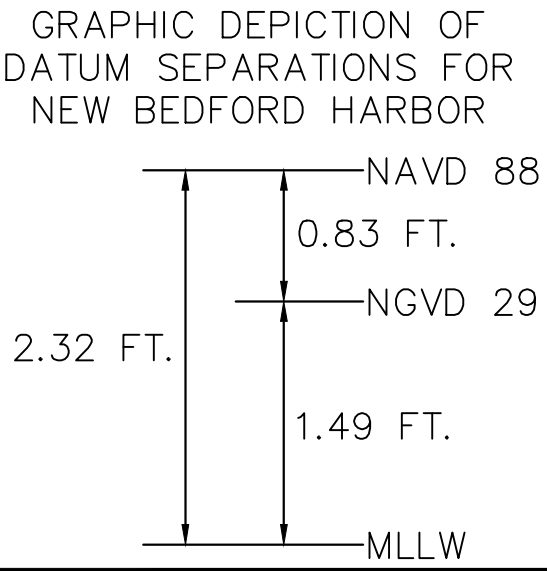

APEX

ROCKVILLE, MD
SOUTH WINDSOR, CT - BOSTON, MA -
NEW BEDFORD, MA - HOLYOKE, MA

125 BROAD STREET, 5TH FLOOR
BOSTON, MA 02210

58H CONNECTICUT AVENUE
SOUTH WINDSOR, CT

The drawings prepared by Apex for this project are instruments of Apex's service for use solely with respect to the project, and Apex shall be deemed the author of the Drawing and shall retain all copyright, proprietary and other reserved rights with respect thereto, including the copyright. The Documents shall not be used on other projects, in addition to the project or for completion of the project by others, except by agreement in writing and with appropriate compensation to Apex.

PROJECT	NEW BEDFORD HARBOR DEVELOPMENT COMMISSION LOWER HARBOR CAD CELL
	OWNER
OWNER	NEW BEDFORD HARBOR DEVELOPMENT COMMISSION 52 FISHERMAN'S WHARF, NEW BEDFORD, MA 02740

NO.	DATE	DESCRIPTION	BY
PROJECT NO.	6724		
CADD FILE			
DESIGNED BY			
DRAWN BY			
CHECKED BY			
DATE	SEPTEMBER 2012		
DRAWING SCALE	AS NOTED		

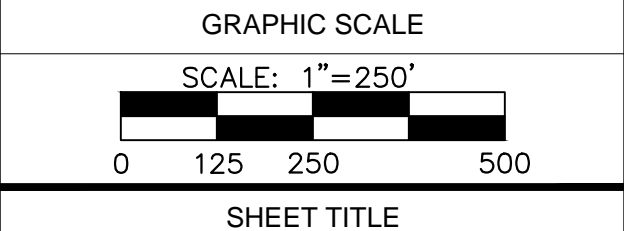

SHEET TITLE

**GENERAL
ARRANGEMENT
PLAN / GENERAL
NOTES**

DRAWING NO.

T-2

2 OF 14

PLOT SCALE 1/16"=1'-0"



ROCKVILLE, MD
SOUTH WINDSOR, CT - BOSTON, MA -
NEW BEDFORD, MA - HOLYOKE, MA

125 BROAD STREET, 5TH FLOOR
BOSTON, MA 02210

58H CONNECTICUT AVENUE
SOUTH WINDSOR, CT

The drawings prepared by Apex for the project are instruments of Apex's service to be used solely with respect to the project, and Apex shall be deemed the author of the Drawing and shall retain all copyright, title, and other reserved rights with respect thereto, including the copyright. The Documents and all rights based on other projects, in addition to the project or for completion of the project by others, except by agreement in writing and with appropriate compensation to Apex.

PROJECT
NEW BEDFORD HARBOR
DEVELOPMENT COMMISSION
LOWER HARBOR CAD CELL

OWNER
NEW BEDFORD
HARBOR DEVELOPMENT COMMISSION
52 FISHERMAN'S WHARF, NEW BEDFORD, MA 02740

NO.	DATE	DESCRIPTION	BY
PROJECT NO.	6724		
CADD FILE			
DESIGNED BY	GCD		
DRAWN BY	JER		
CHECKED BY	GCD		
DATE	SEPTEMBER 2012		
DRAWING SCALE	1" = 50'		

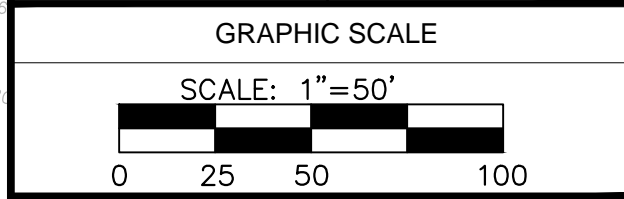

SHEET TITLE
LOWER HARBOR
CAD CELL
EXISTING
CONDITIONS

DRAWING NO.
E-1

3 OF 14

PLOT SCALE 1/16"=1'-0"





ROCKVILLE, MD
SOUTH WINDSOR, CT - BOSTON, MA -
NEW BEDFORD, MA - HOLYOKE, MA

125 BROAD STREET, 5TH FLOOR
BOSTON, MA 02210

58H CONNECTICUT AVENUE
SOUTH WINDSOR, CT

The drawings prepared by Apex for the project are instruments of Apex's service to be used solely with respect to the project, and Apex shall be deemed the author of the Drawing and shall retain all copyright, patent, and other reserved rights with respect to the Drawing. The Drawing shall not be used on other projects, for additions to the project or for completion of the project by others, except by agreement in writing and with appropriate compensation to Apex.

PROJECT

NEW BEDFORD HARBOR
DEVELOPMENT COMMISSION
LOWER HARBOR CAD CELL

OWNER

NEW BEDFORD
HARBOR DEVELOPMENT COMMISSION
52 FISHERMAN'S WHARF, NEW BEDFORD, MA 02740

NO.	DATE	DESCRIPTION	BY
PROJECT NO.	6724		
CADD FILE			
DESIGNED BY	CHM		
DRAWN BY	GCD		
CHECKED BY	GCD		
DATE	SEPTEMBER 2012		
DRAWING SCALE	1" = 50'		

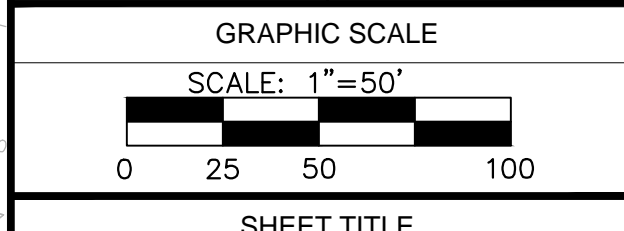

SHEET TITLE

**CAD CELL # 2
EXISTING
CONDITIONS**

DRAWING NO.

E-2

4 OF 14

PLOT SCALE 1/16"=1'-0"

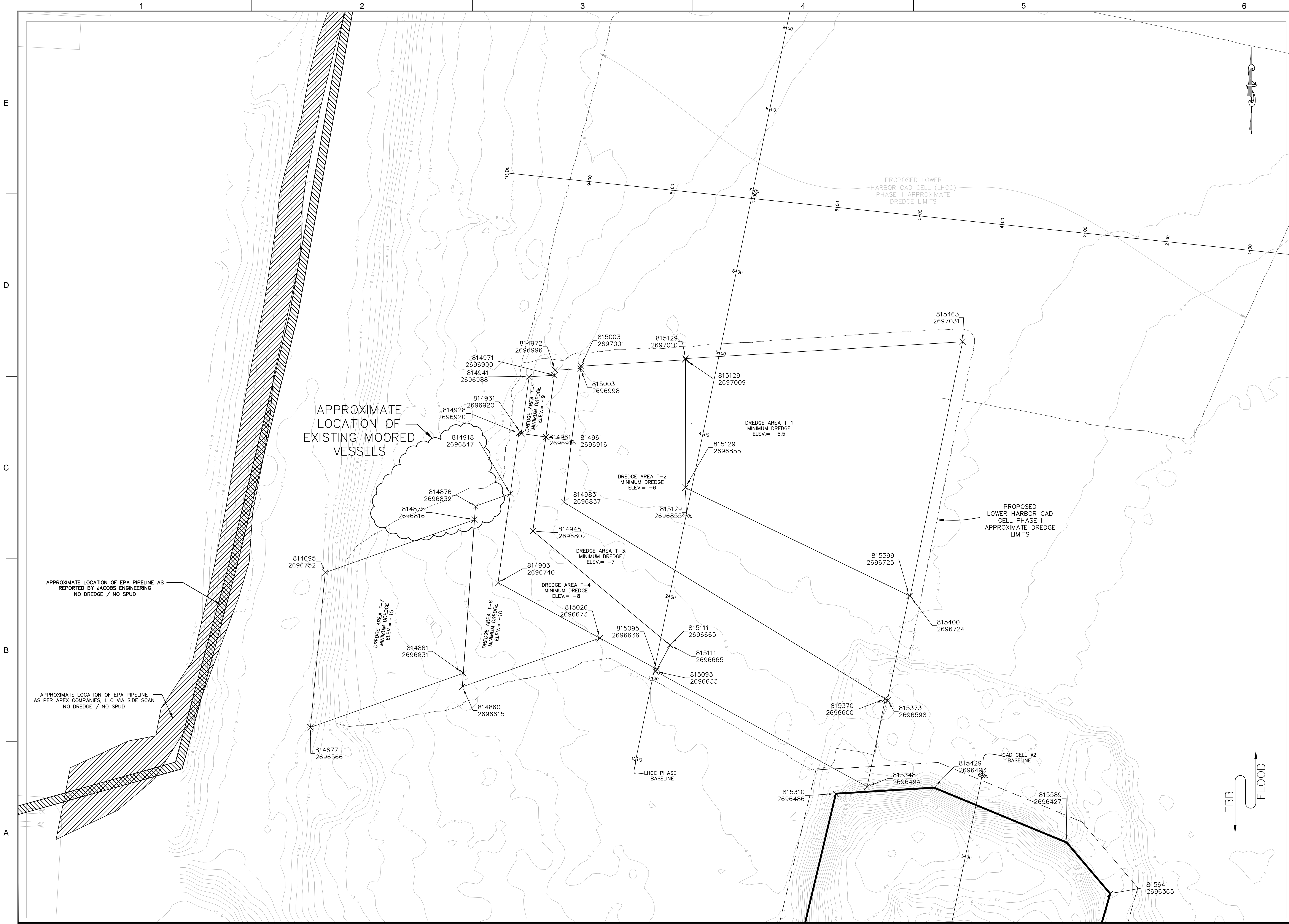

ROCKVILLE, MD
SOUTH WINDSOR, CT - BOSTON, MA -
NEW BEDFORD, MA - HOLYOKE, MA

125 BROAD STREET, 5TH FLOOR
BOSTON, MA 02210

58H CONNECTICUT AVENUE
SOUTH WINDSOR, CT

The drawings prepared by Apex for this project are instruments of Apex's service for use solely with respect to the project, and Apex shall be deemed the author of the Drawing and shall retain all common law, statutory and other reserved rights with respect thereto, including the copyright. The Documents shall not be used on other projects, for additions to the project or for completion of the project by others, except by agreement in writing and with appropriate compensation to Apex.

PROJECT
NEW BEDFORD HARBOR
DEVELOPMENT COMMISSION
LOWER HARBOR CAD CELL

OWNER
NEW BEDFORD
HARBOR DEVELOPMENT COMMISSION
52 FISHERMAN'S WHARF, NEW BEDFORD, MA 02740

NO.	DATE	DESCRIPTION	BY
PROJECT NO.	6724		
CADD FILE			
DESIGNED BY	CHM		
DRAWN BY	GCD		
CHECKED BY	GCD		
DATE	SEPTEMBER 2012		
DRAWING SCALE	AS NOTED		

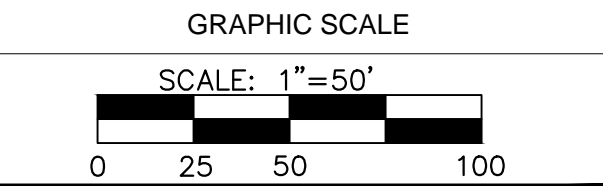

SHEET TITLE
TOP OF
LOWER HARBOR
CAD CELL
PHASE I

DRAWING NO.
P-1

5 OF 14

PLOT SCALE 1/16"=1'-0"

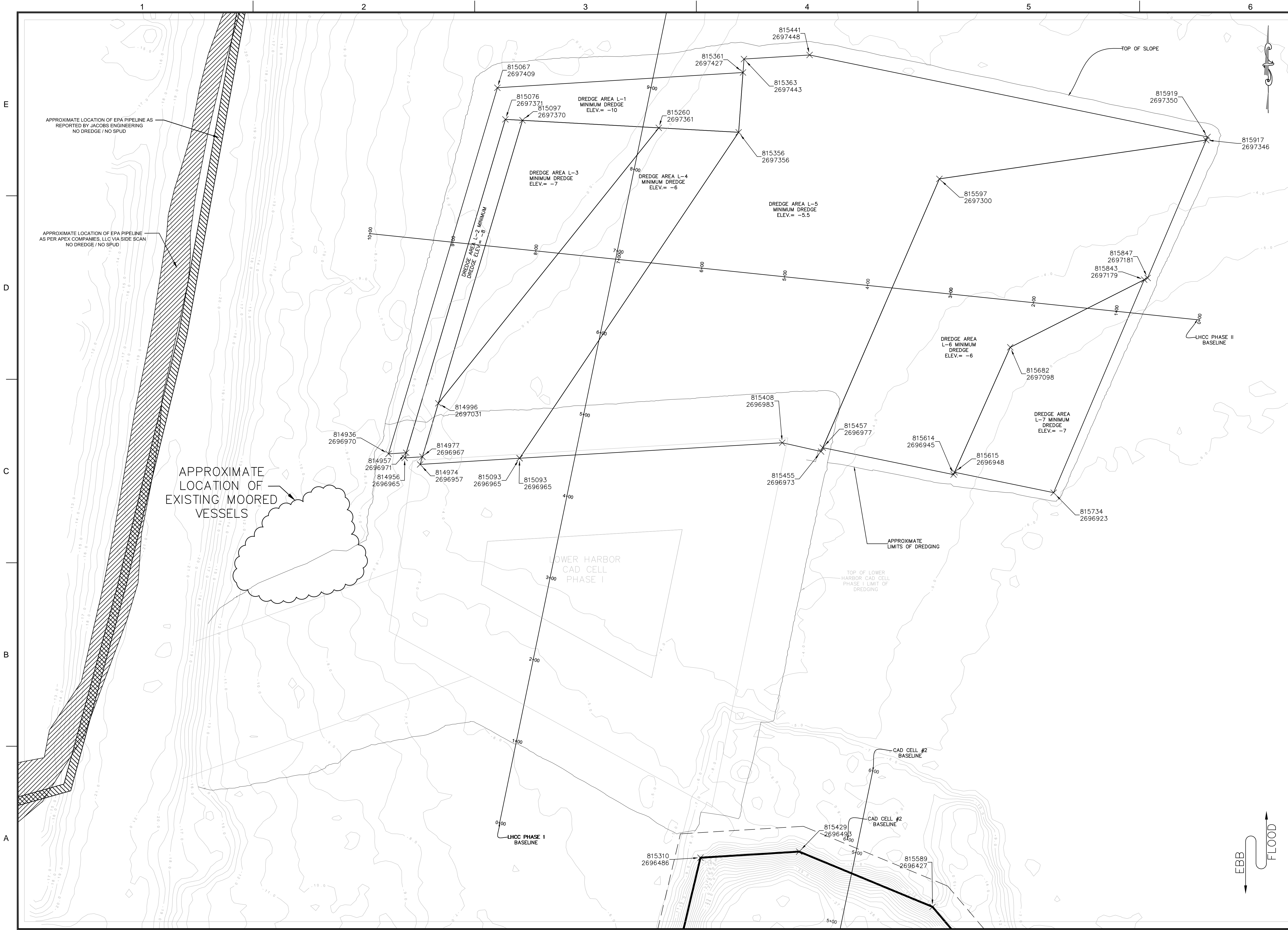

ROCKVILLE, MD
SOUTH WINDSOR, CT - BOSTON, MA -
NEW BEDFORD, MA - HOLYOKE, MA

125 BROAD STREET, 5TH FLOOR
BOSTON, MA 02210

58H CONNECTICUT AVENUE
SOUTH WINDSOR, CT

The drawings prepared by Apex for this project are instruments of Apex's service for use solely with respect to the project, and Apex shall be deemed the author of the Drawing and shall retain all common law, statutory and other reserved rights with respect thereto. The Documents shall not be used on other projects, for additions to this project or for completion of this project by others, except by agreement in writing and with appropriate compensation to Apex.

PROJECT
NEW BEDFORD HARBOR
DEVELOPMENT COMMISSION
LOWER HARBOR CAD CELL

OWNER
NEW BEDFORD
HARBOR DEVELOPMENT COMMISSION
52 FISHERMAN'S WHARF, NEW BEDFORD, MA 02740

NO.	DATE	DESCRIPTION	BY
PROJECT NO.	6724		
CADD FILE			
DESIGNED BY	CHM		
DRAWN BY	GCD		
CHECKED BY	GCD		
DATE	SEPTEMBER 2012		
DRAWING SCALE	AS NOTED		

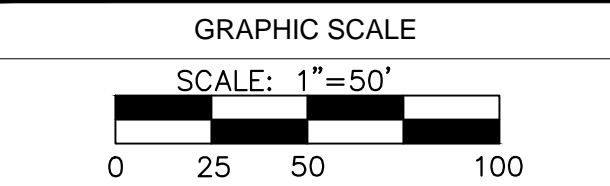

SHEET TITLE
TOP OF
LOWER HARBOR
CAD CELL
PHASE II

DRAWING NO.
P-3
7 OF 14

PLOT SCALE 1/16"=1'-0"

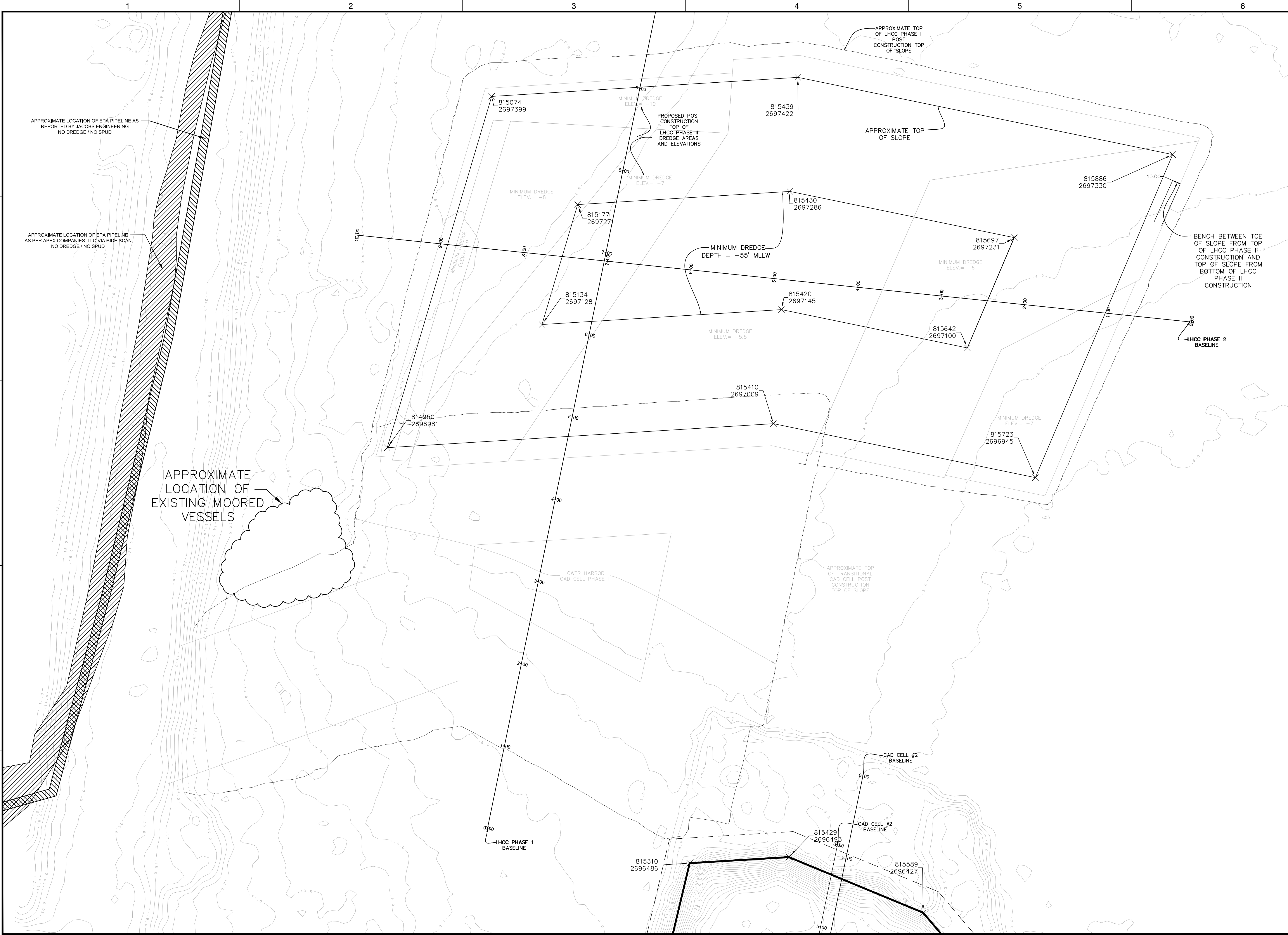

ROCKVILLE, MD
SOUTH WINDSOR, CT - BOSTON, MA -
NEW BEDFORD, MA - HOLYOKE, MA

125 BROAD STREET, 5TH FLOOR
BOSTON, MA 02210

58H CONNECTICUT AVENUE
SOUTH WINDSOR, CT

The drawings prepared by Apex for this project are instruments of Apex's service for use solely with respect to the project, and Apex shall be deemed the author of the Drawing and shall retain all common law, statutory and other reserved rights with respect thereto. The Documents shall not be used on other projects, for additions to the project or for completion of the project by others, except by agreement in writing and with appropriate compensation to Apex.

PROJECT
NEW BEDFORD HARBOR
DEVELOPMENT COMMISSION
LOWER HARBOR CAD CELL

OWNER
NEW BEDFORD
HARBOR DEVELOPMENT COMMISSION
52 FISHERMAN'S WHARF, NEW BEDFORD, MA 02740

NO.	DATE	DESCRIPTION	BY
PROJECT NO.	6724		
CADD FILE			
DESIGNED BY	CHM		
DRAWN BY	GCD		
CHECKED BY	GCD		
DATE	SEPTEMBER 2012		
DRAWING SCALE	AS NOTED		

GRAPHIC SCALE

SHEET TITLE

BOTTOM OF
LOWER HARBOR
CAD CELL
PHASE II

DRAWING NO.

P-4

8 OF 14

PLOT SCALE 1/16"=1'-0"

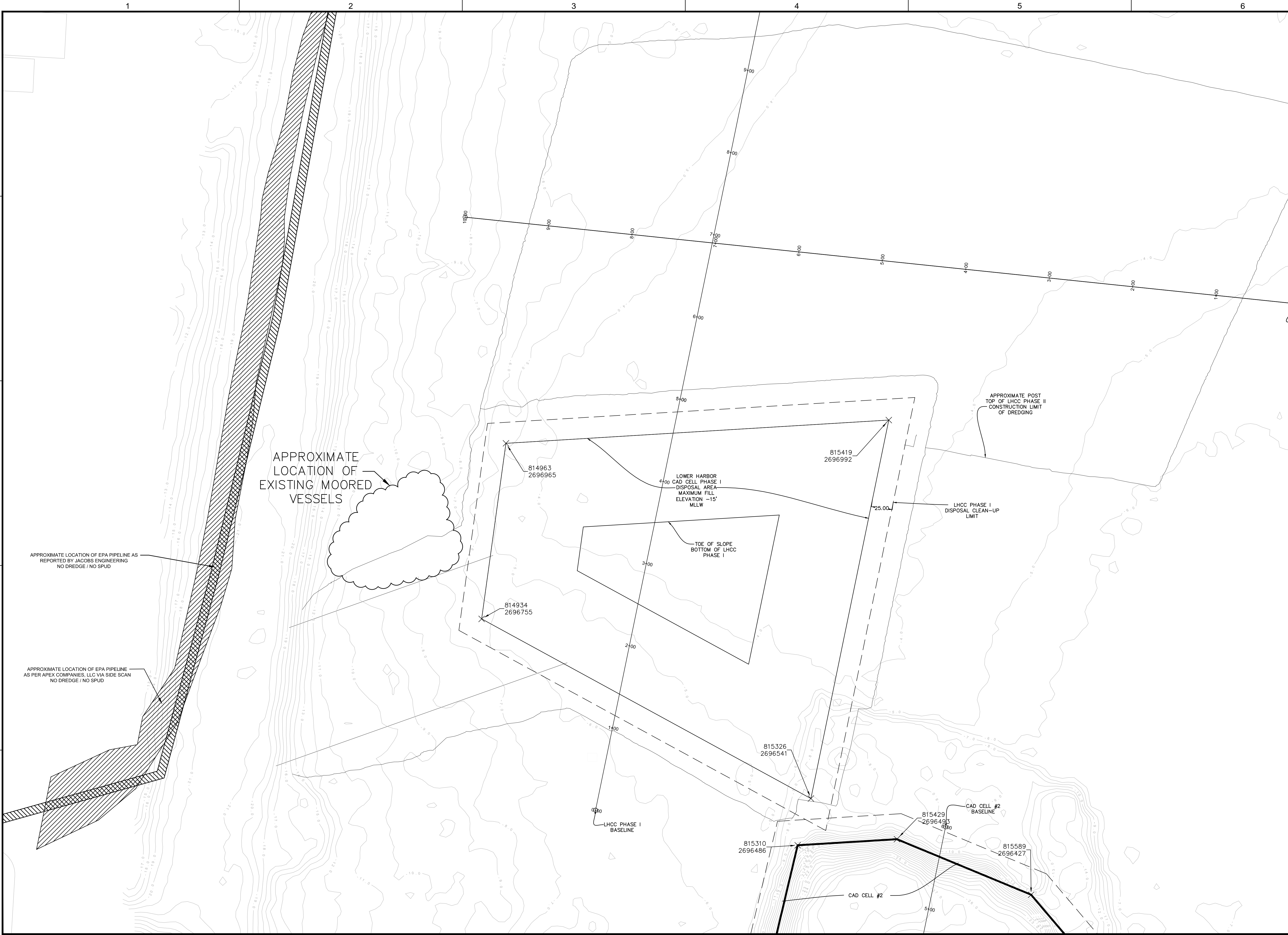

ROCKVILLE, MD
SOUTH WINDSOR, CT - BOSTON, MA -
NEW BEDFORD, MA - HOLYOKE, MA

125 BROAD STREET, 5TH FLOOR
BOSTON, MA 02210

58H CONNECTICUT AVENUE
SOUTH WINDSOR, CT

The drawings prepared by Apex for this project are instruments of Apex's service for use solely with respect to the project, and Apex shall be deemed the author of the Drawing and shall retain all common law, statutory and other reserved rights with respect thereto, including the copyright. The Documents shall not be used on other projects, for additions to the project or for completion of the project by others, except by agreement in writing and with appropriate compensation to Apex.

PROJECT
NEW BEDFORD HARBOR
DEVELOPMENT COMMISSION
LOWER HARBOR CAD CELL

OWNER
NEW BEDFORD
HARBOR DEVELOPMENT COMMISSION
52 FISHERMAN'S WHARF, NEW BEDFORD, MA 02740

NO.	DATE	DESCRIPTION	BY
PROJECT NO.	6724		
CADD FILE			
DESIGNED BY	CHM		
DRAWN BY	GCD		
CHECKED BY	GCD		
DATE	SEPTEMBER 2012		
DRAWING SCALE	AS NOTED		

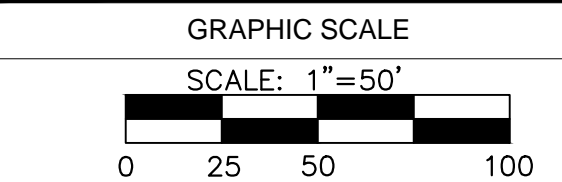

SHEET TITLE
LOWER HARBOR
CAD CELL
PHASE 1
DISPOSAL PLAN

DRAWING NO.
P-6
10 OF 14

PLOT SCALE 1/16"=1'-0"

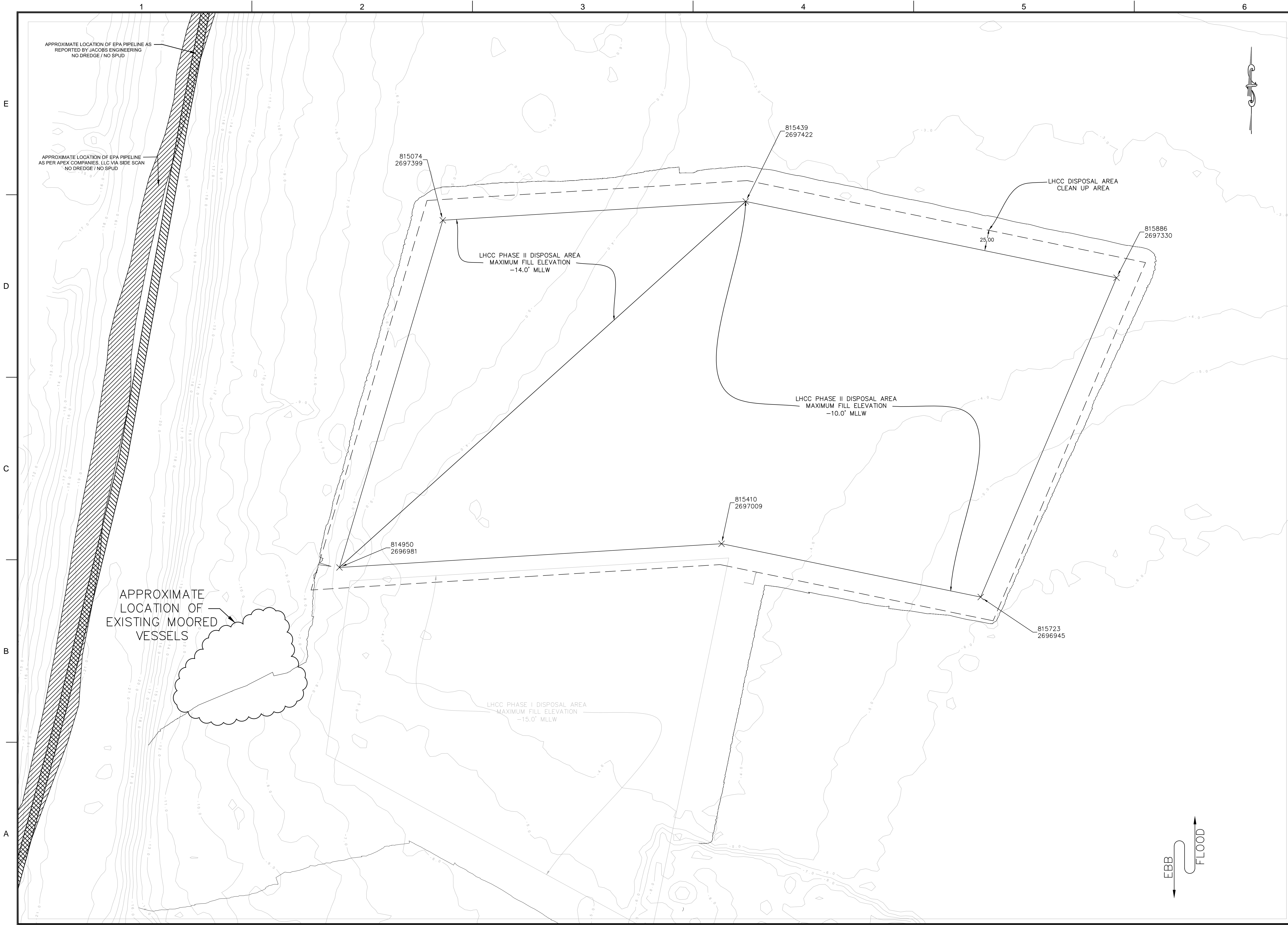

ROCKVILLE, MD
SOUTH WINDSOR, CT - BOSTON, MA -
NEW BEDFORD, MA - HOLYOKE, MA

125 BROAD STREET, 5TH FLOOR
BOSTON, MA 02210

58H CONNECTICUT AVENUE
SOUTH WINDSOR, CT

The drawings prepared by Apex for this project are instruments of Apex's service for use solely with respect to the project, and Apex shall be deemed the author of the Drawing and shall retain all common law, statutory and other reserved rights with respect thereto, including the copyright. The Documents shall not be used on other projects, for additions to this project or for completion of this project by others, except by agreement in writing and with appropriate compensation to Apex.

PROJECT
NEW BEDFORD HARBOR
DEVELOPMENT COMMISSION
LOWER HARBOR CAD CELL

OWNER
NEW BEDFORD
HARBOR DEVELOPMENT COMMISSION
52 FISHERMAN'S WHARF, NEW BEDFORD, MA 02740

NO.	DATE	DESCRIPTION	BY
PROJECT NO.		6724	
CADD FILE			
DESIGNED BY		CHM	
DRAWN BY		GCD	
CHECKED BY		GCD	
DATE		SEPTEMBER 2012	
DRAWING SCALE		AS NOTED	

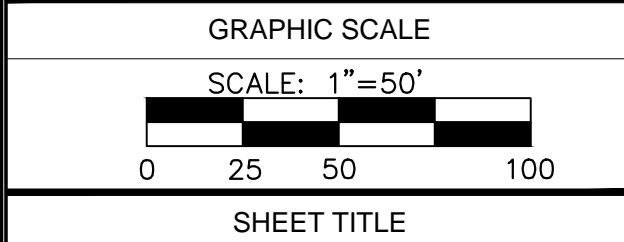

LOWER HARBOR
CAD CELL
PHASE II
DISPOSAL PLAN

DRAWING NO.

P-7

11 OF 14

PLOT SCALE 1/16"=1'-0"

Profile View of HCC_PHAS=J_BAS=LIN=

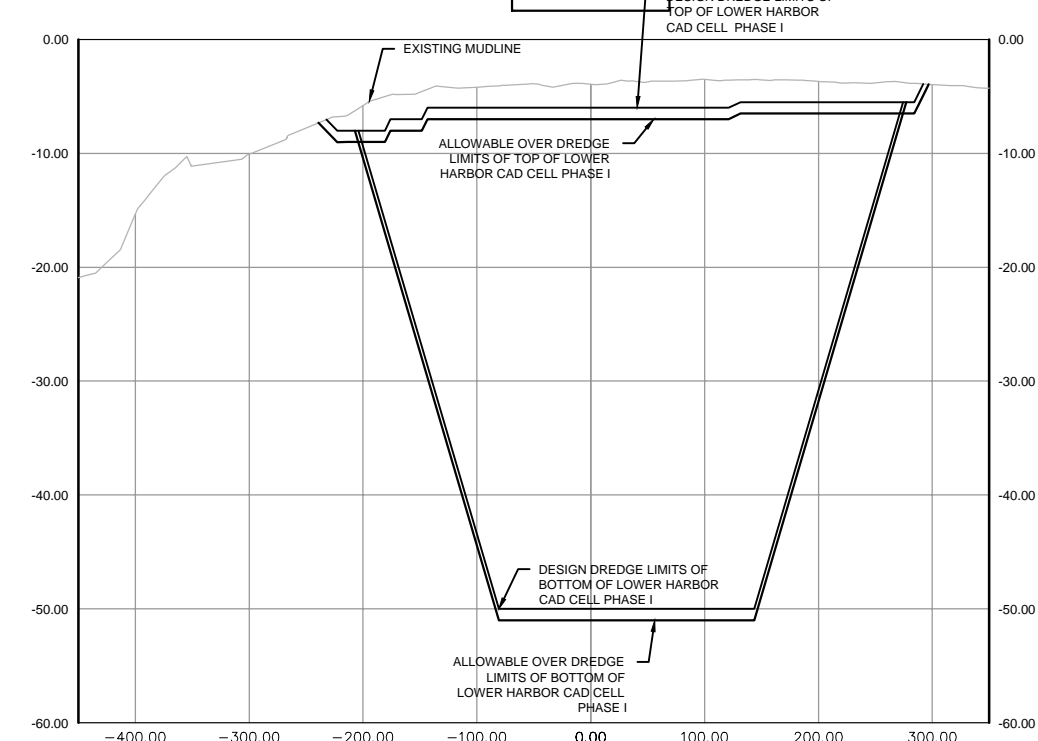
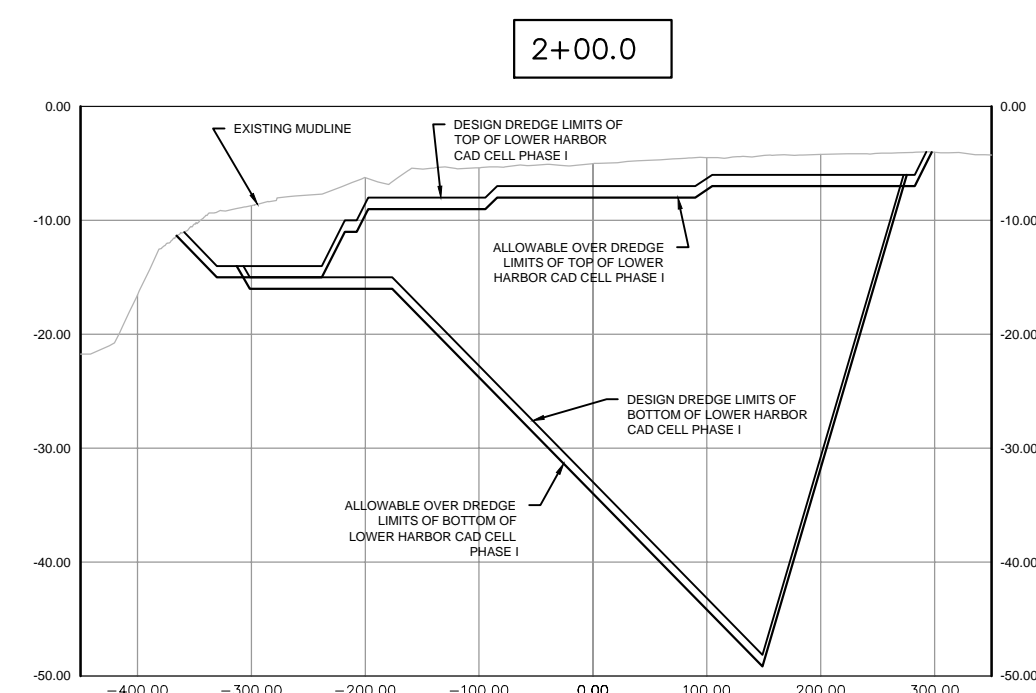
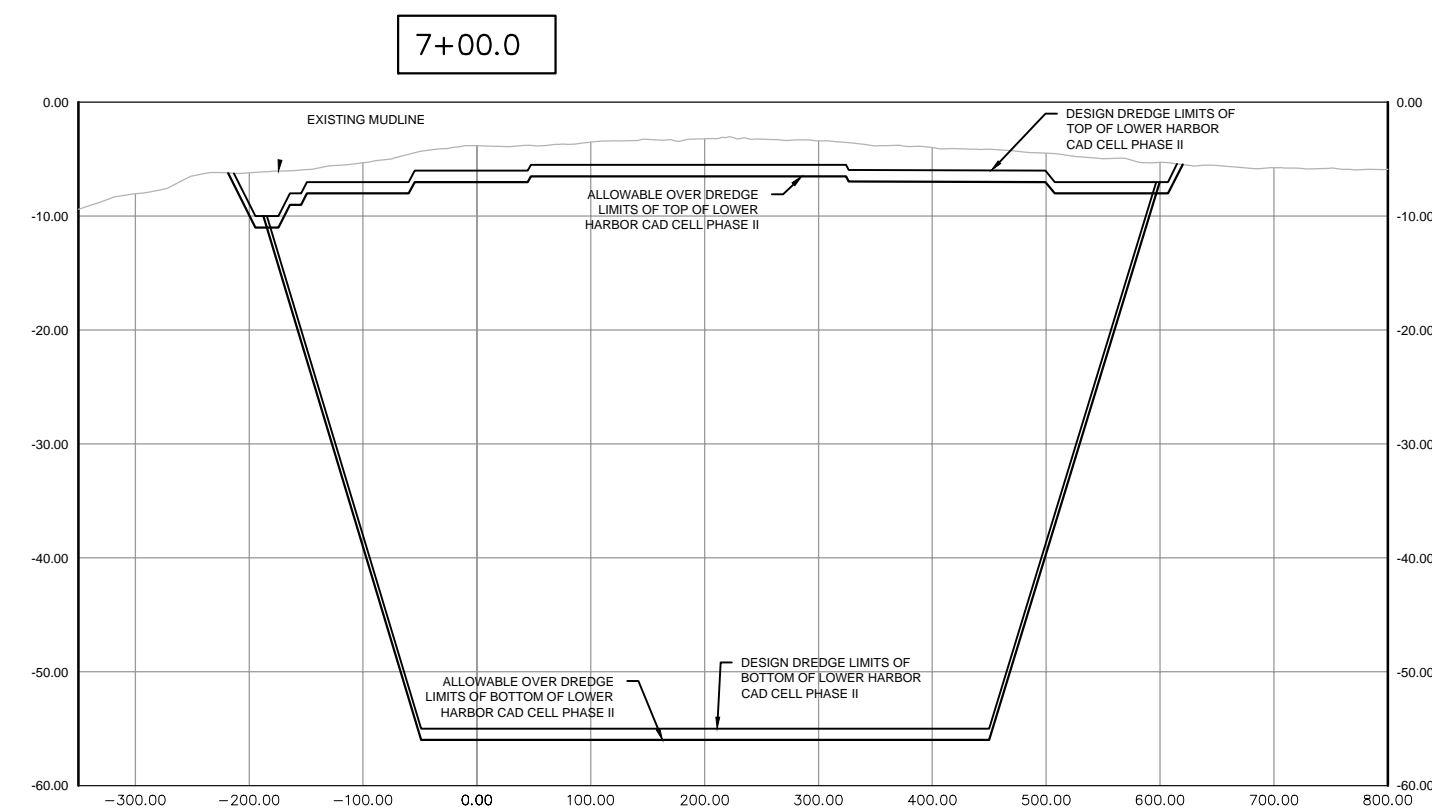
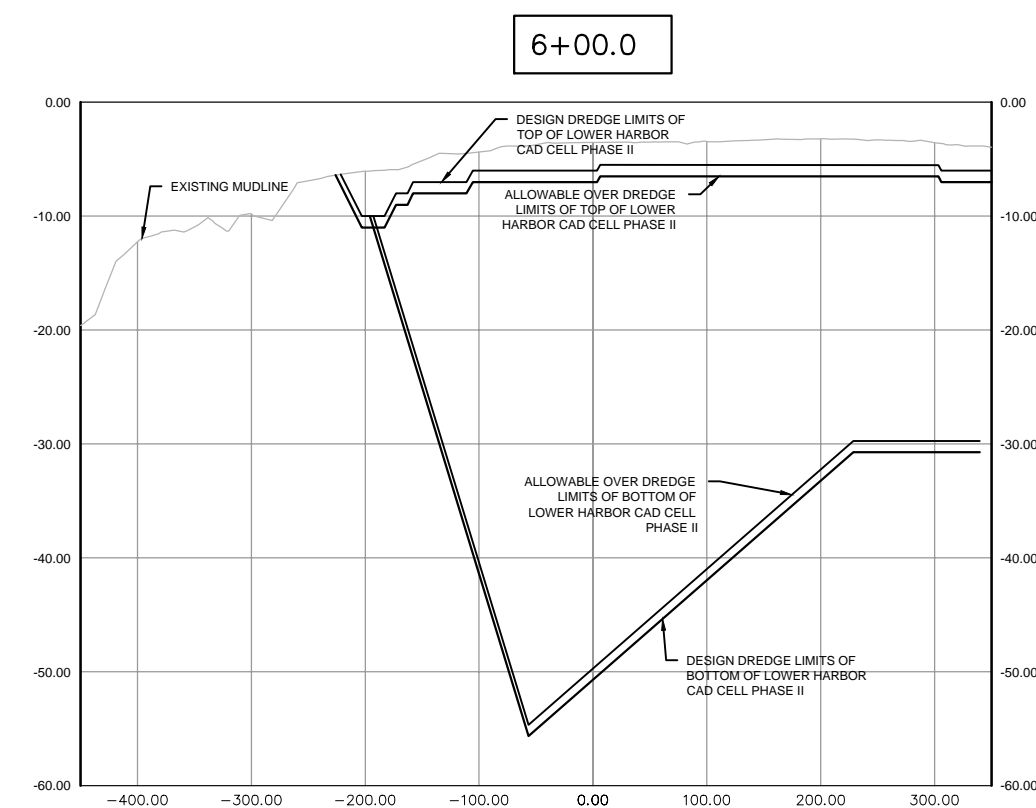
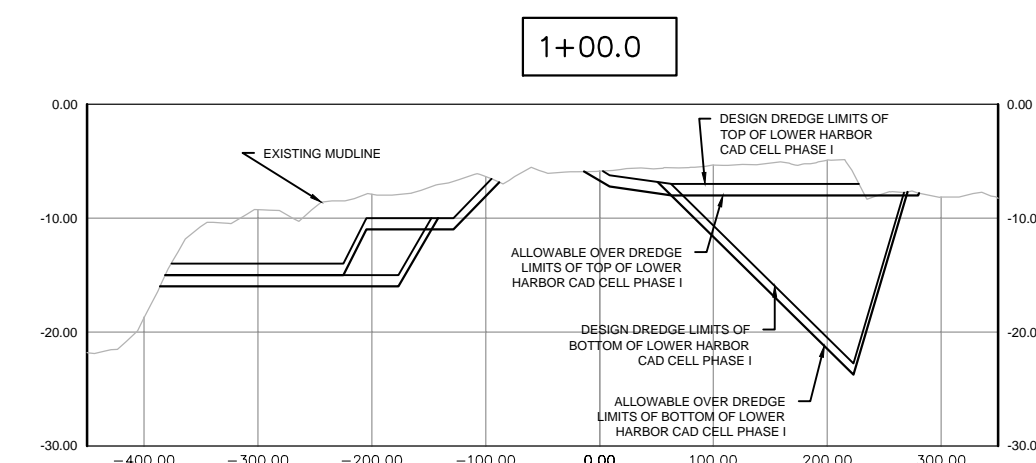
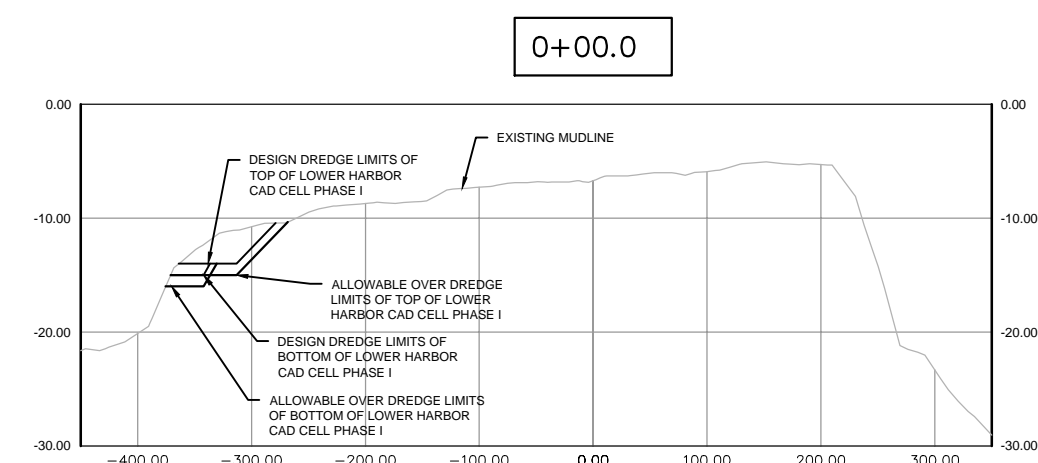
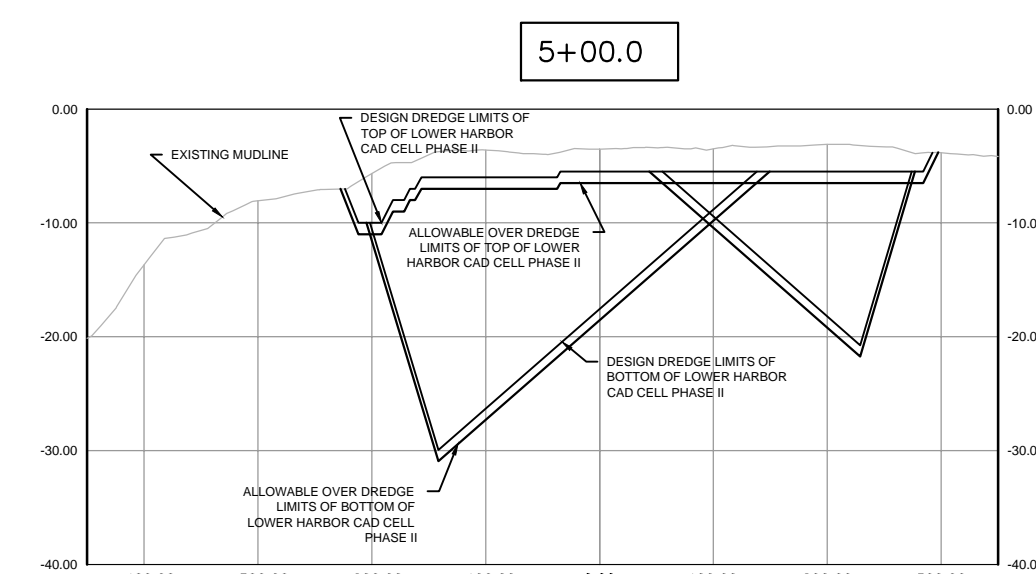
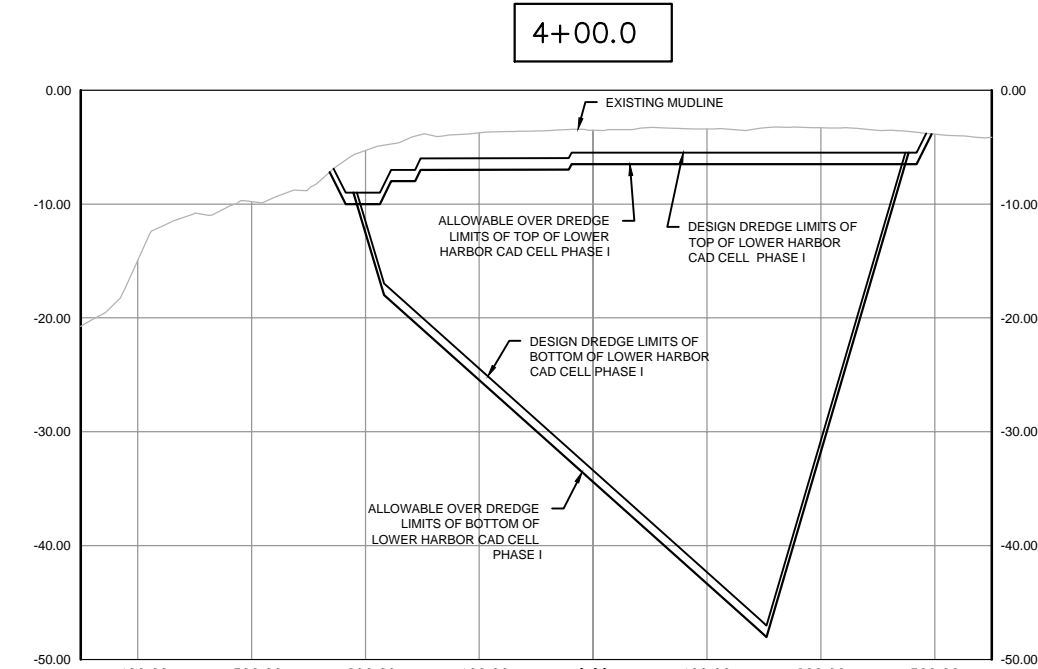
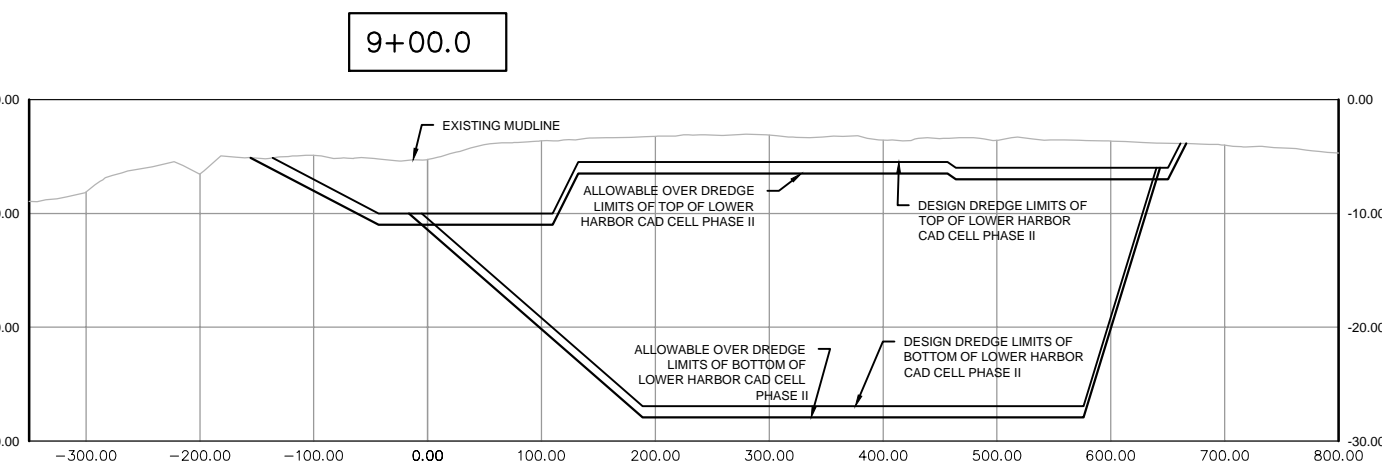
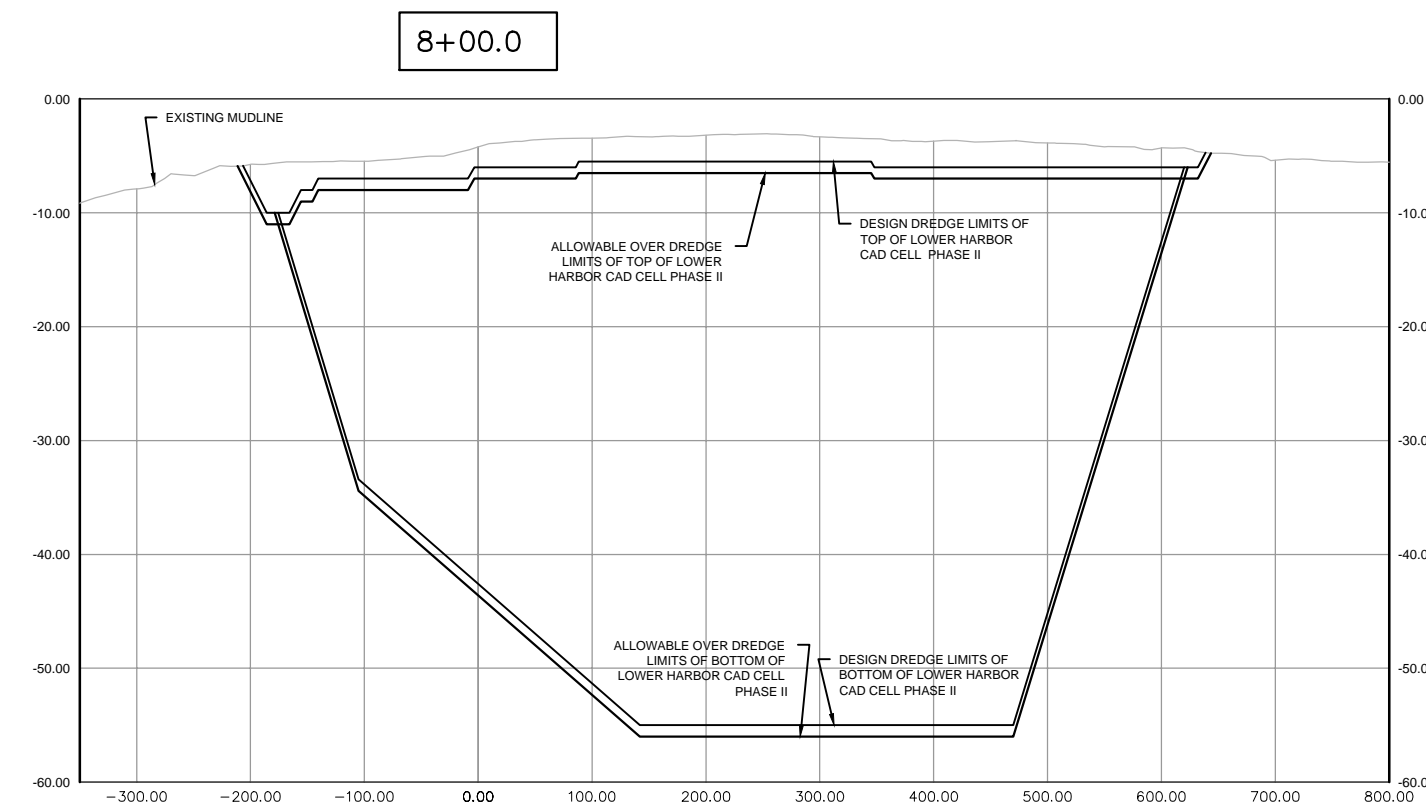
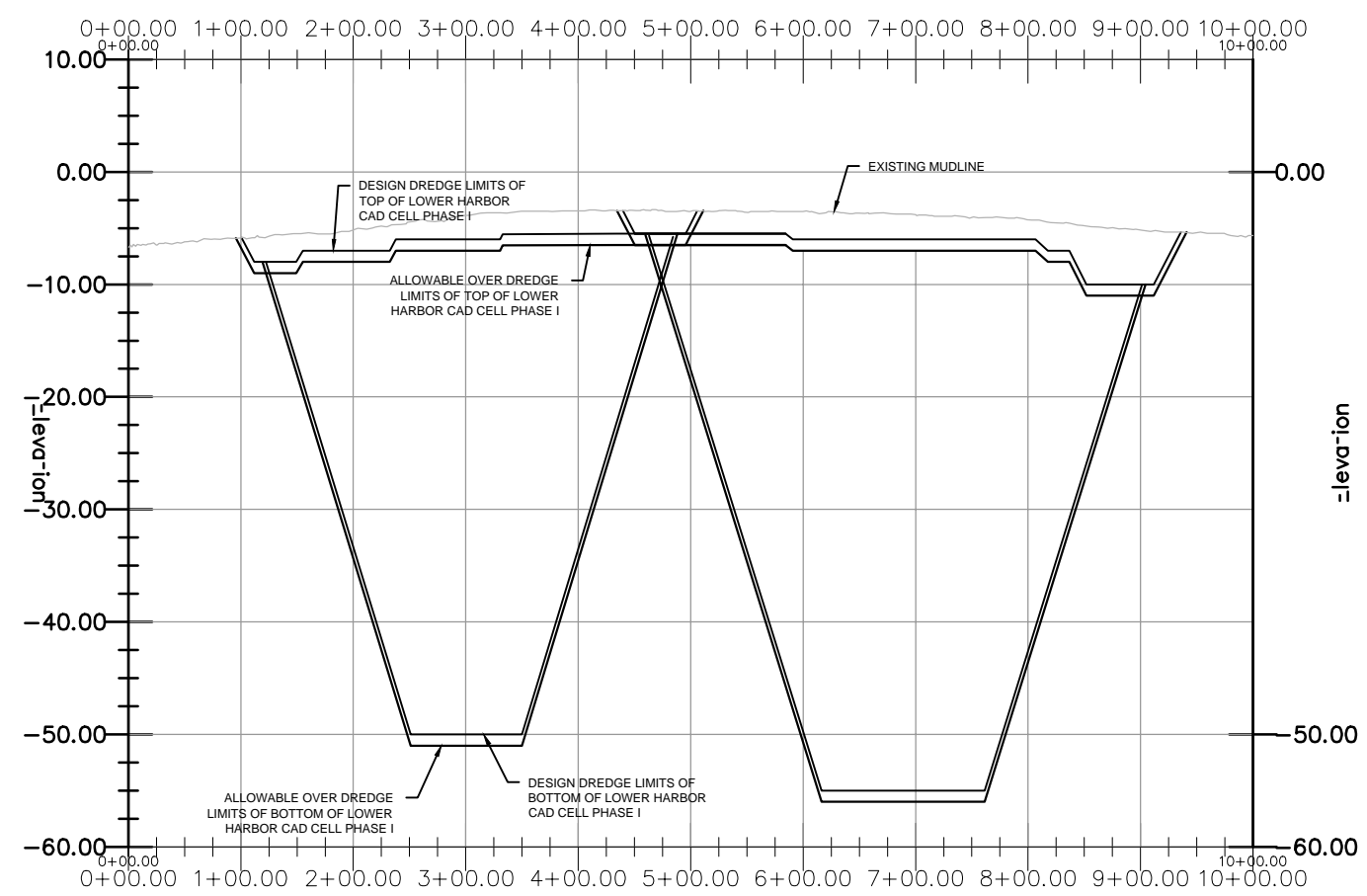

PROJECT	<p>NEW BEDFORD HARBOR DEVELOPMENT COMMISSION LOWER HARBOR CAD CELL</p>
OWNER	<p>NEW BEDFORD HARBOR DEVELOPMENT COMMISSION 52 FISHERMAN'S WHARF, NEW BEDFORD, MA 02740</p>

NO.	DATE	DESCRIPTION	BY
PROJECT NO.		6724	
CADD FILE			
DESIGNED BY		CHM	
DRAWN BY		GCD	
CHECKED BY		GCD	
DATE		SEPTEMBER 2012	
DRAWING SCALE		AS NOTED	

GRAPHIC SCALE

SHEET TITLE

LOWER HARBOR
CAD CELL
PHASE I
CROSS SECTIONS

DRAWING NO.

C-1

12 OF 14

PLOT SCALE 1/16"=1'-0"

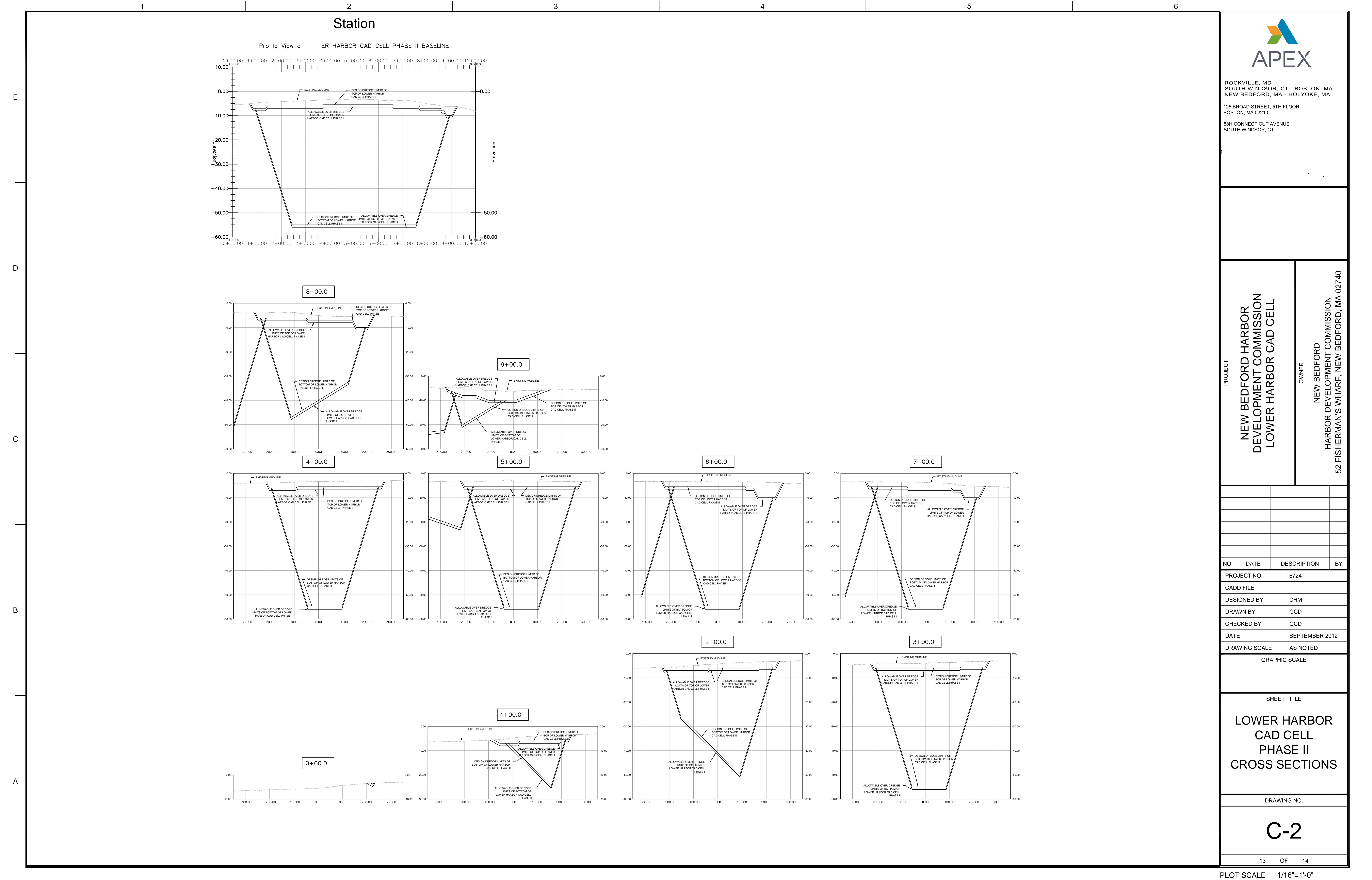

ROCKVILLE, MD
SOUTH WINDSOR, CT - BOSTON, MA -
NEW BEDFORD, MA - HOLYOKE, MA

125 BROAD STREET, 5TH FLOOR
BOSTON, MA 02210

58H CONNECTICUT AVENUE
SOUTH WINDSOR, CT

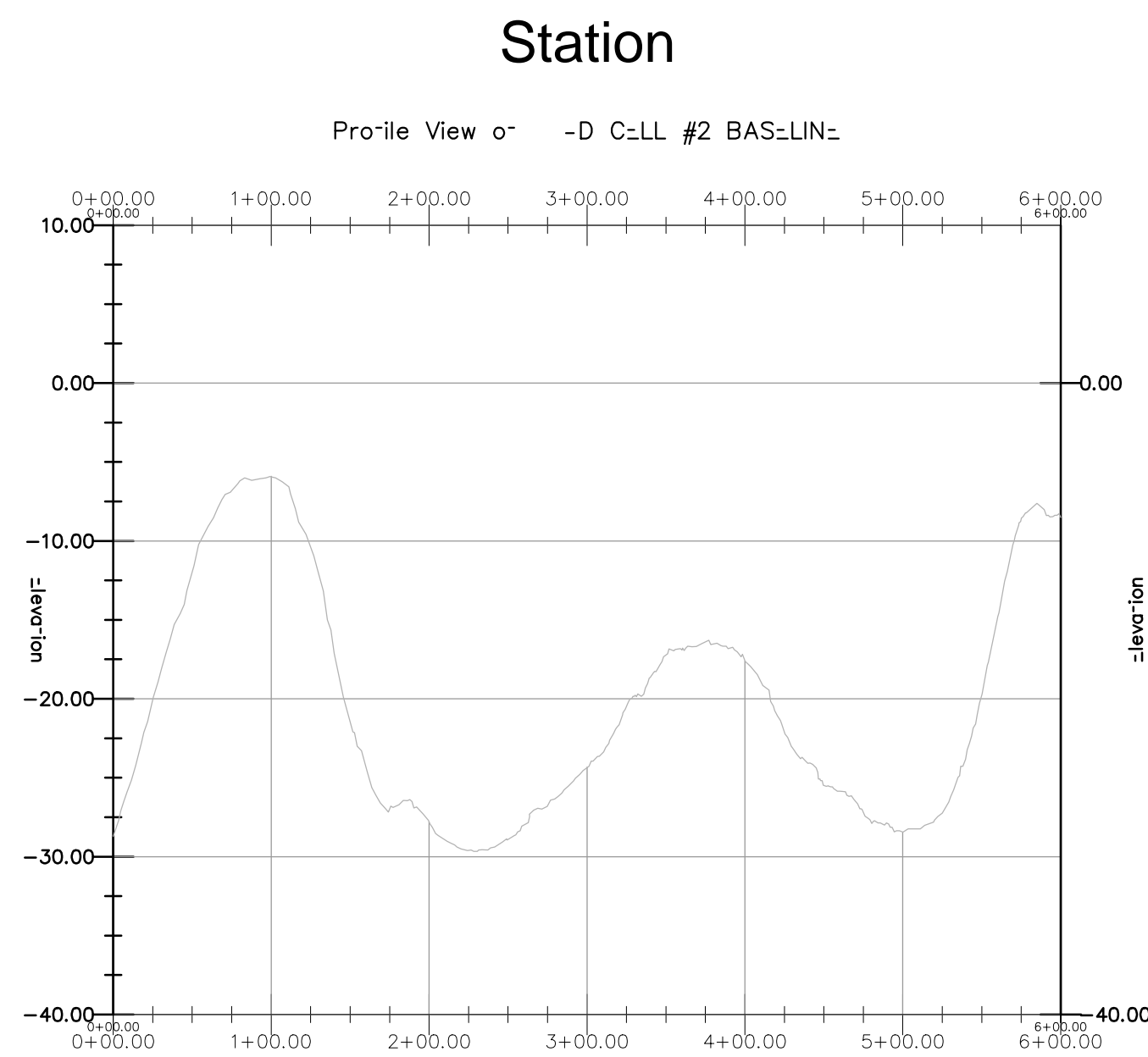
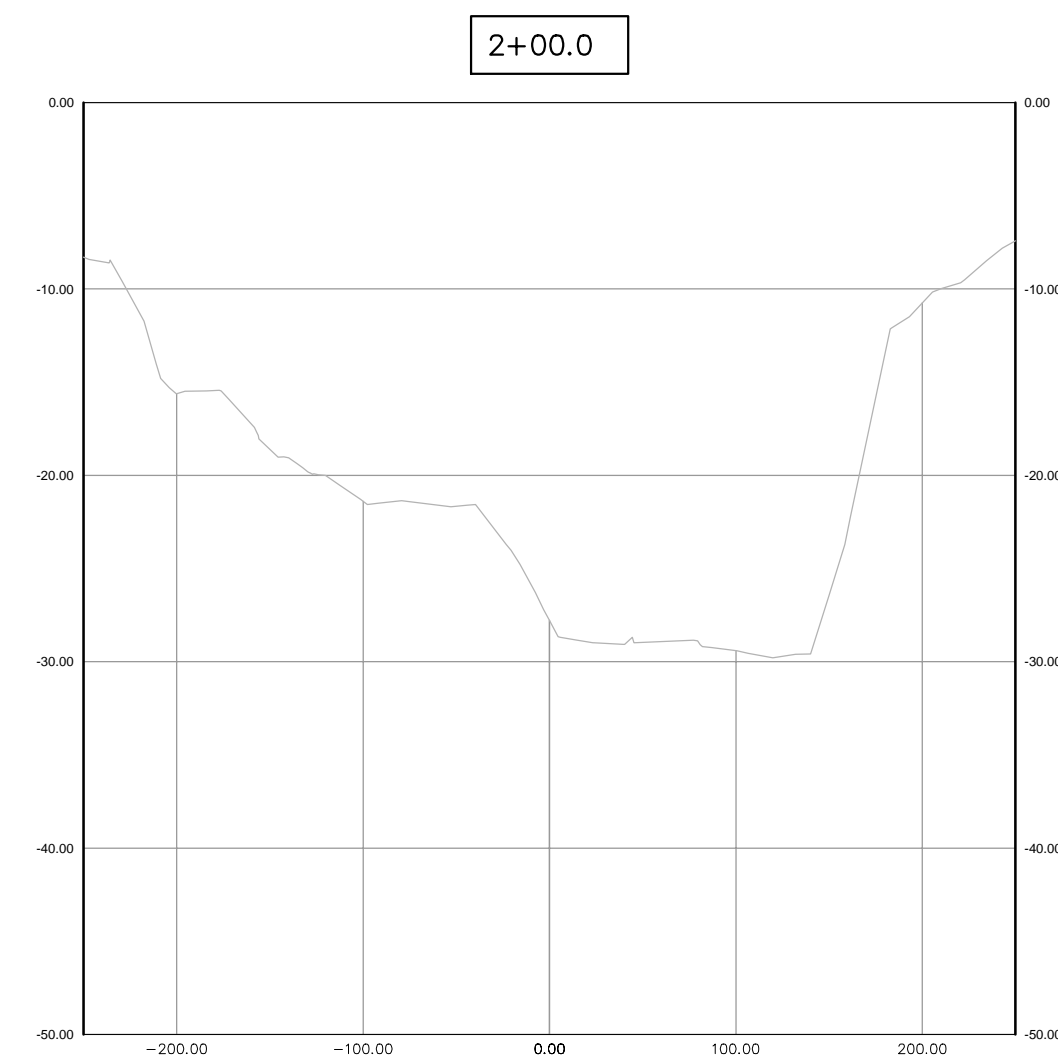

<p>PROJECT</p>	<p>NEW BEDFORD HARBOR DEVELOPMENT COMMISSION LOWER HARBOR CAD CELL</p>
<p>OWNER</p>	<p>NEW BEDFORD HARBOR DEVELOPMENT COMMISSION 52 FISHERMAN'S WHARF, NEW BEDFORD, MA 02740</p>

[illegible]

GRAPHIC SCALE

SHEET TITLE

CAD CELL #2
CROSS SECTIONS

DRAWING NO.

C-3